



# Wi-Fi Function User Manual



This description is applied to Air Conditioners with Wi-Fi function. Please read the manual carefully before using the product and keep it for future reference.

***Note: only for split air conditioner***



# Let's get start!

**Operation guideline.** Please take below simple guideline instruction as reference.

Operation Steps	Operation Items	New Account	Re-install APP (registered before)
Step 1	Download and Install APP	YES	YES
Step 2	Activate APP	YES	YES
Step 3	Registration Account	YES	NO
Step 4	Login	YES	YES
Step 5	Add Device to control	YES	Registered Device will remain.

*Note: If you registered the account and added device before, when you re-install the APP again and login, the added device will remain .*

## **FCC Caution (FCC ID: 2AJCLTWAC-TYWFS)**

This device complies with part 15 of the FCC Rules. Operation is subject to the following two conditions: (1) This device may not cause harmful interference, and (2) this device must accept any interference received, including interference that may cause undesired operation.

Any Changes or modifications not expressly approved by the party responsible for compliance could void the user's authority to operate the equipment.

Note: This equipment has been tested and found to comply with the limits for a Class B digital device, pursuant to part 15 of the FCC Rules. These limits are designed to provide reasonable protection against harmful interference in a residential installation. This equipment generates uses and can radiate radio frequency energy and, if not installed and used in accordance with the instructions, may cause harmful interference to radio communications. However, there is no guarantee that interference will not occur in a particular installation. If this equipment does cause harmful interference to radio or television reception, which can be determined by turning the equipment off and on, the user is encouraged to try to correct the interference by one or more of the following measures:

- Reorient or relocate the receiving antenna.
- Increase the separation between the equipment and receiver.
- Connect the equipment into an outlet on a circuit different from that to which the receiver is connected.
- Consult the dealer or an experienced radio/TV technician for help.

The distance between user and device should be no less than 20cm.

# CONTENTS

---

Wi-Fi Module specification and basic information.....	1
Download and Install the App.....	2
Activate APP.....	3
Registration.....	4
Login.....	6
Add device.....	8
Air conditioner control.....	10
Account management.....	29
Trouble Shooting.....	31

# Wi-Fi Module specification and basic information

## 1. Minimum specifications on a Smart phone:

Android 5.0 version or higher

IOS 9.0 version or higher

## 2. Basic parameters for Wi-Fi module

Parameters	Details
Network frequency	2.400 - 2.500GHz
Standards of WLAN	IEEE 802.11 b/g/n(channels 1-14)
Protocol stack support	IPv4/IPv6/TCP/UDP/HTTPS/TLS/MulticastDNS
Security support	WEP/WPA/WPA2/AES128
Network type support	STA/AP/STA+AP

## 3. Wi-Fi module location and appearance in indoor unit

Open the front panel, the Wi-Fi module is nearby the electric box cover or on the panel.

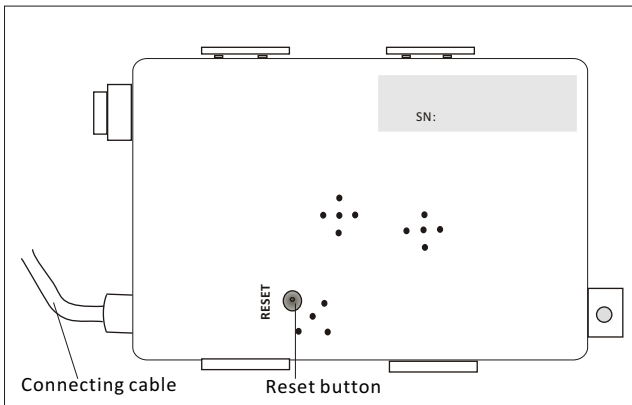

# Download and Install the App



**SmartLife-SmartHome**

## **For Android smart phone**

Method1: Please scan the QR code with a browser scanner, download and install the APP.

Method2: Open the Google "Play Store" on your smart phone and search "SmartLife-SmartHome", download and install the APP.



## **For IOS smartphone**

Method1: Please scan the QR code and follow the tips to get into "AppStore", download and install the APP.

Method2: Open the Apple "AppStore" on your smartphone and search "SmartLife-SmartHome", download and install the APP.



**Note:**

**Please enable the permissions of Storage/Location/Camera for this APP when installing. Otherwise it will have some problems when operating.**

# Activate APP

The first time the app is used, it will need activating.

1. Launch the APP "SmartLife-SmartHome" on your smart phone.



**SmartLife-SmartHome**

2. Method1: Tap button "Scan" and scan the right Activate QR code  
Method2: Tap "or Enter Activation Code" in bottom of the screen, then enter the activate code and tap "CONFIRM".

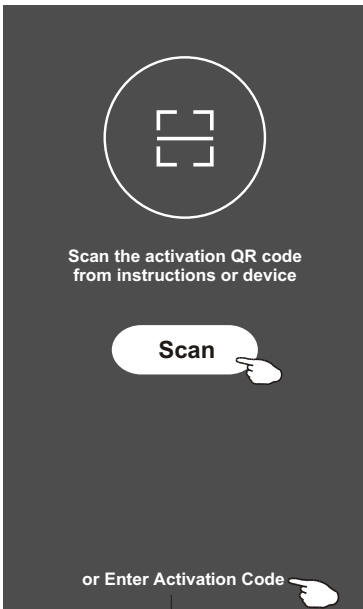

Activate QR code and activation code



*Note: Without the QR code or activation code, you can't activate the APP and using it, please keep them safe.*



# Registration

- 1.If you don't have any account please tap button "Register".
- 2.Read the Privacy Policy and tap "Agree".

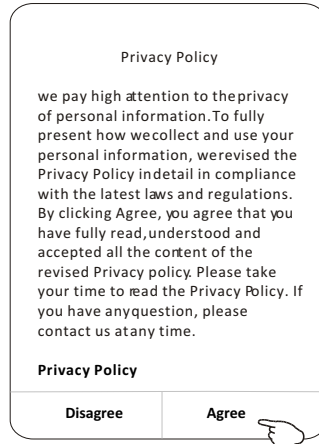
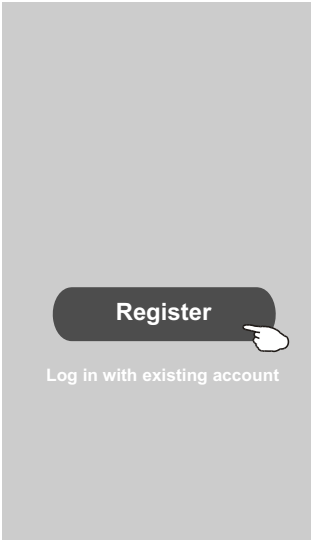

- 3.Tap ">" and choose the country.
- 4.Enter your e-mail address.
- 5.Tap the button "Obtain verification code".

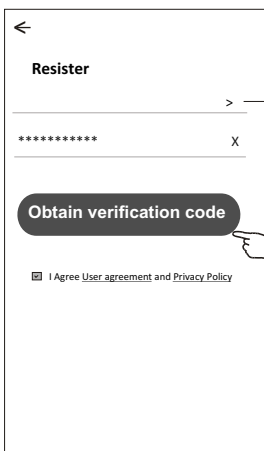

enter your e-mail address here

Search the country or slide the screen up/down to find and choose the Country.

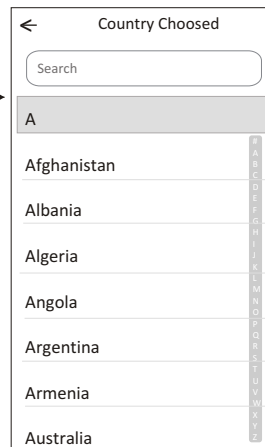



# Registration

6. Enter the verification code you received from e-mail.
7. Set the Password with 6-20 characters including characters and numbers.
8. Tap "Done".

Enter verification code

\* \* \* \* \*

Verification code is sent to your email:  
\*\*\*\*@\*\*\*\*.Resend(55s)

Set Password

\*\*\*\*\*

6-20 characters for password, including character, numbers

Done

# Login

1. Tap "Log in with existing account".
2. Enter your registered account and password.
3. Tap "Log in" button.

Register

Log in with Existing Account

Login

\*\*\*\*\*

\*\*\*\*\*

\*\*\*\*\*

Forgot password

Log in

enter your account here

enter the password

Login means that you agree with [User Agreement](#) and [Privacy Policy](#)

# Login

## The first time the APP is used, Create family is needed:

4. Tap "Create family".
5. Make name for the family.
6. Set the location.
7. Choose default rooms or add new rooms.
8. Tap "Done" and "Completed".

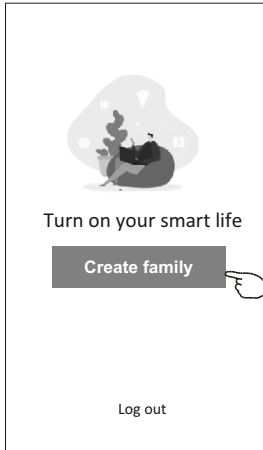

Family created successfully  
View family    Completed

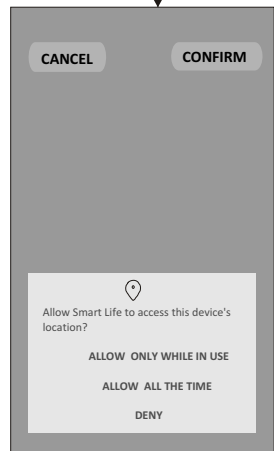
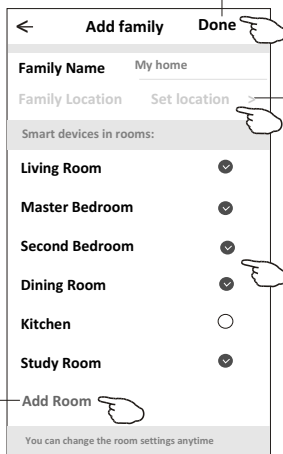

choose the recommended room or make a new room, then tap Done.

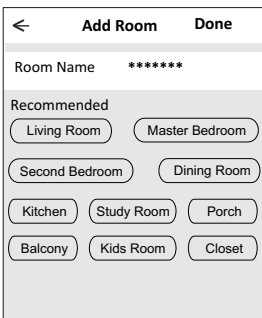

**Note:**  
The app can open the map on your phone and you can set the location where you are.

## Forgot the password

If you forgot the password or you want to reset the password, operate as below:

1. Tap "Forgot password".
2. Enter your account (e-mail address) and tap button "Obtain verification code".
3. Enter the verification code received by your e-mail.
4. Set the new password and tap button "Done".

←

**Login**

\*\*\*\*\* >

Email address

Password

**Log in**

Forgot password

Login means that you agree with User Agreement and Privacy Policy

←

**Forgot password**

\*\*\*\*\* >

\*\*\*\*\* X

**Obtain verification code**

←

**Enter verification code**

\* \* \* \* \*

Verification code is sent to your email:  
\*\*\*\*\*\_Resend(55s)

←

**Set Password**

\* \* \* \* \*

6-20 characters for password, including character, numbers

**Done**

# Add device

There are 2 methods to add the device.

## 1-CF mode

- 1.Power on the indoor unit, no need to launch the air conditioner.
- 2.Click "+" in the upper right corner of the "Home" screen or tap "Add device" on the room which has no device.
- 3.Tap the "Split Air Conditioner" logo.
- 4.Input the password of the Wi-Fi which the same as your smart phone connected, then tap "Next".
- 5.Follow the the comments on the next screen to reset the Wi-Fi module then check "Confirm the device is reset" and tap"Next".
- 6.You can see the percent rate of connecting process, at the same time "PP", "SA", "AP" shining in turn on the indoor display. "PP" means "Searching the router" "SA" means "connected to the router" "AP" means "connected to the server"

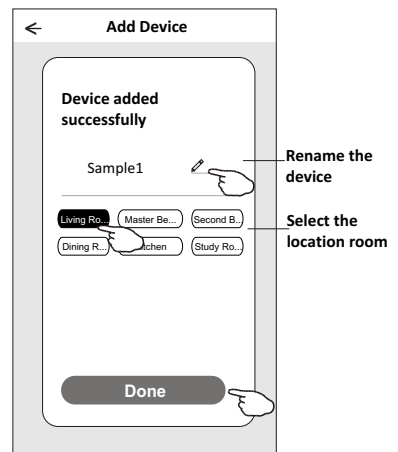
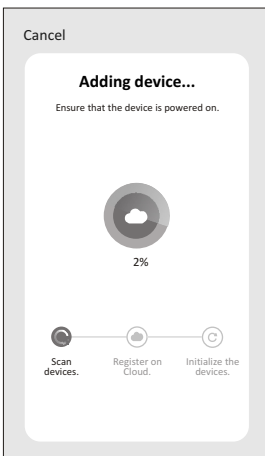
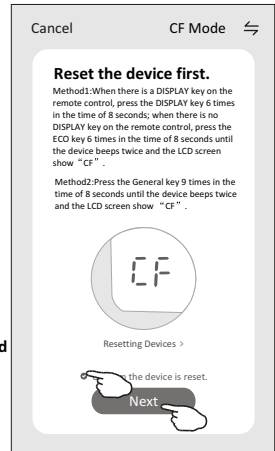
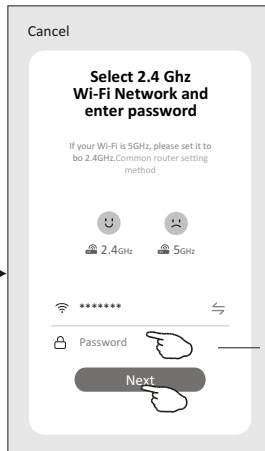
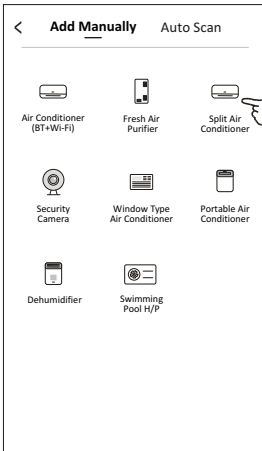
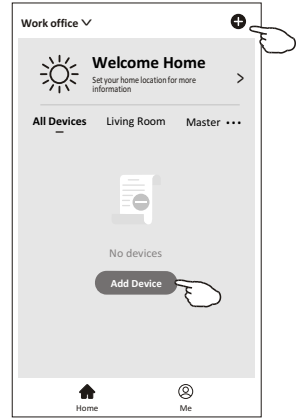

# Add device

There are 2 methods to add the device.

## 2-AP mode

1. Power on the indoor unit, no need to launch the air conditioner.
2. Click "+" in the upper right corner of the "Home" screen or tap "Add device" on the room which has no device.
3. Tap the "Split Air Conditioner" logo.
4. Input the password of the Wi-Fi which the same as your smart phone connected, then tap "Next".
5. Tap ⇌ in the upper right corner and choose "AP Mode" then follow the comments on the screen to reset the Wi-Fi module then check "Confirm the device is reset" and tap "Next".
6. Read the instruction carefully and tap "Connect now".
7. In the network setting screen, select "SmartLife-\*\*\*\*", and tap "<".
8. You can see the percent rate of connecting process, at the same time "PP", "SA", "AP" shining in turn on the indoor display.
  - "PP" means "Searching the router"
  - "SA" means "connected to the router"
  - "AP" means "connected to the server"

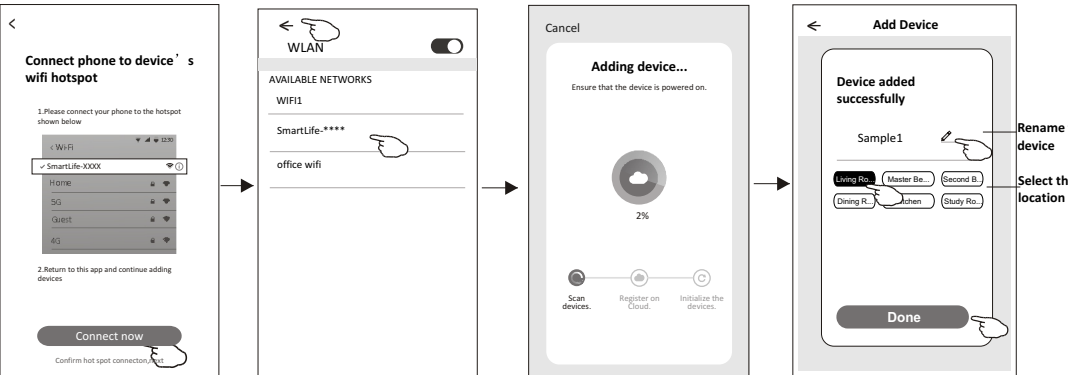
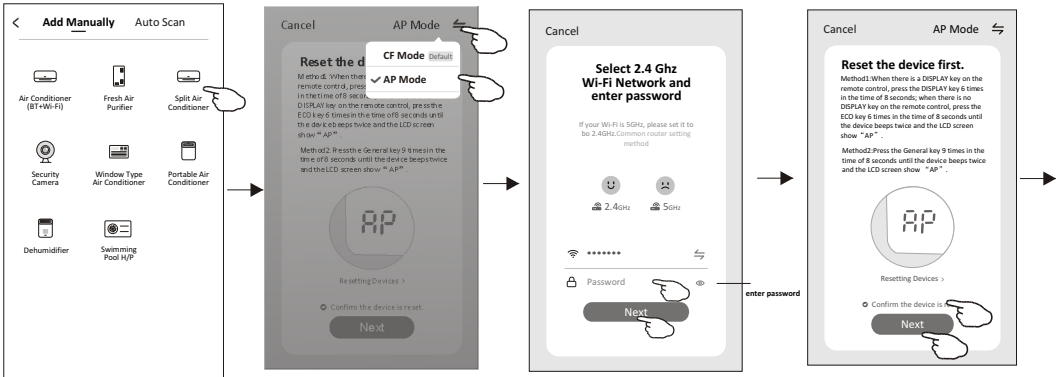
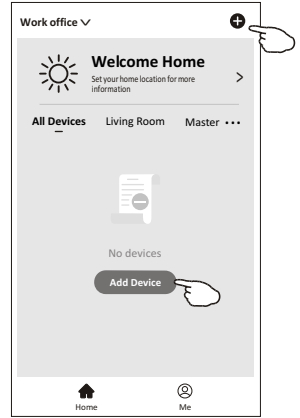

# Air conditioner control

The device control screen will pop up automatically after adding the device.

The device control screen will pop up manually by tapping the device name on the home screen.

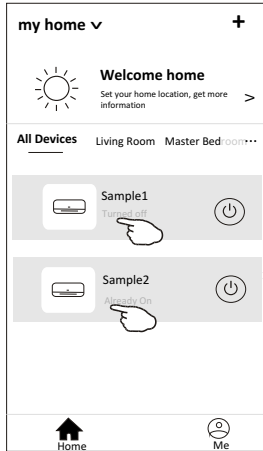

Note:

There are two different control forms base on different software or Wi-Fi module firmware. Please read the manual carefully base on the real control interface.

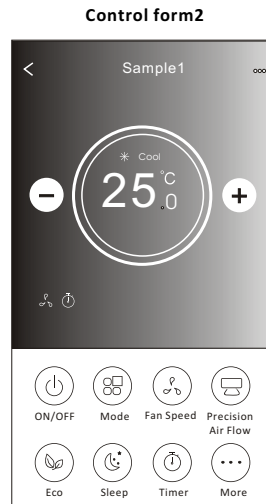
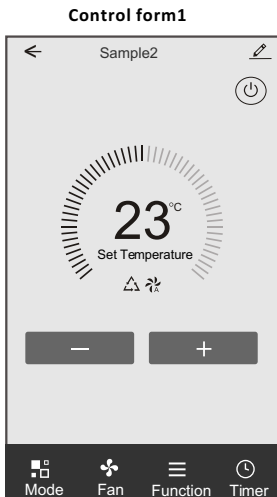

# Air conditioner control

## Control form1

### The main control interface

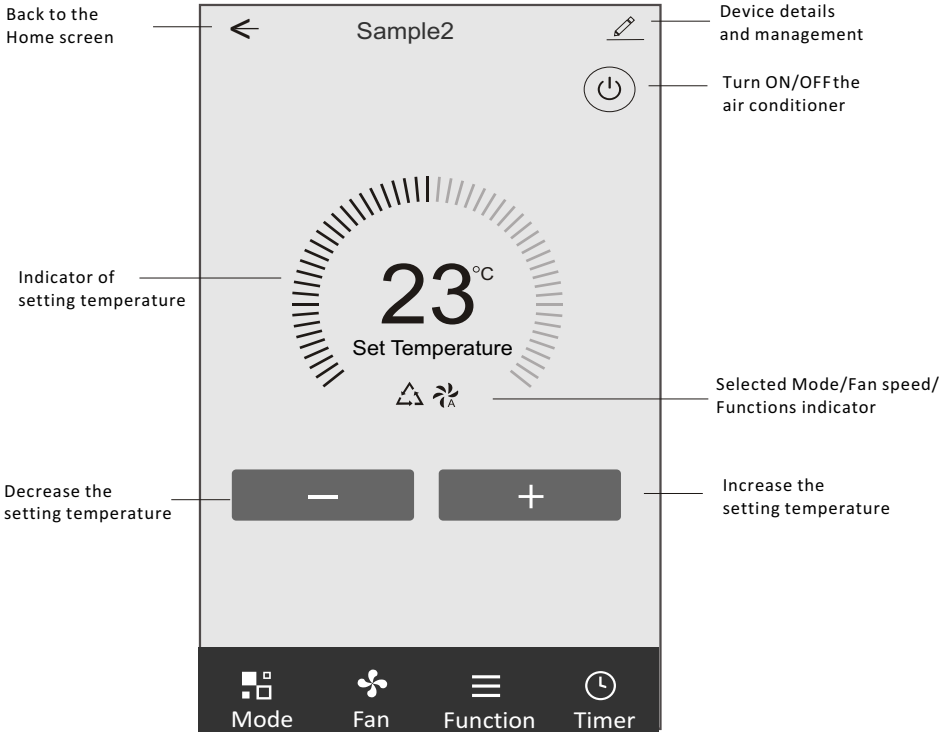

# Air conditioner control

## Control form1-Mode setting

1. Tap Mode to pop up the Mode screen.
2. Select one of the mode Feel/Cool/Heat/Dry/Fan.
3. Tap anywhere around the setting temperature to cancel the Mode setting.

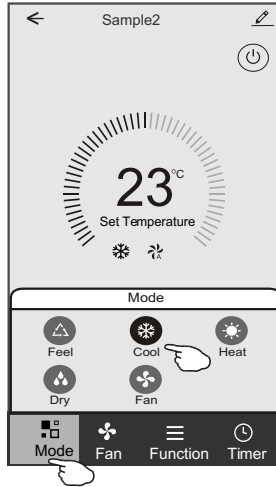

## Control form1-Select fan speed

1. Tap Fan to pop up the Fan screen.
2. Select one of the fan speed High/med/Low/Auto.
3. Tap anywhere around the setting temperature to cancel the selection.

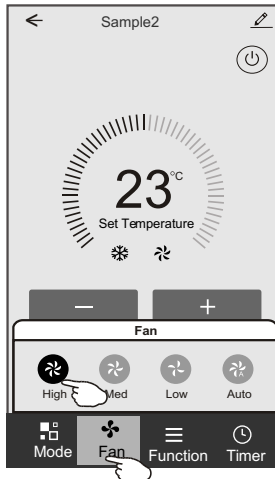



# Air conditioner control

## Control form1-Function setting

1. Tap Function to pop up the Function screen.
2. Select one of the functions Sleep/Turbo/ECO.
3. Select UP-DOWN/LEFT-RIGHT for auto swing with direction of UP-DOWN/LEFT-RIGHT.
4. Tap anywhere around the setting temperature to cancel the Function setting.



## Control form1-Timer adding

1. Tap Timer to pop up the Add Timer screen.
2. Tap Add Timer.

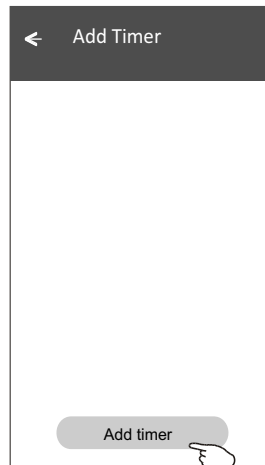
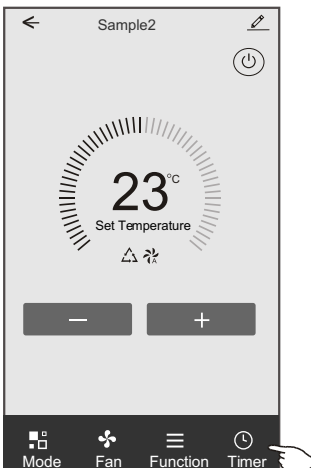

# Air conditioner control

## Control form1-Timer adding

3. Select the time, select the repeat days and Timer on/off.
4. Select the Mode/Fan speed/Function and select the setting temperature for Timer on.
5. Tap Save to add the timer.

### Timer on

### Timer off

Labels for the 'Timer on' screen:

- Timer cancel: Cancel
- Hour setting: 15
- Minute setting: 10
- Mode setting: Mode
- Fan Speed setting: Fan
- Temperature setting: Set Temperature

Labels for the 'Timer off' screen:

- Timer submit: Save
- Minute setting: 28
- Weekly setting: Mon, Tues, Wed, Thur, Fri, Sat, Sun
- Timer ON/OFF setting: Timer ON/OFF setting

## Control form1-Timer Management

1. Tap the bar of timer to edit the Timer like the Timer adding process.
2. Click the switch to enable or disable the Timer.
3. Holdind the bar of Timer about 3seconds and pop up the Remove Timer screen, tap CONFIRM and remove the Timer.

**Remove Timer**

Remove the timer?

CANCEL CONFIRM

# Air conditioner control

## Control form2

### The main control interface

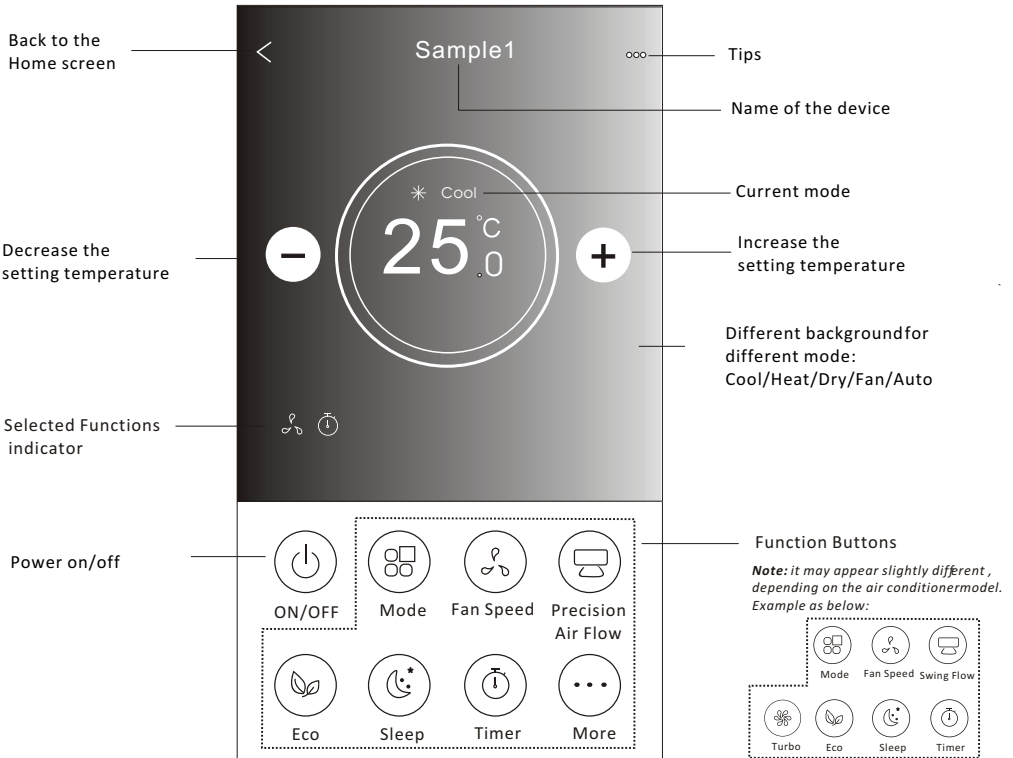

# Air conditioner control

## Control form2-Mode setting

1. Tap the Mode button.
2. There are 5 modes on the Mode screen, tap one button to set the Air conditioner working mode.
3. Tap the X button to back the main control screen.
4. The mode and background will change on the screen.

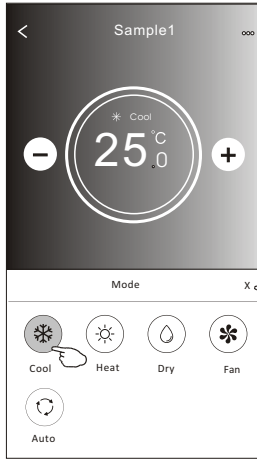
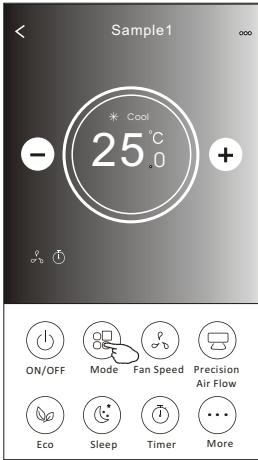

**Note:** please read the details of each mode in the user manual to control more comfortable.

## Control form2-Fan speed selection

1. Tap the Fan speed button.
2. Choose your desired fan speed and tap it.
3. Tap the X button to back the main control screen.
4. The selected fan speed indicator will appear on the screen.

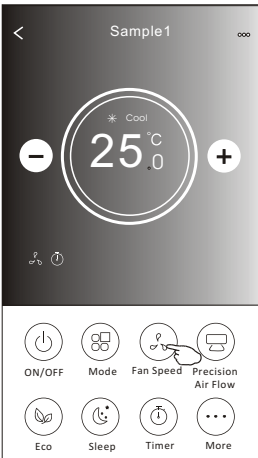

Mode	Fan Speed
Cool	All speeds
Fan	All speeds
Dry	
Heat	All speeds
Auto	All speeds

**Note:**  
Fan Speed can't be adjusted on Dry mode .

**Note:** Fan Speed screen may appear slightly different, depending on the air conditioner model.  
Example as below:

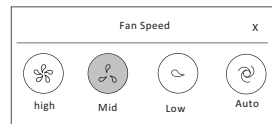

# Air conditioner control

## Control form2-Air Flow control

1. Tap the Precision Air Flow button or Swing Flow button.
2. Choose your desired air flow and tap it.
3. Tap the X button to back to the main control screen.
4. The selected air flow indicator will appear on the screen.

**Note:** For some models without auto Left-Right wind, If you active it, you will hear a beep, but no any actions.

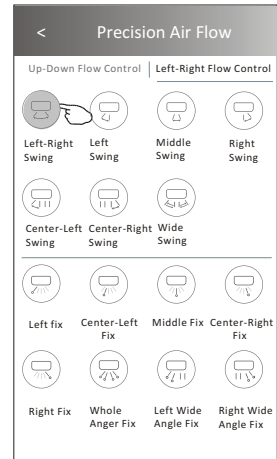
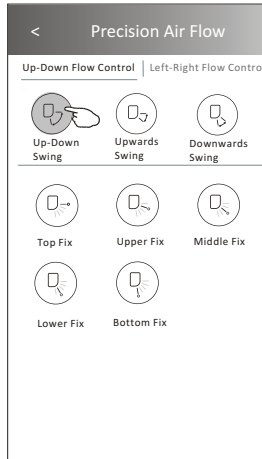
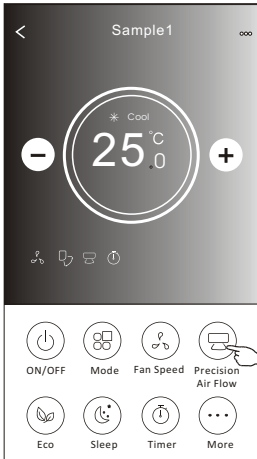

**Note:** The Main controlscreen and Air Flowscreen may appear slightly different, depending on the air conditioner model. Example as below:

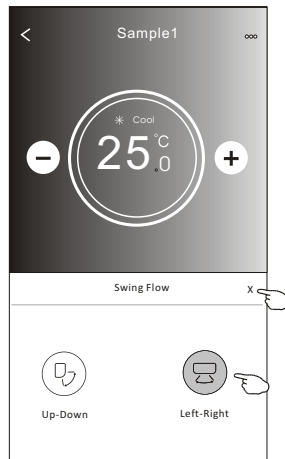
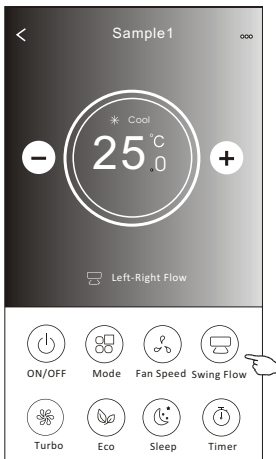

# Air conditioner control

## Control form2-ECO function

1. For Eco function, just tap the button to activate the function, the button will be lighting and the indicator will appear on the screen.
2. Tap again to disable the function.
3. Temperature controlled for some air conditioner model:
  - In Cooling mode, the new setting temperature will  $\geq 26^{\circ}\text{C}$ .
  - In heating mode, the new setting temperature will  $\leq 25^{\circ}\text{C}$ .

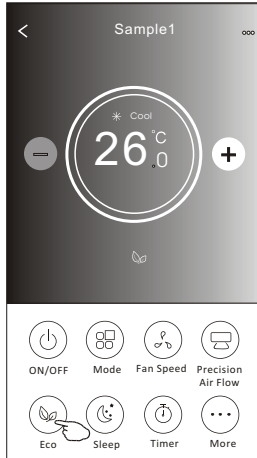
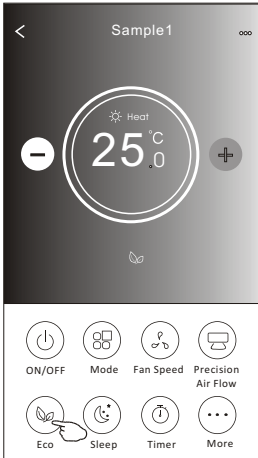

Mode	ECO enabled
Cool	Yes
Fan	
Dry	
Heat	Yes
Auto	

ECO is disabled on Fan/ Dry/Auto mode .

**Note:** The Main controlscreen and ECOcontrol method may appear slightly different, depending on the air conditioner model. Example as below:

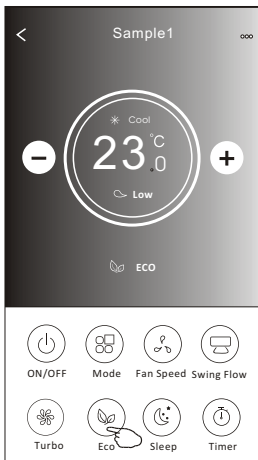

**Note:**  
ECO is disabled on Turbo/Sleep mode too for some air conditioner model.

# Air conditioner control

## Control form2-Sleep function

1. Tap the Sleep button.
2. Choose your desired sleep mode and tap it.
3. Tap the X button to back to the main control screen.
4. The selected sleep mode indicator will appear on the screen.

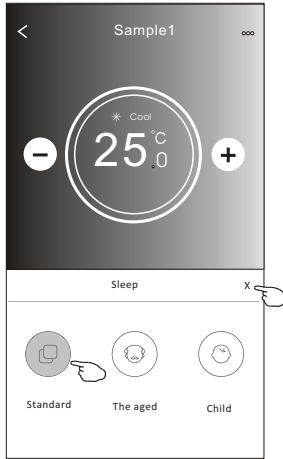
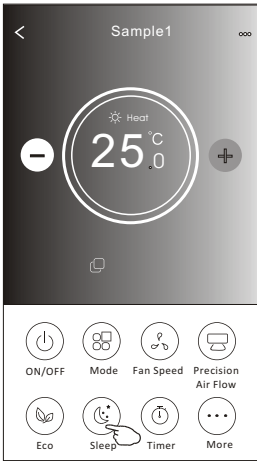

Mode	Sleep enabled
Cool	Yes
Fan	
Dry	
Heat	Yes
Auto	

Sleep is disabled on Fan/ Dry/Auto mode .

### Note:

The Main control screen may appear slightly different ,depending on the air conditioner model.  
Example as below:

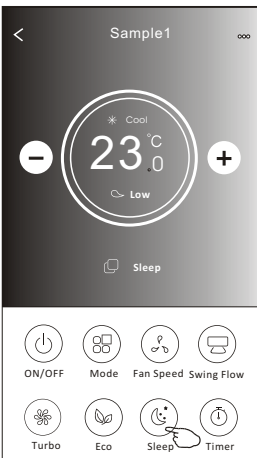

### Note:

Sleep is disabled on Turbo/Sleep mode too  
for some air conditioner model..

# Air conditioner control

## Control form2-Timer(on) setting

1. Tap the Timer button.
2. Tap + in the upper right corner of the Timer main screen.
3. Choose the Time/Repeat/Switch OFF then tap Save.
4. The timer(off) will appear on the Timer main screen.

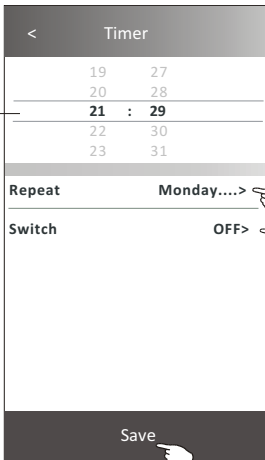
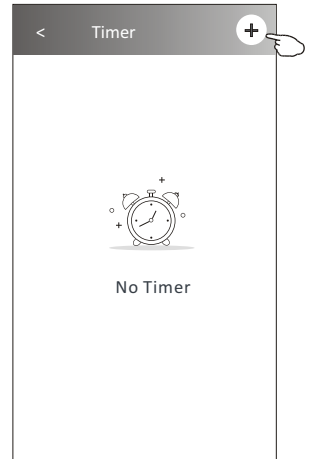
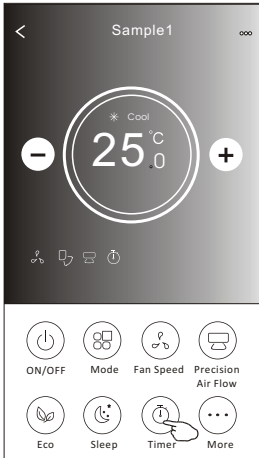

Slide up or down to select time

Tap repeat> then tap your desired repeat days or Once, then tap Confirm your selection.

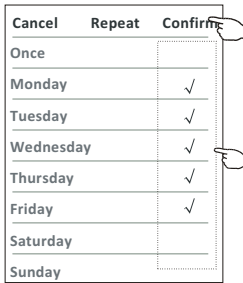

Tap Switch> then slide the screen to choose ON and Confirm.

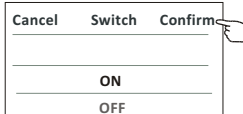



# Air conditioner control

## Control form2-Timer(off) setting

1. Tap the Timer button.
2. Tap + in the upper right corner of the Timer main screen.
3. Set the Time/Repeat Date/Switch(ON)/Temperature/Mode/  
Fan speed/Air Flow as your desired and then tap Save.
4. The timer will appear on the Timer main screen.

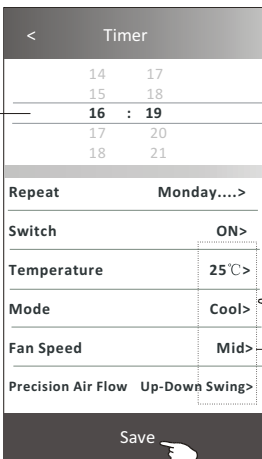
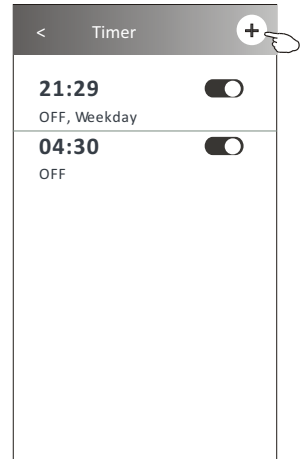
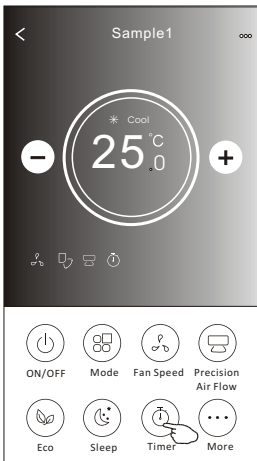

Slide up or down to select time

Tap repeat> then tap your desired repeat days or Once, then tap Confirm your selection.

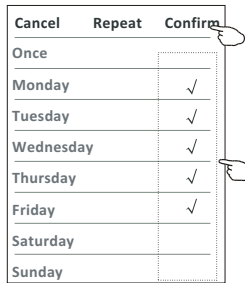

Tap Switch> then slide the screen to choose ON and Confirm.

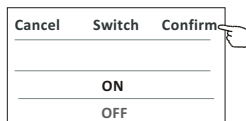

Tap Temperature/Mode/Fan Speed/ Air Flow > one by one then set as your desired as mentioned on the previous chapter and tap Confirm the setting.

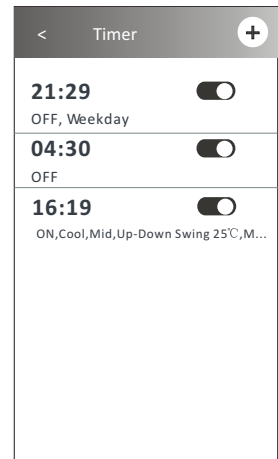

# Air conditioner control

## Control form2-Timer management

### 1.Change the Timer setting:

Tap anywhere of the timer list bar except the switch bar to get into the Timer setting screen, change the setting and then tap save.

### 2.Enable or Disable the Timer:

Tap the left of the switch to disable the Timer.  
Tap the right of the switch to enable the Timer.

### 3.Delete the Timer:

Slide the list bar of the Timer from right to left until Delete button appear, then tap delete.

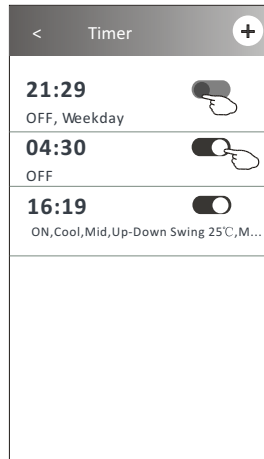
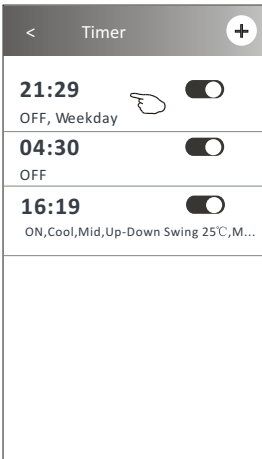

Slid left to disable the Timer.

Slid right to enable the Timer.

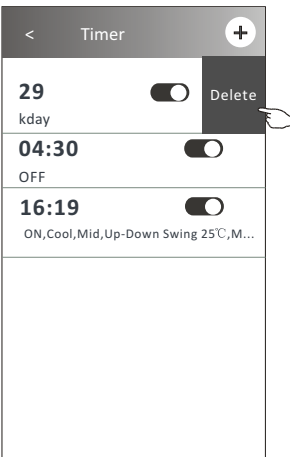

# Air conditioner control

## Control form2-More functions

1. Tap the More button to operate additional functions if it appears on the screen.

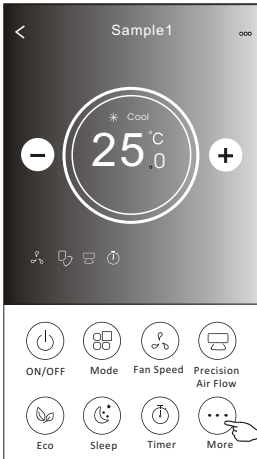

**Note:**  
Some air conditioner model don't have the more button.

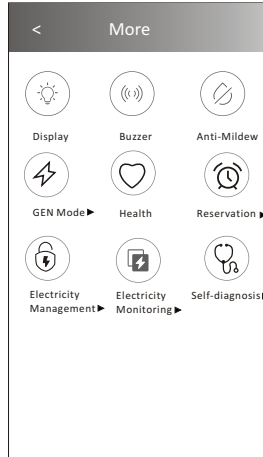

**Note:** The appearance maybe different , some icons will be hidden if the air conditional do no have this function or do not enable on the current mode.

2. Tap the "Display" to switch on/off the indoor LED display.



Display

3. Tap the "Buzzer" to switch on/off the buzzing when operating through Wi-Fi APP.



Buzzer

4. Tap the "Anti-Mildew" button to activate the Anti-Mildew function, if it is available on the screen.  
After AC turning off , it will start drying , reduce residual moisture and prevent mould, after function finish, it will automatically turn off.



Anti-Mildew

5. Tap the "Health" button to switch on/off the healthy function, if it is available on the screen.  
It activate the antibacterial ioniser function.This function only for models with the ioniser generator.



Health

# Air conditioner control

## Control form2-More functions

6. Tap the "GEN Mode" button, if it is available on the screen.  
In this Mode, you can choose one of the three levels of current.  
The air conditioner will maintain proper current to save energy.

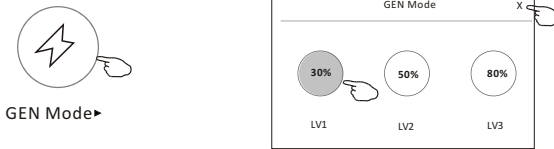

7. Tap the "Electricity Monitoring" button if it is available on the screen.  
In this function, you can monitor the air conditioner electricity consumption.

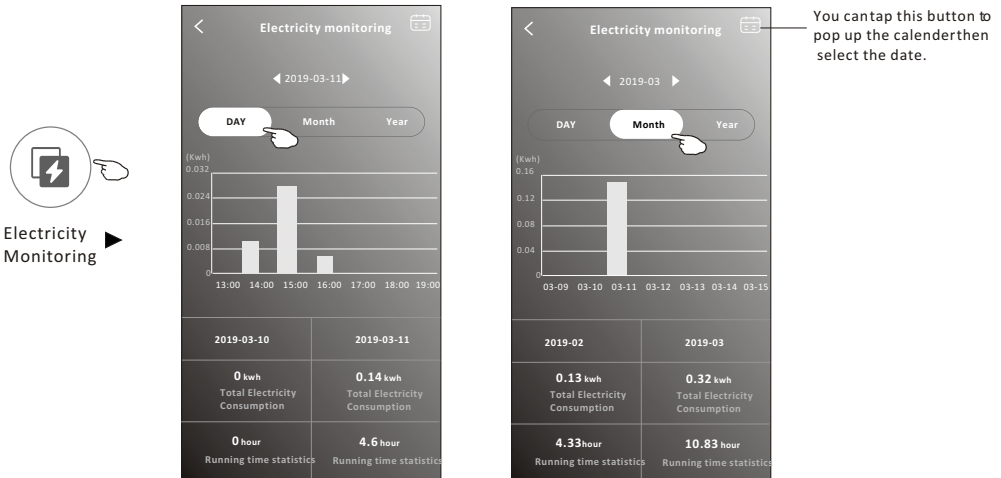

8. Tap the "Self-Cleaning" button, if it is available on the screen.  
Check the details of the Self-Cleaning function on User Manual.



Self-Cleaning

9. Tap the "8°C Heat" button, if it is available on the screen.  
This function help keep the room temperature over 8°C.  
Check the details of the 8°C Heat function on User Manual.



8°C Heat

# Air conditioner control

## Control form2-More functions

10. Tap the "Reservation" button , if it is available on the screen.

You can set the time, repeat day, temperature, mode, fan speed, air flow as you desired and then tap Save to activate the function.

The air conditioner will automatically reach your settings at the appointment time.



Reservation ▶

Reservation	
14	17
15	18
<b>16</b>	<b>: 19</b>
17	20
18	21

Repeat setting Monday... >

Temperature 25°C >

Mode Cool >

Fan Speed Mid >

Precision Air Flow Up-Down Swing >

Save

Reservation +

**16:19:00**

ON, Cool, Mid, Up-Down Swing 25°C, M...

After the reservation is setup, the air conditioner will automatically reach your setrequirement at your appointment time.

11. Tap the "Self-diagnosis" button, if it is available on the screen.

The air conditioner will automatically diagnosis itself and indicate the Error code and the problem instructions if possible.



Self-diagnosis ▶

Self-diagnosis

48%  
Checking

Cancel

Self-diagnosis

100%  
Complete

Error code: E0  
Indoor and outdoor  
communication failure

OK

### Control form2-More functions

12. Tap the "Photosensitive" button if it is available on the screen.  
This function allow the air conditioner to turn on/off the display automatically according to the light intensity.



Photosensitive

13. Tap the "Soft wind" button if it is available on the screen.  
In this function, the air conditioner will blow soft airflow through the micro holes on the deflector.



Soft Wind

# Air conditioner control

## Device details and management

Tap  on control form1 or tap ... on control form2 , get into the device details screen. Here you can get some useful information and sharing the device to other accounts. Check the following pictures and instructions carefully.

Control form1

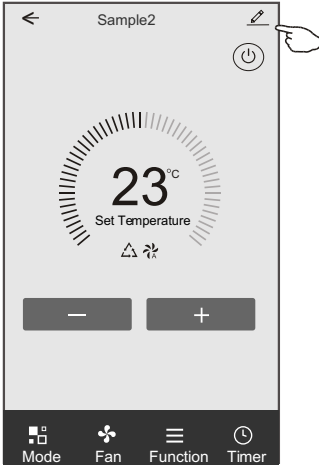

Control form2

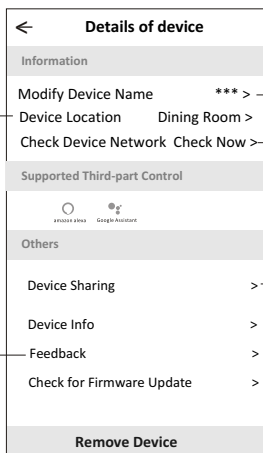
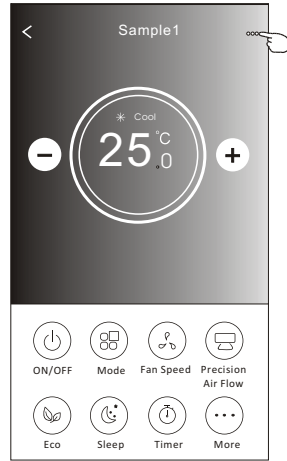

Tap to change the device location to another room

Feed back the problems or some suggestions to the APP administrator.

Tap to check the network status

Tap to check the network status

Tap to got the instruction for connecting the amazon alexa or Google Assistant voice controller

Tap to sharing the device to other account

Tap to check the Virtual ID/Wi-Fi name/IP address MAC address/Time Zone/Wi-Fi single strength

Check and update the firmware

Tap to remove the device and the device will be reset automatically once be deleted.

# Air conditioner control

## Device details and management

### How to share the devices to other accounts?

1. Tap "Device Sharing" and pop up Device Sharing screen.
2. Tap "Add Sharing".
3. Select the region and enter the account which you want to sharing.
4. Tap "Completed", the account will appear on your sharing list.
5. The received sharing members should hold pressing the home screen and slide down to refresh the device list, the device will appear on the device list.

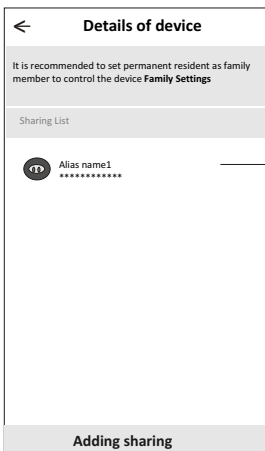
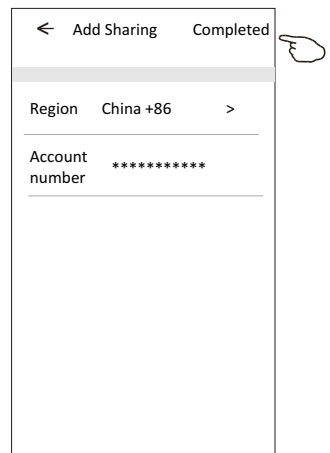
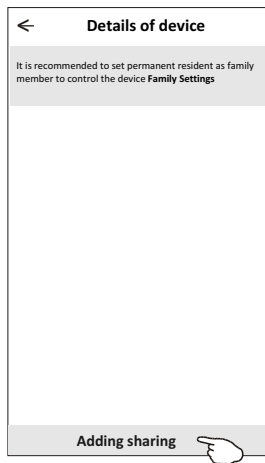
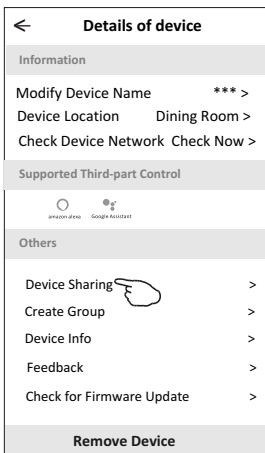

Hold the bar about 3s then you can delete the sharing account.

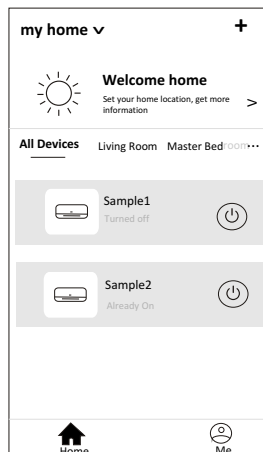

Hold on and slide down to refresh the device list



# Account management

## Account Profile setting

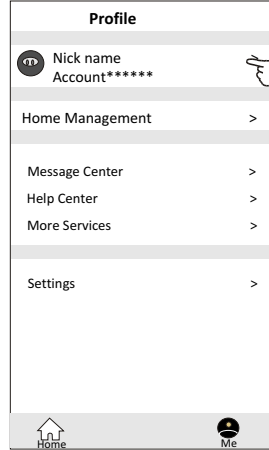
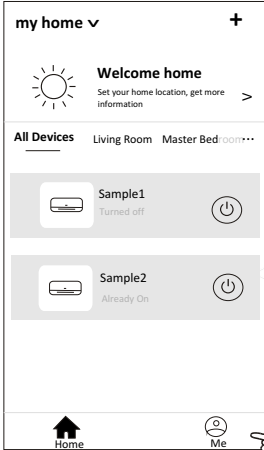

Change the nick name of your account

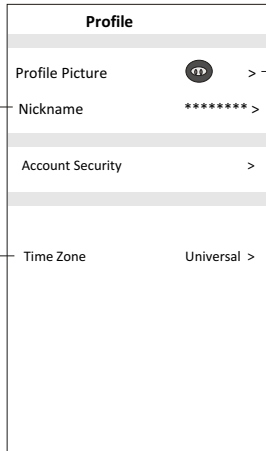
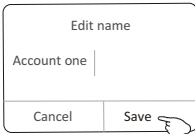

Select a picture for the account from local album

Select the time zone

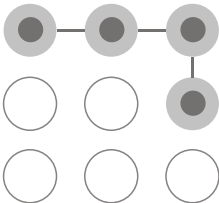

Set a pattern password for launching the APP

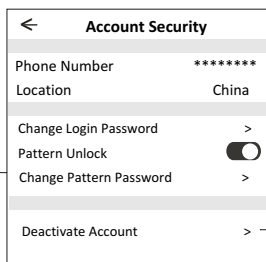

Change the password like reset password on page7

Tap the switch to enable or disable the Pattern password

Please carefully to deactivate the account for all data will be deleted.

# Account management

## Home(Family) management

1. Tap the name of home at the left upper corner of the Home Screen and select the Home Management.  
Or tap Me and tap Home Management.
2. Tap one of the families in the family list and get into Family Settings screen.

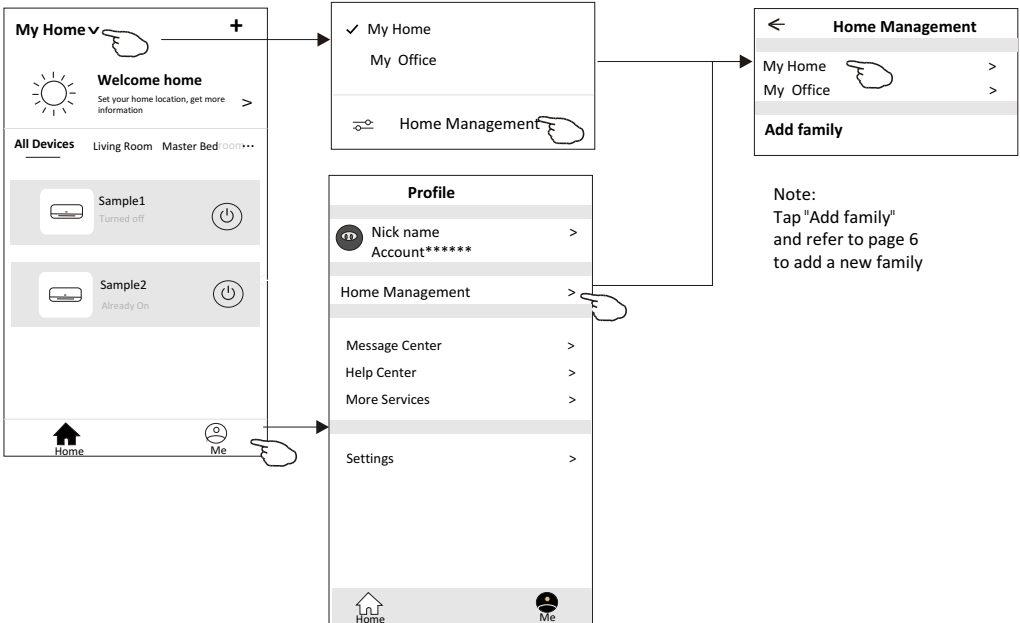

3. Set the family as the following indicators.

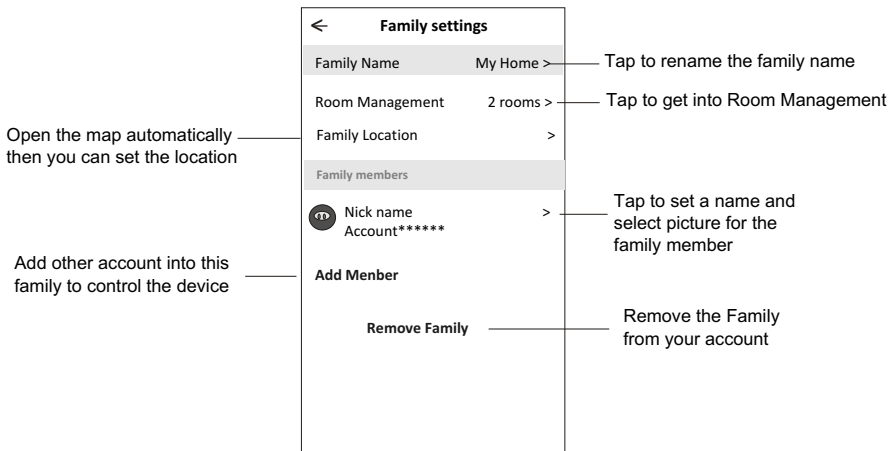

# Notice

1. For technical update, there is maybe deviation of the actual items from what is on the manual. We express our apologies. Please refer to your actual product and APP.
2. Smart air conditioner APP can be altered without notice for quality improvement and also be deleted depending on the circumstances of manufacturing firms .
3. In case Wi-Fi signal strength is weakened, smart App may be disconnected. So make sure the indoor unit near to wireless router.
4. DHCP server function should be activated for wireless router.
5. The internet connection may fail because of a firewall problem. In this case, contact your internet service provider.
6. For smart phone system security and network setting, make sure Smart air conditioner APP is trusted.

# Trouble Shooting

Description	Analysis of cause
<p><b>Air conditioner can't be configured successfully</b></p>	<p>1. Check the mobile connected WLAN router SSID and password is correct;                  2. Check whether there are additional settings of WLAN router as shown below.                  1) Firewall by router itself or by PC                  2) MAC address filtering                  3) Hidden SSID                  4)DHCP server                  Reboot WLAN router, mobile device and air conditioner (WLAN module) and connect air conditioner by CF mode again. Before rebooting, check nobody has already connected to same air conditioner.</p>
<p><b>Mobile can't control air conditioner</b></p>	<p>1. When air conditioner (WLAN module) is rebooted and app displays Device remove, ignoring this confirmation will lead to mobile device losing control permission of the air conditioner. You will need to connect the air conditioner by CF mode again.                  2. In case of power failure, mobile device will lose control permission of air conditioner for 3 minutes after power failure. (Notification will now show up on the mobile device.)                  If you cannot control the app (air conditioner) even after power restored, you will need to connect the air conditioner by CF mode again.</p>
<p><b>Mobile can't find air conditioner</b></p>	<p>1. Smart Life App display Air conditioner Device offline. Please check the following conditions.                  1)The air conditioner has been reconfigured.                  2)Air conditioner out of power.                  3)Router out of power.                  4)Air conditioner can't connect to router.                  5)Air conditioner can't connect to network through the router.                  6)Mobile device can't connect to network.                  2. After adding the device, it disappears in device list .                  Hold and slide down to refresh the device list. If it has no change, shut down the app and start again.</p>



# Korisnički priručnik za Wi-Fi funkciju klima uređaja



Ovaj opis se odnosi na klima uređaje s Wi-Fi funkcijom. Molimo pažljivo pročitajte priručnik prije upotrebe proizvoda i sačuvajte ga za buduću upotrebu.

# Krenimo redom!

**Smjernice za rad.** Uzmite ispod jednostavne upute za smjernice kao referencu.

Operativni koraci	Operativne stavke	Novi račun	Re-instalirajte aplikaciju (registrirajte se prvo)
Korak 1	Preuzmite i instalirajte aplikaciju	DA	DA
Korak 2	Aktivirajte aplikaciju	DA	DA
Korak 3	Registrirajte račun	DA	NE
Korak 4	Prijavite se	DA	DA
Korak 5	Dodajte uređaj za kontrolu	DA	Registrirani uređaj će ostati.

*Napomena: Ukoliko ste ranije registrirali račun i dodali uređaj, kada ponovo instalirate aplikaciju i prijavite se, dodani uređaj će ostati.*

## FCC Oprez (FCC ID: 2AJCLTWAC-TYWFS)

Ovaj je uređaj sukladan s dijelom 15 FCC pravila. Rad je podložan sljedećim dvama uvjetima:

- (1) Ovaj uređaj ne smije uzrokovati štetne smetnje,
- (2) ovaj uređaj mora prihvatiti sve primljene smetnje, uključujući smetnje koje mogu prouzročiti neželjeni rad.

Sve izmjene ili preinake koje strana koja je odgovorna za usklađenost nije izričito odobrila mogu poništiti ovlaštenje korisnika za upravljanje opremom.

Napomena: Ova je oprema testirana i utvrđeno je da udovoljava ograničenjima za digitalni uređaj klase B, u skladu s dijelom 15 FCC pravila. Ova su ograničenja osmišljena kako bi pružila razumnu zaštitu od štetnih smetnji u rezidencijalnoj upotrebi. Ova oprema generira koristi i može zračiti radiofrekvencijsku energiju, ako se ne ugradi i ne koristi u skladu s uputama, može uzrokovati smetnje u radio komunikacijama. Međutim, ne postoji jamstvo da se smetnje neće pojaviti. Ukoliko se pojave smetnje na radio ili televizijskom uređaju, što se može utvrditi isključivanjem i uključivanjem uređaja, korisnik može pokušati ispraviti smetnje jednom ili više sljedećih mjera:

- Preusmjeriti ili premjestiti prijemnu antenu.
  - Povećati razmak između opreme i prijemnika.
  - Spojiti opremu u utičnicu koja je drugom strujnom krugu od onog na koji je povezan prijemnik.
  - Za pomoć potražite dobavljača ili iskusnog radio / TV tehničara.
- Udaljenost između korisnika i uređaja ne smije biti manja od 20 cm.

# SADRŽAJ

---

Specifikacija Wi Fi modula i osnovne informacije .....	1
Preuzmite I instalirajte aplikaciju .....	2
Aktivirajte aplikaciju .....	3
Registracija .....	4
Prijavite se .....	6
Dodajte uređaj .....	8
Upravljanje klima uređajem .....	10
Upravljanje računom .....	29
Rješavanje problema .....	31

# Specifikacija Wi-Fi modula I osnovne informacije

## 1. Minimalne specifikacije pametnog telefona:

Verzija Android 5.0 ili novija,  
verzija IOS 9.0 ili novija

## 2. Osnovni parametri za Wi Fi modul

Parametri	Details
Mrežna frekvencija	2.400 - 2.500GHz
WLAN odgovara	IEEE 802.11 b/g/n(kanali 1-14) standardu
Podržava protokol	IPv4/IPv6/TCP/UDP/HTTPS/TLS/MulticastDNS
Sigurnosna podrška	WEP/WPA/WPA2/AES128
Podržava mreže	STA/AP/STA+AP

## 3. Lokacija I izgled Wi-Fi modula u unutarnjem uređaju

Otvorite prednju ploču, Wi-Fi modul je u blizini poklopca električne kutije ili na ploči.

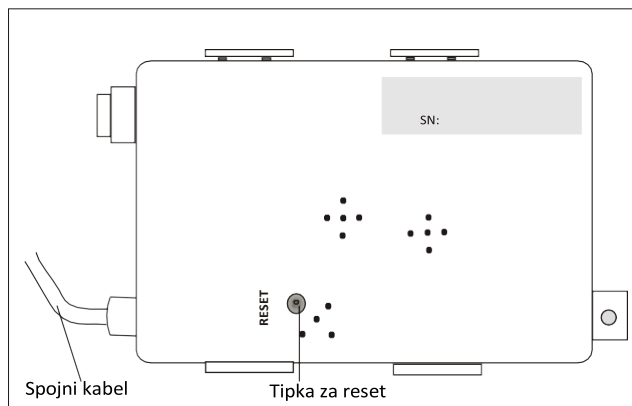



# Preuzmite i instalirajte aplikaciju



**SmartLife-SmartHome**

## **Za android pametni telefon**

Metoda 1: Skenirajte QR kod te preuzmite i instalirajte aplikaciju.

Metoda 2: Otvorite na svojem pametnom telefonu Google "Play Store" i potražite aplikaciju "SmartLife-SmartHome", preuzmite je i



instalirajte.

## **Za IOS pametne telephone:**

Metoda 1: Skenirajte QR kod i slijedite upute koje vas vode u "AppStore", preuzmite i instalirajte aplikaciju.

Metoda 2: Otvorite "AppStore" na svome pametnom telefonu i potražite aplikaciju "SmartLife-SmartHome", istu preuzmite i instalirajte.



### **Upozorenje:**

*Prilikom instaliranja aplikacije omogućite dozvole za pohranu/ lokaciju/ kameru kako ne bi imali problema pri radu aplikacije.*

# Aktivirajte Aplikaciju

**Prilikom prve upotrebe aplikacije, istu je potrebno aktivirati.**

1. Pokreni aplikaciju "SmartLife-SmartHome" na svome pametnom telefonu.



**SmartLife-SmartHome**

2. Metoda 1: Dodirni tipku "Scan" I skeniraj upravo aktivirani QR kod

Metoda 2: Dodirnite "Enter Activation Code" na dnu zaslona  
zatim unesite aktivirani kod I dodirnite CONFIRM (potvrđi).

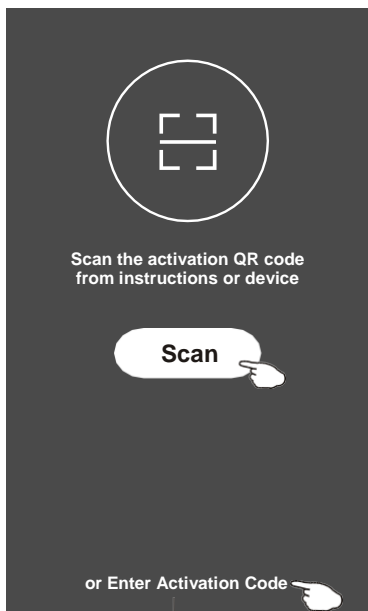

Aktivirajte QR kod I aktivacijski kod



*Opaska: Bez QR koda ili aktivacijskog koda, ne možete aktivirati i upotrebljavati aplikaciju. Čuvajte ih na sigurnom mjestu.*

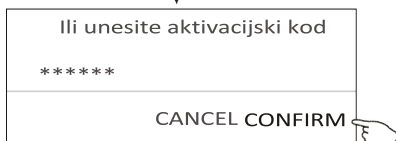

# Registracija

1. Ukoliko nemate račun molimo dodirnite tipku "Register" (registriraj se).
2. Pročitajte pravila o privatnosti "Privacy Policy" I dodirnite "Agree" (slažem se).

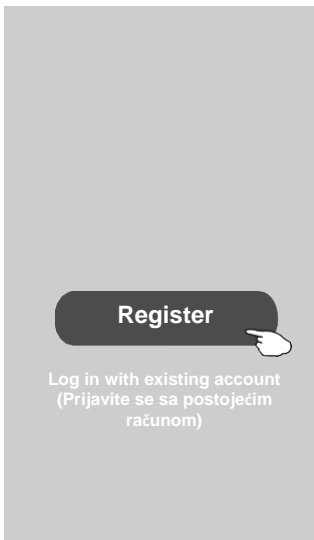

3. Dodirni ">" I izaberi zemlju.
4. Unesite svoju e-mail adresu.
5. Dodirnite tipku "Obtain verification code" (dobiti kontrolni kod).

Potražite zemlju ili pomaknite zaslom gore/ dolje da biste je našli. Odaberite zemlju.

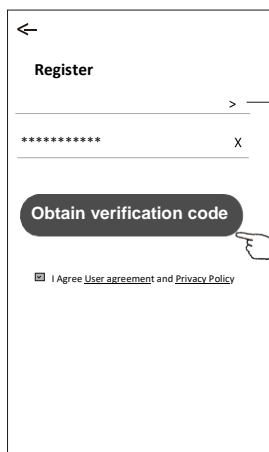

Unesite svoju e-mail adresu here

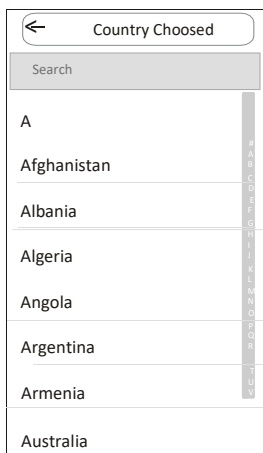

# Registracija

6. Unesite kontrolni kod koji ste dobili mailom.
7. Postavite lozinku od 6 do 20 znakova uključujući znakove I brojeve.

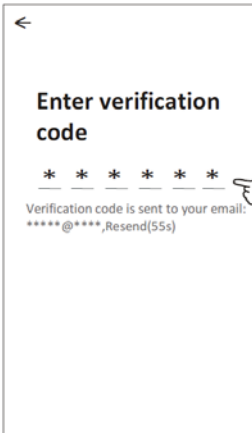

8. Dodirnite "Done" (gotovo).

# Login - prijava

1. Dodirnite "Log in with existing account" (prijava s postojećim računom).
2. Unesite svoj registrirani račun I lozinku.
3. Dodirnite tipku "Log in" (prijava).

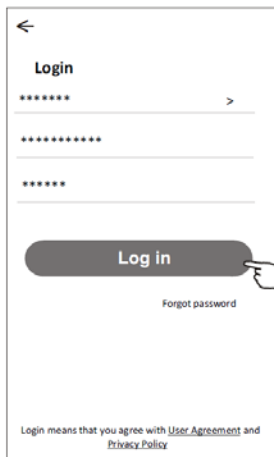
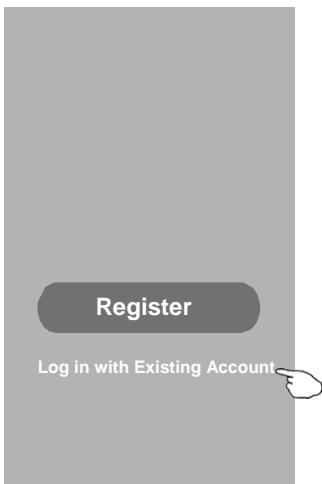

unesite svoj račun

unesite lozinku

# Login - prijava

## Pri prvom korištenju aplikacije potrebno je kreirati obitelj (Create family):

4. Dodirnite "Create family".
5. Dodijelite imena obitelji.
6. Postavite lokaciju.
7. Odaberite zadane sobe ili dodajte nove.
8. Dodirnite "Done" and "Completed".



Obitelj uspješno kreirana  
View family   Completed

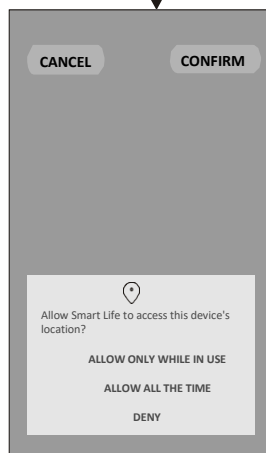
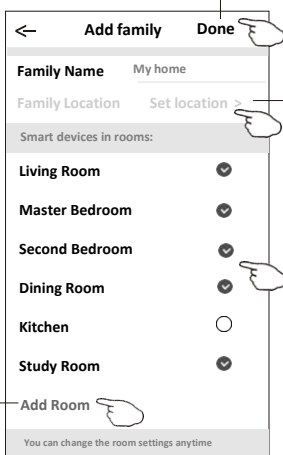

Odaberite preporučenu sobu ili napravite novu sobu, a zatim dodirnite Done (gotovo).

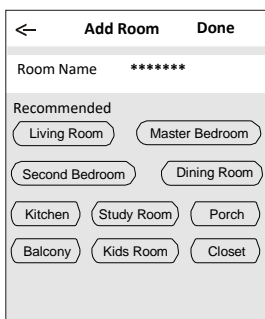

**Opaska:**  
Aplikacija može otvoriti kartu na vašem telefonu i možete postaviti mjesto na kojemu se nalazite.

## Zaboravili ste lozinku

Ukoliko ste zaboravili lozinku ili je želite promijeniti, postupite na sljedeći način:

1. Dodirnite "Forgot password" (zaboravljena lozinka).

2. Unesite račun (e-mail adresa) I dodirnite tipku "Obtain verification code" (dobiti kontrolni kod).

3. Unesite kontrolni kod primljen mailom.

4. Postavite novu lozinu I dodirnite tipku "Done".

←

**Login**

\*\*\*\*\* >

Email address

Password

**Log in**

[Forgot password](#)

Login means that you agree with [User Agreement](#) and [Privacy Policy](#)

←

**Forgot password**

\*\*\*\*\* >

\*\*\*\*\* X

**Obtain verification code**

←

**Enter verification code**

\* \* \* \* \*

Verification code is sent to your email:  
\*\*\*\*\*\_Resend(55s)

←

**Set Password**

\* \* \* \* \*

6-20 characters for password, including character, numbers

**Done**

# Dodajte uređaj

Postoje 2 metode kako dodati uređaj.

## 1-CF mode

1. Uključite unutarnju jedinicu, nije potrebno pokretati klima uređaj.
2. Klik "+" u gornjem desnom kutu početnog zaslona ili dodirnite "Add device" (dodajte uređaj) u prostoriji koja nema uređaj.
3. Dodirnite logo "Split Air Conditioner".
4. Unesite lozinku Wi-Fi mreže koja je ista kao i na vašem pametnom telefonu zatim dodirnite "Next" (dalje).
5. Slijedite komentare na "Next" zaslonu da biste resetirali Wi-Fi modul a zatim provjerite "Confirm the device is reset" (potvrda da je uređaj resetiran) i dodirnite "Next".
6. Možete vidjeti postotak procesa povezivanja, istodobno redom, svijetle na unutarnjem zaslonu "PP", "SA", "AP".  
"PP" znači "pretraživanje routera"  
"SA" znači "spojen s routerom"  
"AP" znači "spojeno na server"

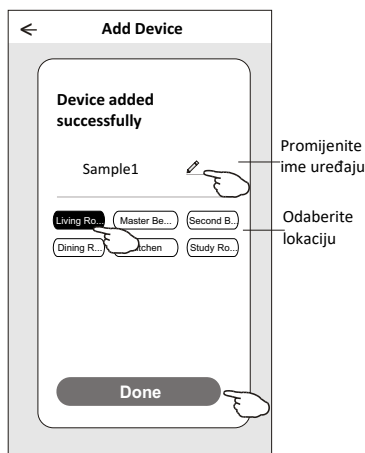
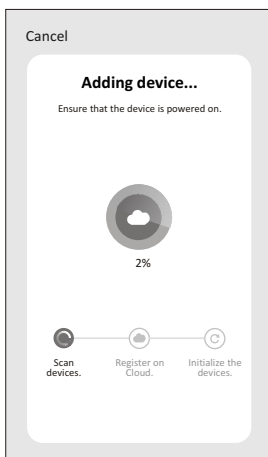
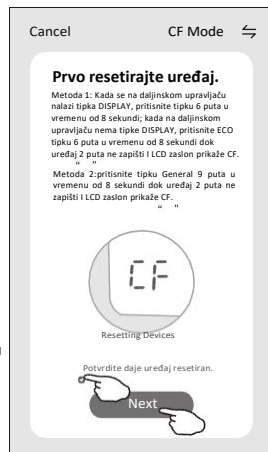
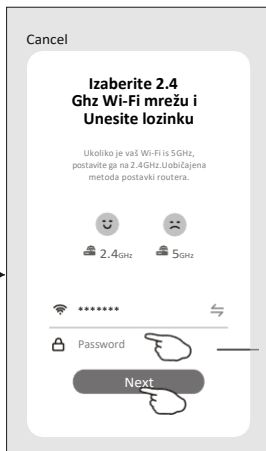
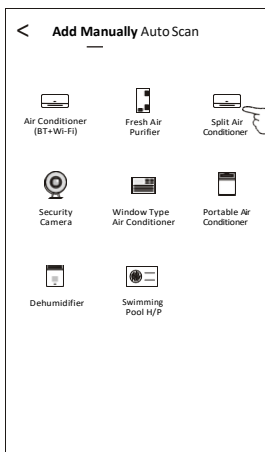
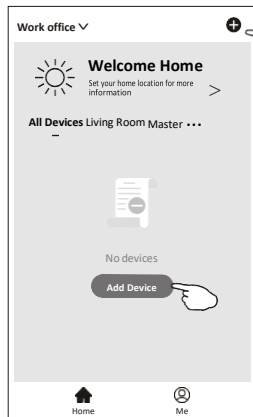

# Dodajte uređaj

Postoje 2 metode kako dodati uređaj.

## 2-AP mode (način rada)

1. Uključite unutarnju jedinicu, nije potrebno pokretati klima uređaj.
2. Kliknite "+" u gornjem desnom kutu početnog zaslona "Home" (kuća) ili dodirnite "Add device" (dodajte uređaj) u prostoriji koja nema uređaj.
3. Dodirnite logo "Split Air Conditioner".
4. Unesite lozinku Wi Fi mreže koja je ista kao i na vašem pametnom telefonu te dodirnite "Next" (dalje).
5. Tap ⇌ u gornjem desnom kutu i odaberite "AP Mode" zatim slijedite komentare na zaslonu Wi-Fi modula, potom provjerite "Confirm the device is reset" (potvrdite da je uređaj resetiran) i dodirnite "Next" (dalje).
6. Pažljivo pročitajte upute i dodirnite "Connect now" (poveži se sada).
7. Na zaslonu mrežnih postavki odaberite "SmartLife-\*\*\*\*", i dodirnite "<".
8. Možete vidjeti postotak procesa povezivanja, istodobno, redom, svijetle na unutarnjem zaslonu "PP", "SA", "AP".  
 "PP" znači "tražim router"  
 "SA" znači "spojen na router"  
 "AP" znači "povezan na server"

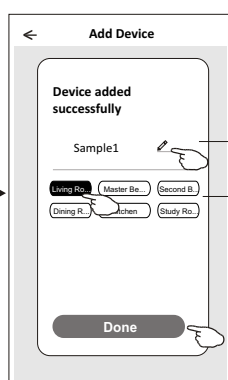
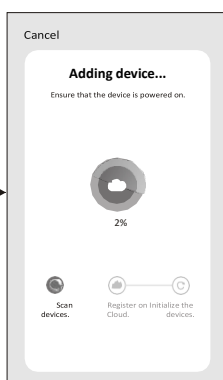
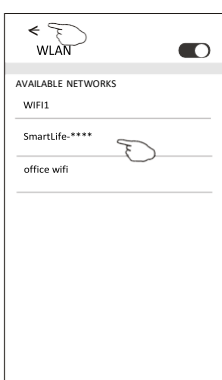
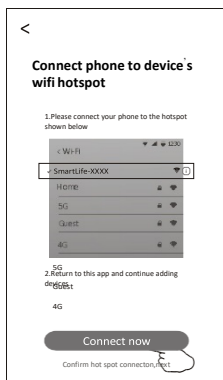
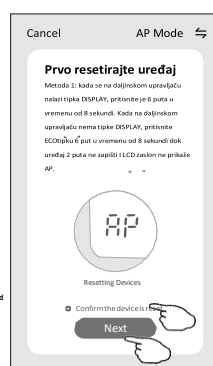
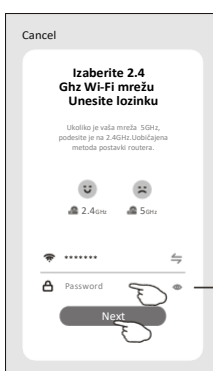
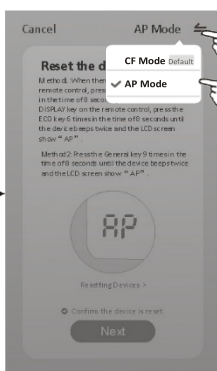
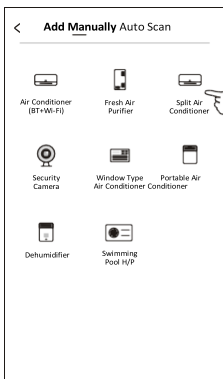
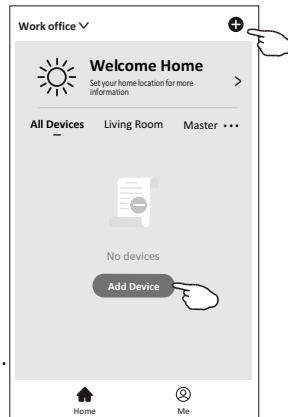

Promijenite ime  
Izaberite lokaciju



# Upravljanje klima uređajem

Zaslon za kontrolu uređaja pojaviti će se automatski nakon dodavanja uređaja.

Zaslon za kontrolu uređaja pojaviti će se ručno ukoliko upišemo naziv uređaja na početnom zaslonu.

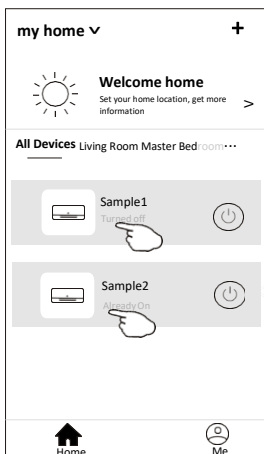

*Opaska:*

*Postoje dva različita upravljačka sučelja ovisno o tipu Wi Fi modula i/ ili vrsti programske podrške. Molimo pažljivo pročitajte priručnik na stvarnom upravljačkom sučelju.*

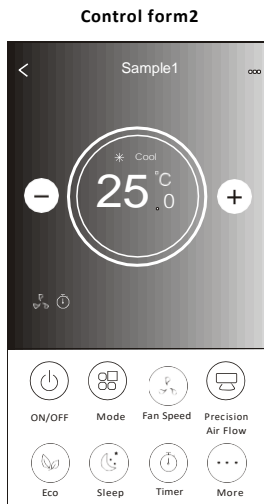
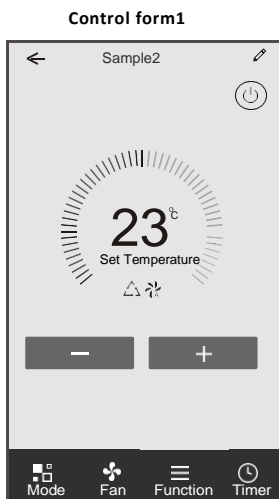

## Upravljačko sučelje 1

### Glavno upravljačko sučelje

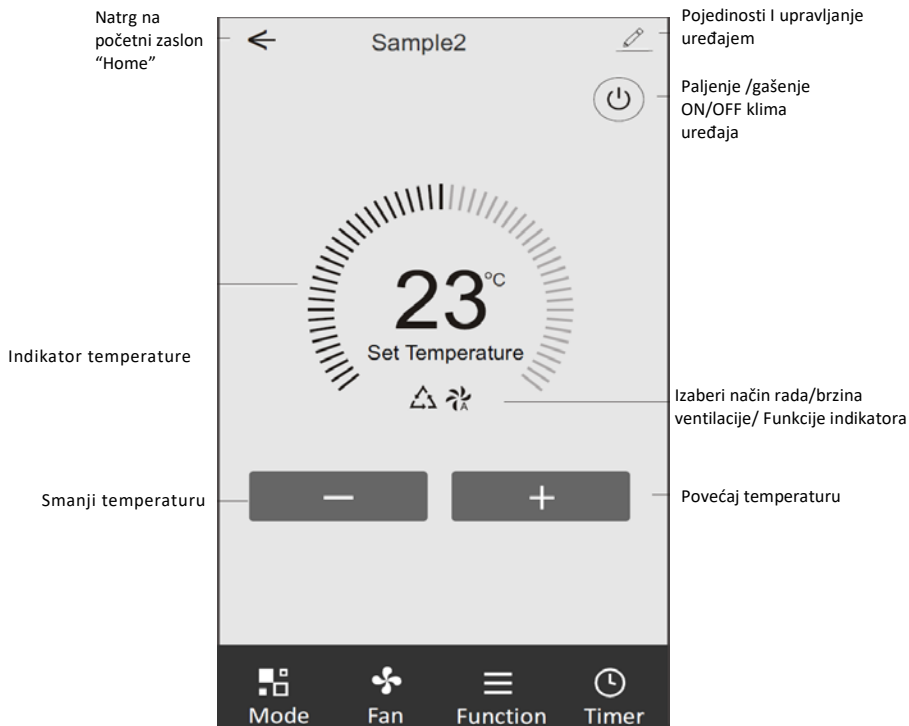

## Upravljačko sučelje 1-Podešavanje načina rada/ Mode

1. Dodirnite "Mode" da bi otvorili Mode zaslon.
2. Izaberite jednu od opcija Feel/Cool/Heat/Dry/Fan (Feel, hlađenje, grijanje, sušenje, ventilator).
3. Dodirnite bilo gdje oko postavljene temperature da biste otkazali ovaj način rada.

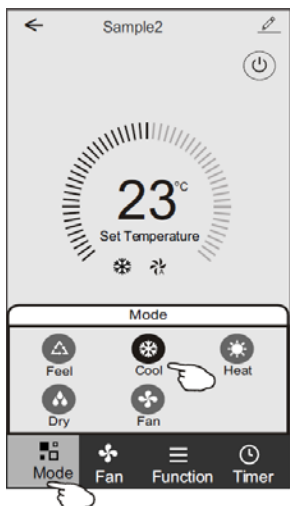

## Upravljačko sučelje 1-Odaberite brzinu ventilatora

1. Dodirnite "Fan" (ventilator) da biste otvorili Fan zaslon.
2. Dodirnite jednu od brzina ventilator High, Med, Low, Auto (visoka, srednja, niska, automatska).
3. Dodirnite bilo gdje oko postavljene temperature kako bi poništili ovaj odabir.



# Upravljanje klima uređajem

## Upravljačko sučelje 1- Postavka funkcija

1. Dodirnite "Function" kako biste otvorili zaslon.
2. Izaberite jednu od opcija Sleep/Turbo/ECO (spavanje, turbo, ECO).
3. Izaberite UP-DOWN (gore-dolje)/ LEFT-RIGHT (lijevo-desno) za automatsko njihanje krilaca u navedenim smjerovima.
4. Dodirnite bilo gdje oko postavljene temperature kako bi poništili ovu funkciju.

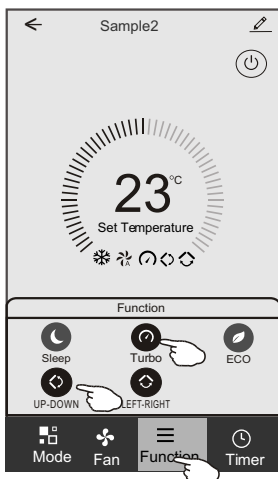

## Upravljačko sučelje 1-Dodaj programator-tajmer

1. Dodirnite "Timer" da biste otvorili zaslon "Add Timer" (dodaj programator).
2. Dodirni "Add Timer".

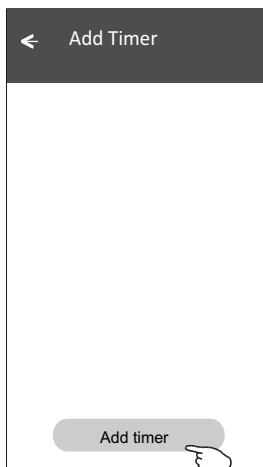
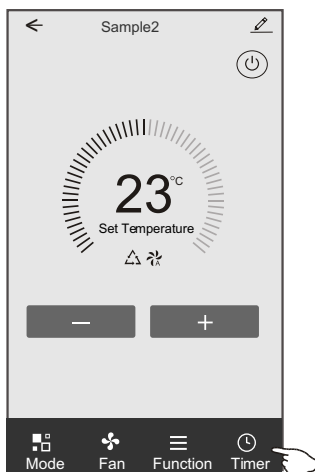

## Upravljačko sučelje 1-Dodaj programator-tajmer

Izaberite vrijeme, dane ponavljanja I uključivanja/ isključivanja programatora.

3. Odaberite način rada /brzina ventilatora/funkciju I postavite temperaturu za vrijeme kada je programator uključen.
4. Dodirni "Save" (spremi) za uključivanje programatora.

### Tajmer uključen

### Tajmer isključen

Tajmer otkazan — Cancel Add Timer Save

Postavka sata — 12 07 13 08 14 09 15 10 16 11 17 12 18 13

Način rada — Mode Cool >

Postavka ventilatora — Fan Auto >

Postavka temperature — Set Temperature 23°C > Function >

Spremiti postavke tajmera — Cancel Add Timer Save

Postavke minuta — 12 26 13 26 14 27 15 28 16 29 17 30 18 31

Tjedna postavka — Mon Tues Wed Thur Fri Sat Sun

Tajmer isključen — Timer Off (checked)

Tajmer uključen — Timer On

## Upravljačko sučelje 1-Upravljanje programatorom

1. Dodirnite traku programatora kako biste ga uredili.
2. Dodirni tipku kako bi uključili odnosno isključili programator.
3. Držite traku programatora oko 3 sekunda, iskočiti će zaslon "Remove Timer" (ukloni programator) dodirnite CONFIRM (potvrdi) I uklonite programator.

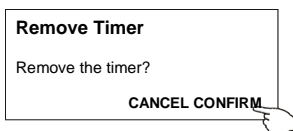
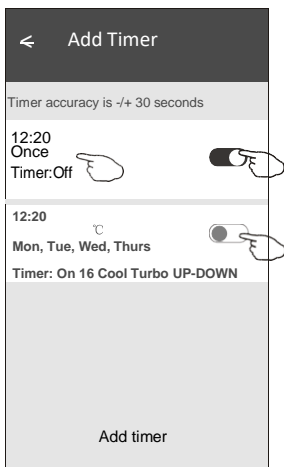

## Upravljačko sučelje 2

### Glavno upravljačko sučelje

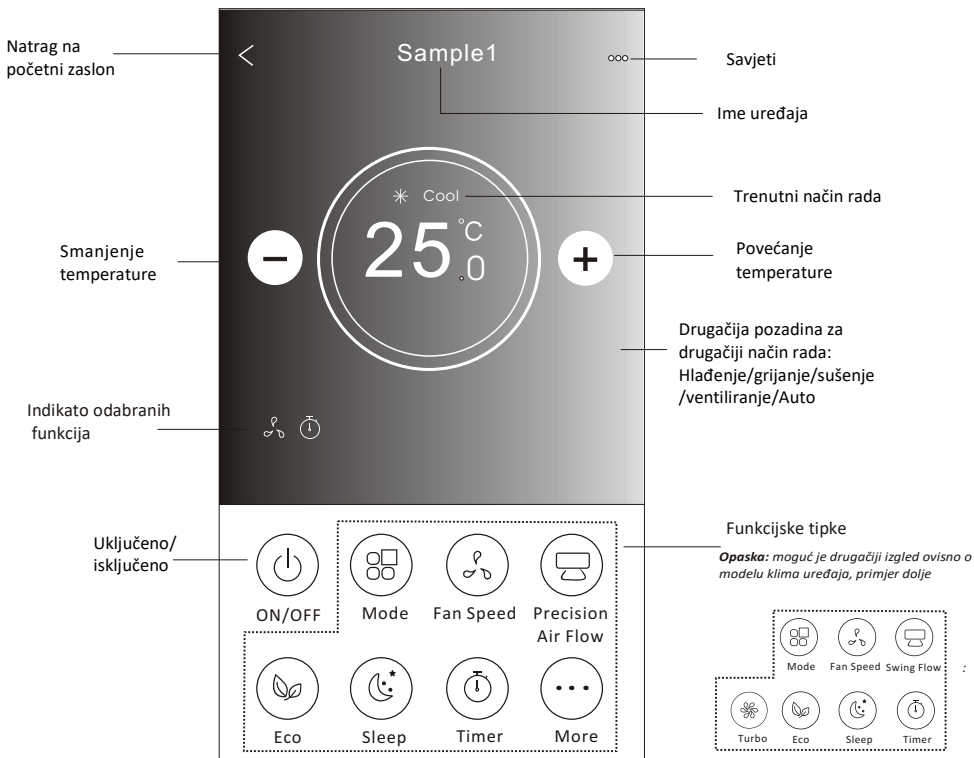

# Upravljanje klima uređajem

## Upravljačko sučelje 2-Način rada Mode

1. Dodirnite Mode tipku.
2. Na zaslonu se nalazi 5 različitih načina rad, dodirnite jednu tipku te postavite željeni način rada za klima uređaj.
3. Dodirnite tipku X za povratak na glavni kontrolni zaslon
4. Način rada i pozadina promijeniti će se na zaslonu.

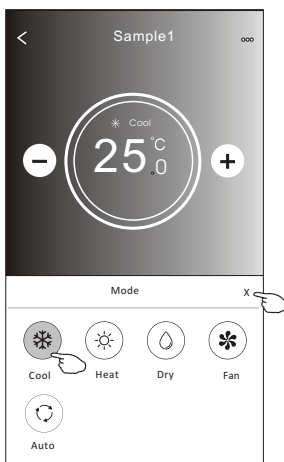
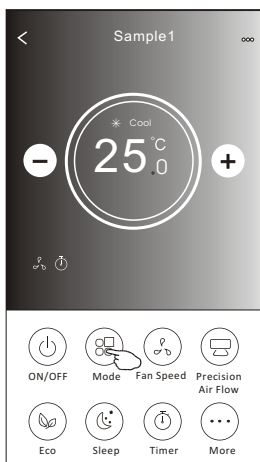

**Opaska:** molimo pročitajte detalje o svakom načinu rada kako bi upravljanje uređajem bilo što ugodnije.

## Upravljačko sučelje 2- brzina ventilatora

1. Dodirnite tipku brzina ventilatora.
2. Izaberite željenu brzinu i potvrdite je.
3. Dodirnite tipku X za povratak na početni zaslon.
4. Odabrani indikator brzine ventilator pojaviti će se na zaslonu.

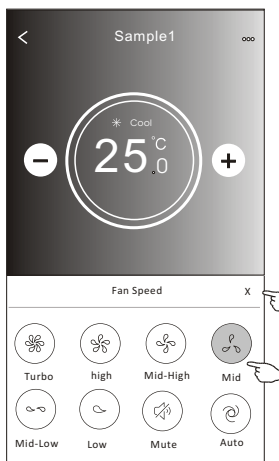
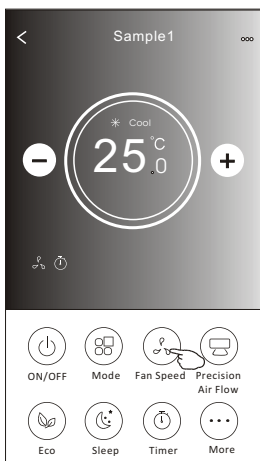

Mod	Brzina ventilatora
Cool	Sve brzine
Fan	Sve brzine
Dray	
Heat	Sve brzine
Auto	Sve brzine

**Opaska:** Ova funkcija ne radi u Dry modu.

**Opaska:** Zaslon brzine ventilatora može se razlikovati ovisno o modelu.

Primjer ispad:

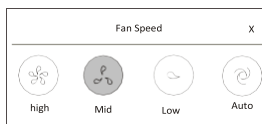

## Upravljačko sučelje 2-kontrola protoka zraka

1. Dodirnite tipku “Precision Air Flow” ili “Swing Flow”.
2. Izaberite željeni protok zraka i dodirnite ga.
3. Dodirnite X tipku za povratak na glavni kontrolni zaslon
4. Željeni indikator protoka zraka pojaviti će se na zaslonu.

**Opaska:** Za neke modele bez automatskog podešavanja lijevo/desno, ukoliko ga aktivirate, čuti će te zvučni signal ali bez radnje.

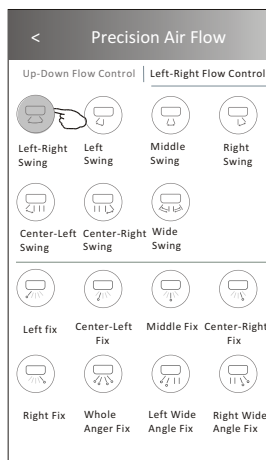
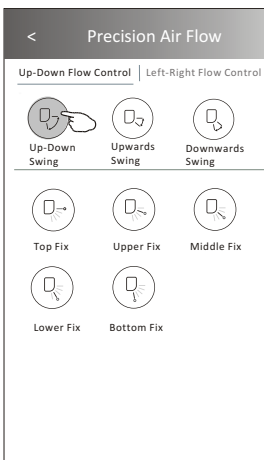
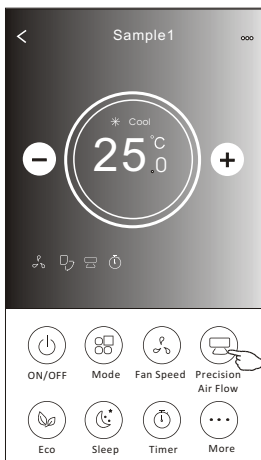

**Opaska:** Glavni kontrolni zaslon i zaslon protoka zraka može se razlikovati ovisno o modelu klima uređaja.

Kao na primjeru dolje:

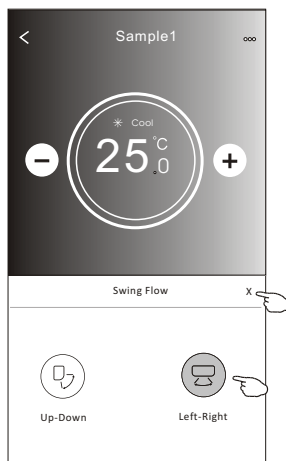
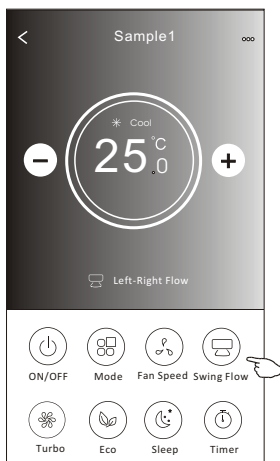



# Upravljanje klima uređajem

## Upravljačko sučelje 2-ECO funkcija

1. Za Eco funkciju samo dodirnite tipku da biste je aktivirali, tipka će zasvijetliti i na zaslonu će se pojaviti indikator.
2. Dodirnite ponovo da biste onemogućili funkciju.
3. Kontrola temperature za neke modele klima uređaja:  
U modu hlađenje "Cool" temperature može biti  $\geq 26\text{ }^{\circ}\text{C}$ .  
U modu grijanje "heat" temperature može biti  $\leq 25\text{ }^{\circ}\text{C}$ .

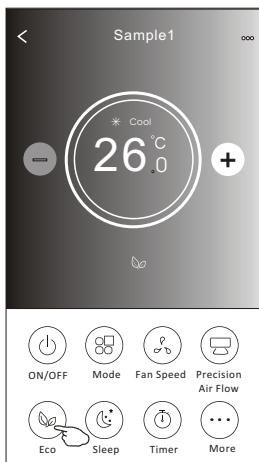
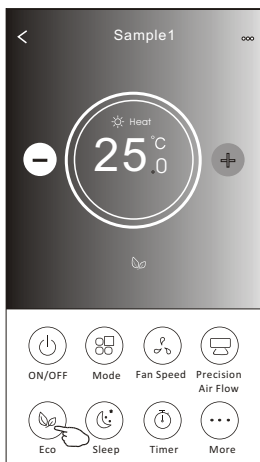

Mode	ECO moguć
Cool	da
Fan	
Dry	
Heat	da
Auto	

ECO nije moguć u Fan/ Dry/Auto mode .

**Opaska:** Glavni kontrolni zaslon i ECO način kontrole mogu se malo razlikovati ovisno o modelu klima uređaja.

Primjer ispod:



**Opaska:**

ECO je onemogućen i u načinu rada Turbo/ Sleep za neke modele klima uređaja.

# Upravljanje klima uređajem

## Upravljačko sučelje 2-Sleep/ noćni način rada

1. Dodirni "Sleep" tipku.
2. Izaberi željeni Sleep mode i potvrdi ga.
3. Dodirni X tipku za povratak na glavni kontrolni zaslon.
4. Željeni indikator Sleep će se pojaviti na ekranu.

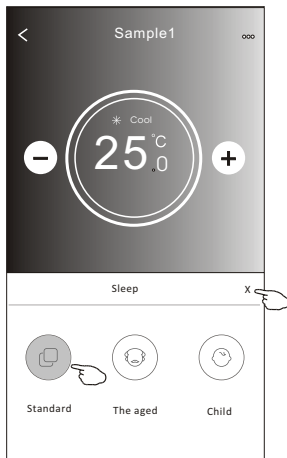

Mode	Sleep omogućen
Cool	Da
Fan	
Dry	
Heat	Da
Auto	

Sleep funkcija nije moguća u Fan/ Dry/Auto modu.

### Opaska:

Kontrolni zaslon može malo varirati ovisno o modelu klima uređaja.

Primjer ispod:

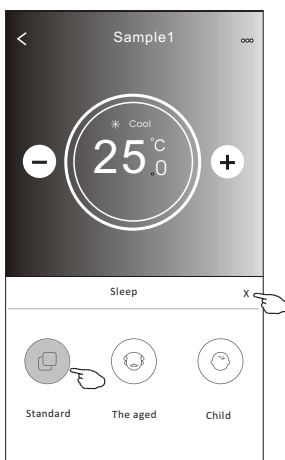
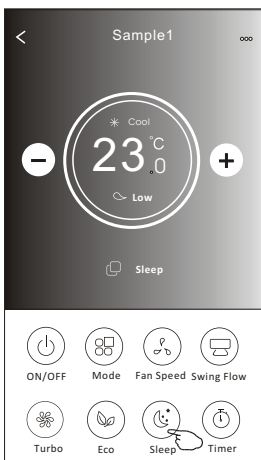

### Opaska:

Funkcija Sleep je onemogućena u Turbo/ Sleep modu za neke modele klima uređaja.

# Upravljanje klima uređajem

## Upravljačko sučelje 2-Programator

1. Dodirnite tipku programatora - tajmer.
2. Dodirnite + u desnom gornjem kutu na glavnom zaslonu programatora.
3. Izaberite vrijeme / ponavljanje / isključenje te zatim dodirnite "Save" (spremi).
4. Programator off (isključen) će se pojaviti na glavnom zaslonu.

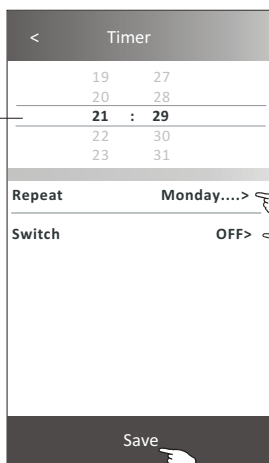
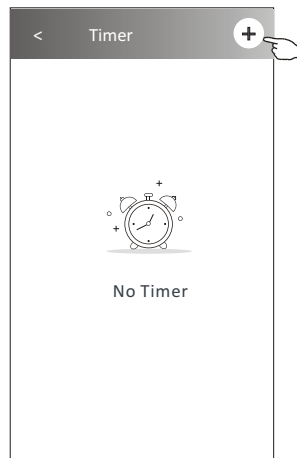
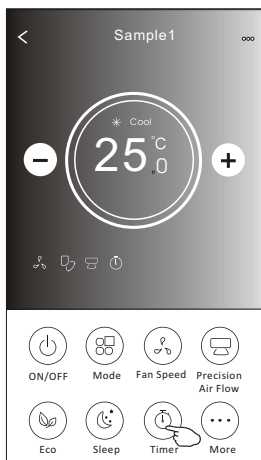

Klik repeat> zatim izaberite željene dane ponavljanja ili Once (jednom), zatim dodirnite Confirm za potvrdu.

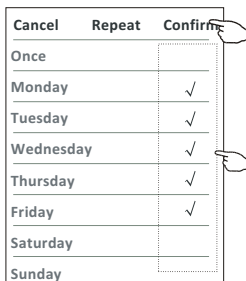

Klik Switch> zatim pomaknite zaslon da biste odabrali ON i potom Confirm.

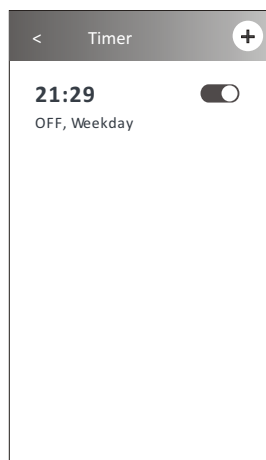
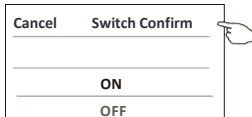

# Upravljanje klima uređajem

## Upravljačko sučelje 2-Programator (off) isključen

1. Dodirni tipku programator.
2. Dodirni + u gornjem desnom kutu kontrolnog zaslona.
3. Postavite vrijeme/ datum ponavljanja/ uključivanje/ temperatura/ način rada – mode/ brzina ventilatora/ protok zraka I dodirnite Save (spremi).
4. Programator će se pojaviti na glavnom zaslonu.

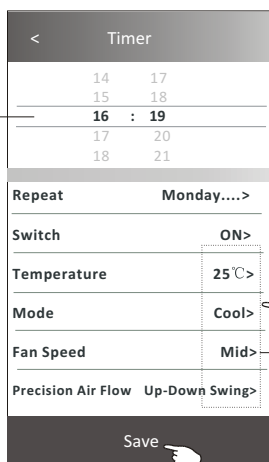
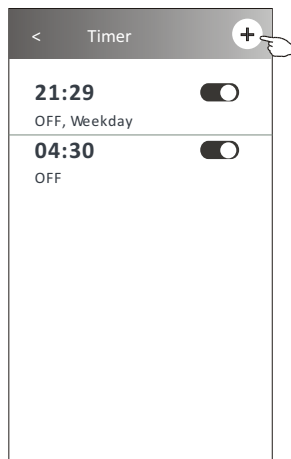
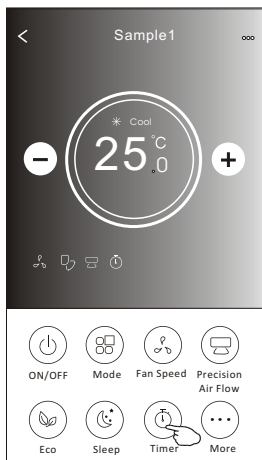

Klizite dolje/ gore da bi ste izabrali vrijeme.

Klik repeat> zatim izaberite željene dane ponavljanja ili Once (jednom), zatim dodirnite Confirm za potvrdu.



Tap Switch> zatim klizite po ekranu, izaberite ON i Confirm (potvrđi).

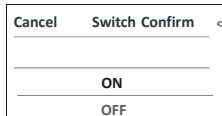

Klik temperatura/mod/brzina ventilatora/ protok zraka > jedan po jedan potom izaberite željeno kao u prethodnom poglavlju potom dodirnite Confirm the setting, za potvrdu.

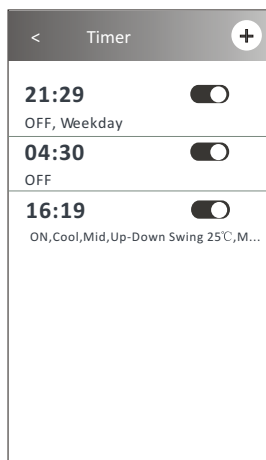

## Upravljačko sučelje 2-Upravljanje programatorom

### 1. Promijenite postavke programatora:

Dodirnite bilo koje mjesto na "Timer" traci da biste ušli u postavke, promijenite ih i spremite dodirnom na Save.

### 2. Omogućite ili onemogućite programator:

Dodirnite lijevu stranu ikone za uključivanje/isključivanje da biste onemogućili programator. Dodirnite desnu stranu te iste ikone za suprotno.

### 3. Izbrišite programator:

Klizite po traci programatora sa lijeva na desno dok se ne pojavi tipka Delete (izbriši), zatim je dodirnite.

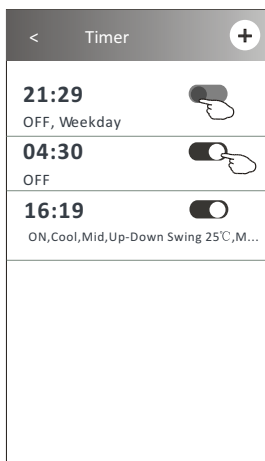
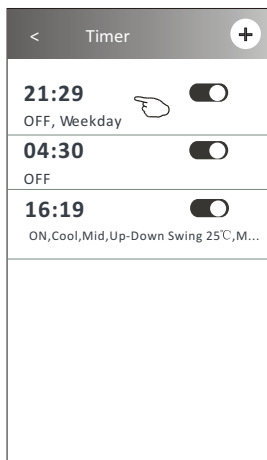

Klizi lijevo kako bi onemogućili programator.

Klizi desno kako bi omogućili programator.

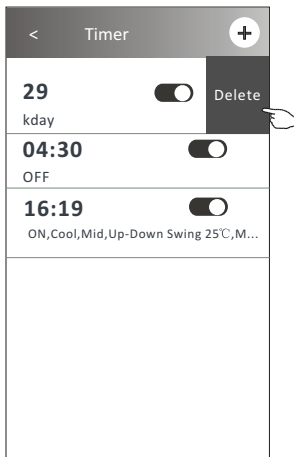

# Upravljanje klima uređajem

## Upravljačko sučelje 2-funkcija More (više)

1. Dodirnite tipku More za rad dodatnih funkcija, ukoliko će se pojaviti na zaslonu.

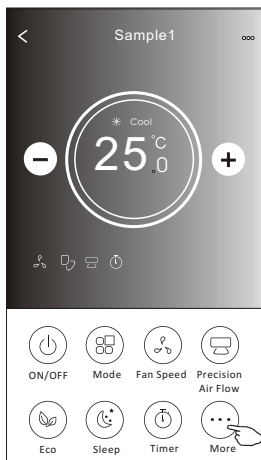

**Opaska:**  
Određeni klima uređaji  
nemaju ovu opciju.

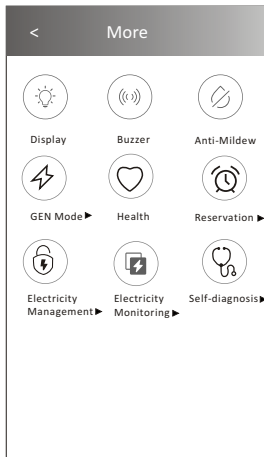

**Opaska:** Izgled se može razlikovati, neke ikone će biti skrivene ukoliko klima uređaj nema ovu funkciju ili je onemogućena u trenutnom načinu rada.

2. Dodirnite "Display" (zaslon) za uključivanje/ isključivanje unutarnjeg LED zaslona.



Display (zaslon)

3. Dodirnite "Buzzer" (vibraciju) da biste uključili/ isključili vibriranje prilikom rada putem Wi-Fi aplikacije.



Buzzer (vibracija)

4. Dodirnite "Anti-Mildew" (protiv plijesni) da biste aktivirali tu funkciju, ukoliko je dostupna na zaslonu. Nakon isključenja klima uređaja, pokrenuti će se program sušenja čime će se smanjiti zaostala vlaga i spriječiti stvaranje plijesni, nakon završenja funkcije, automatski će se isključiti.



Anti-Mildew (protiv plijesni)

5. Dodirnite "Health" (zdravlje) da biste uključili/ isključili tu funkciju, ukoliko je dostupna na zaslonu. Aktivira antibakterijsku funkciju ionizatora. Ova funkcija je samo za modele s generatorom ionizatora.



Health (zdravlje)

# Upravljanje klima uređajem

## Upravljačko sučelje 2- funkcija More (više)

6. Dodirnite "GEN Mod" ukoliko je dostupan na zaslonu.

U ovom načinu rada, možete izabrati jednu od 3 razine potrošnje energije. Klima uređaj će održavati zadanu razinu potrošnje radi uštede energije.

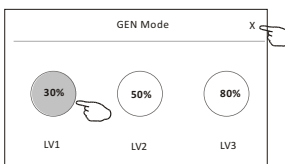
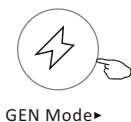

7. Dodirnite "Electricity Monitoring" (nadzor električne energije) ukoliko je dostupan. Pomoću ove funkcije možete nadzirati potrošnju električne energije klima uređaja.

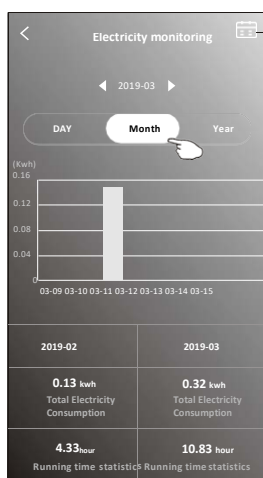
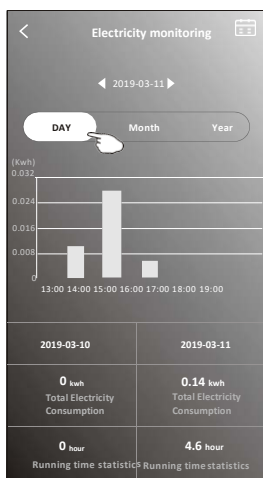
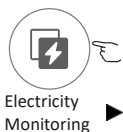

Dodirnite ovu tipku kako biste otvorili calendar te potom izaberite datum.

8. Dodirnite "Self-Cleaning" (samo čišćenje) ukoliko je dostupno na zaslonu. Provjerite detalje o ovoj funkciji u korisničkom priručniku.



9. Dodirnite "8 °C Heat" (grijanje), ukoliko je dostupna na ekranu. Ova funkcija pomaže u zadržavanju sobne temperature iznad 8 °C. Provjerite detalje o ovoj funkciji u uputama.



## Upravljačko sučelje 2- funkcija More (više)

10. Dodirnite "Reservation" (rezervacija) ukoliko je dostupan na zaslonu. Možete postaviti vrijeme, ponoviti dan, temperaturu, mode –način rada, brzinu ventilatora, protok zraka, po želji te dodirnuti Save (spremi) kako bi aktivirali ovu funkciju.

Klima uređaj će automatski pokrenuti vaše postavke u zadano vrijeme.



Reservation ►

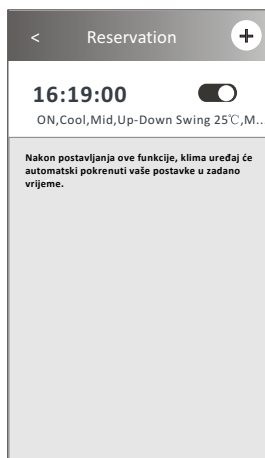
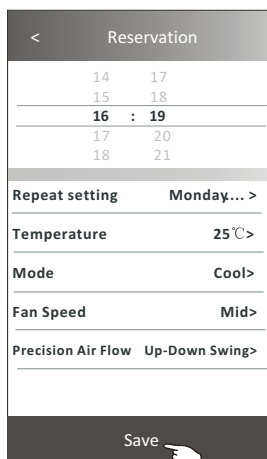

11. Dodirnite "Self-diagnosis" (samodijagnoza) ukoliko je dostupna na zaslonu.

Klima uređaj će izvršiti samodijagnozu, naznačiti kod pogreške i rješenja za problem, ukoiko je moguće.



Self-diagnosis ►

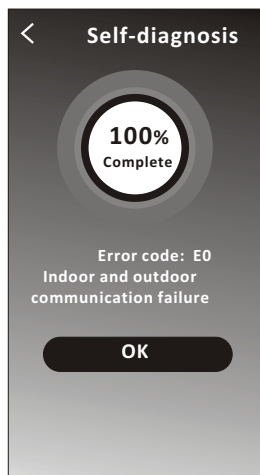
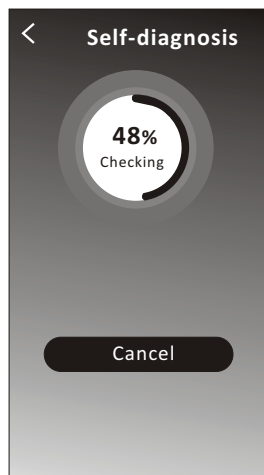



### Upravljačko sučelje 2-funkcija More (više)

12. Dodirnite "Photosensitive" (fotosenzibilno) ukoliko je dostupna na zaslonu. Ova funkcija omogućuje klima uređaju da automatski uključi/ isključi zaslon u skladu sa intezitetom svjetlosti.



Photosensitive

13. Dodirnite "Soft wind" (blagi vjetar) ukoliko je dostupan na zaslonu. U ovoj funkciji klima uređaj će puhati blagi zrak kroz mikro otvore na deflektoru.



Soft Wind

### Pojedinosti I upravljanje uređajem

Dodirnite  na kontrolnom obrascu 1 ili dodirnite kontrolni obrazac 2, otvorite zaslon s detaljima uređaja. Ovdje možete dobiti korisne informacije I dijeliti uređaj sa drugim računima. Pažljivo provjerite sljedeće upute I slike.

# Kontrola klima uređaja

upravljačko sučelje 1

Control form1

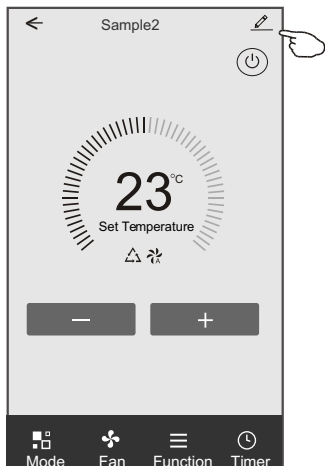

upravljačko sučelje 2

Control form2

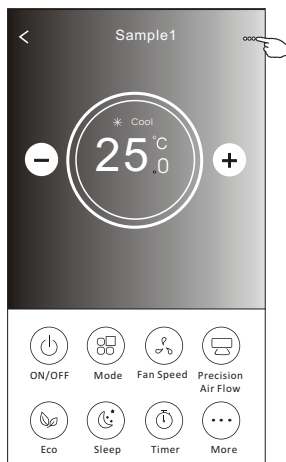

Dodirni za promjenu lokacije uređaja u drugu sobu.

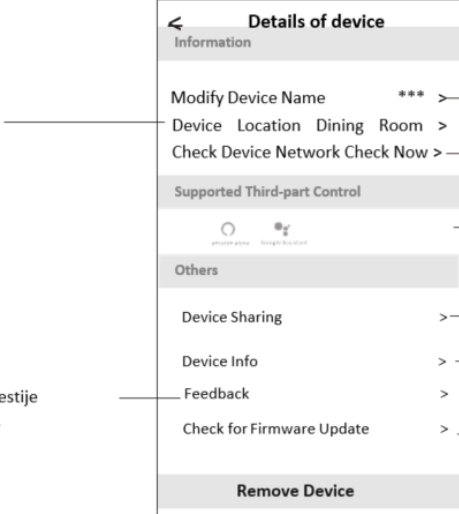

Dodirni za provjeru mreže.

Dodirni za provjeru mreže.

Dodirni da bi dobio upute za spajanje na Amazon Alexa ili Google Assistant glasovnu kontrolu.

Dodirni za dijeljenje uređaja sa drugim računima.

Dodirni za provjeru Virtual ID/Wi-Fi imena/IP adrese, MAC adrese/vremenske zone/Wi-Fi jačine signala.

Provjeri i ažuriraj software.

Dodirni da ukloniš uređaj, uređaj će se automatski resetirati nakon brisanja.

Pošaljite probleme ili sugestije administratoru aplikacije.

## Pojedinosti I upravljanje uređajem

### Kako dijeliti uređaj sa drugim računima?

1. Dodirni "Device Sharing" (dijeljenje uređaja) I iskočiti će zaslon "Sharing screen".
2. Dodirni "Add Sharing" (dodaj dijeljenje).
3. Odaberite regiju I unesite račun koji želite dijeliti.
4. Dodirnite "Completed" (dovršeno), račun će se pojaviti na vašem popisu dijeljenja.
5. Primljeni članovi trebaju pritisnuti početni zaslon I kliziti prema doje da osvježe popis uređaja, uređaj bi se trebao pojaviti na popisu.

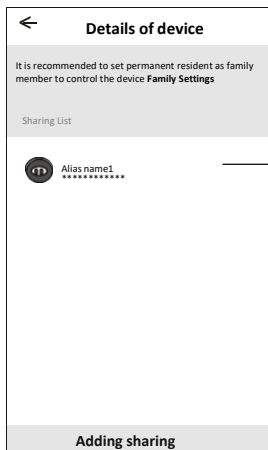
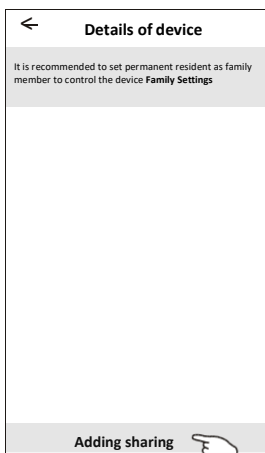
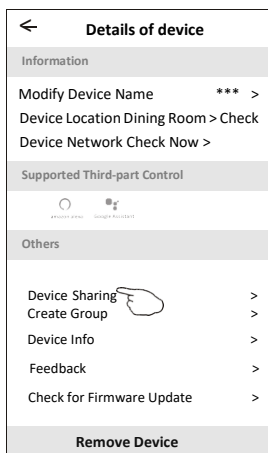

Držite traku približno 3 s a zatim možete izbrisati račun za dijeljenje.

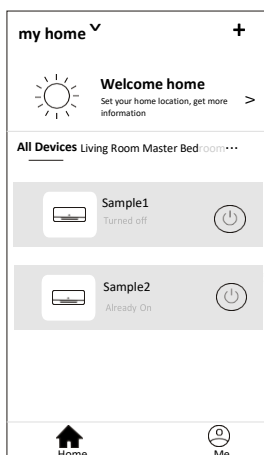

Držite I klizite prema dolje da biste osvježili popis uređaja.

## Postavke profila računa

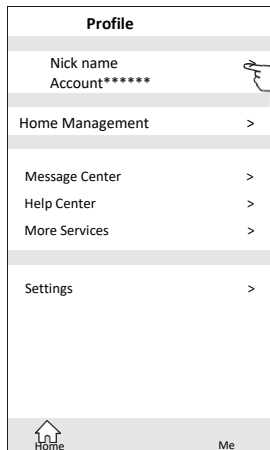
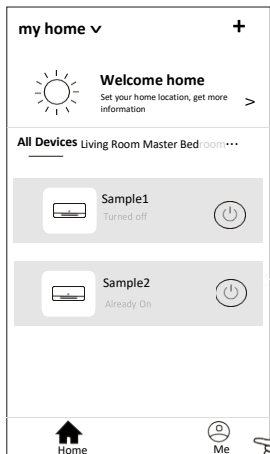

Promijenite nadimak svog računa

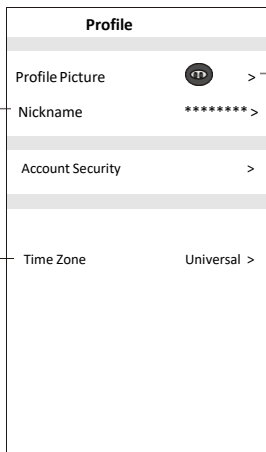
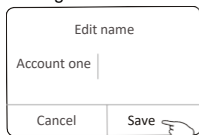

Izaberite vremensku zonu

Izaberite sliku za račun iz albuma.

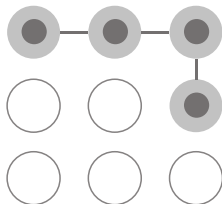

Postavite lozinku da bi pokrenuli aplikaciju.

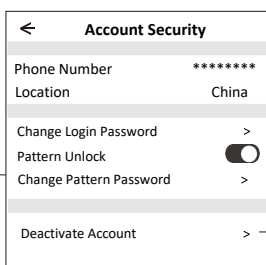

Promijenite lozinku po uputama za promjenu lozine, str. 7.

Omogući ili onemogući lozinku uzorka.

Pažljivo deaktivirajte račun jer će se svi podaci izbrisati.

# Upravljanje računom

## Home(Family) management-upravljanje kućom (obitelji)

1. Dodirni naziv kuće u lijevom gornjem kutu početnog zaslona i odaberite Home Management (upravljanje kućom), ili dodirnite Me (ja) i dodirnite Home Management.
2. Dodirnite jednu od obitelji na popisu obitelji i otvorite zaslon obiteljske postavke.

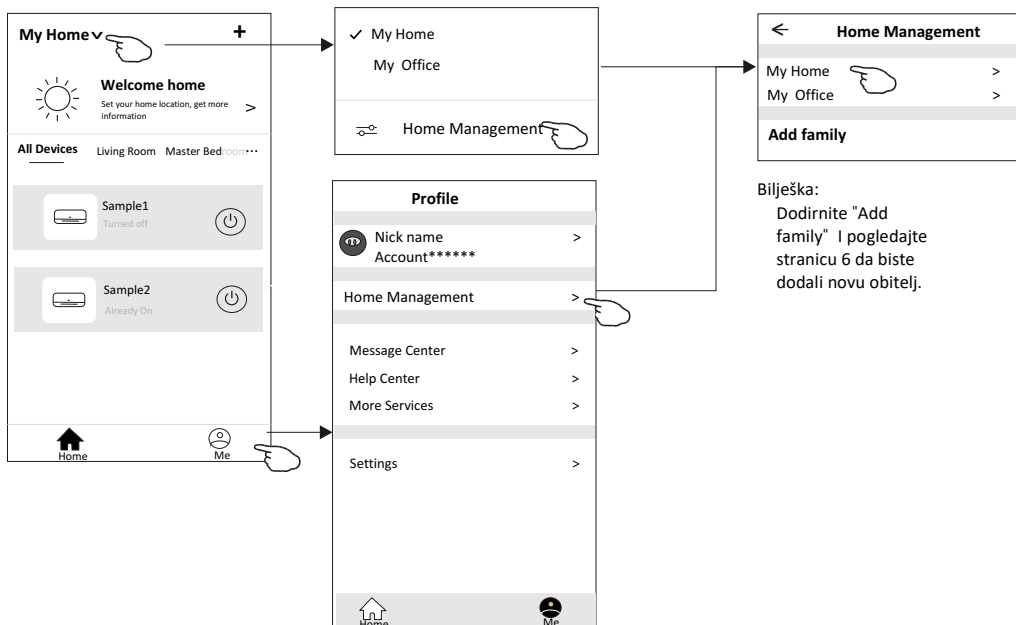

Bilješka:  
Dodirnite "Add family" i pogledajte stranicu 6 da biste dodali novu obitelj.

3. Postavite obitelj kao sljedeće pokazatelje.

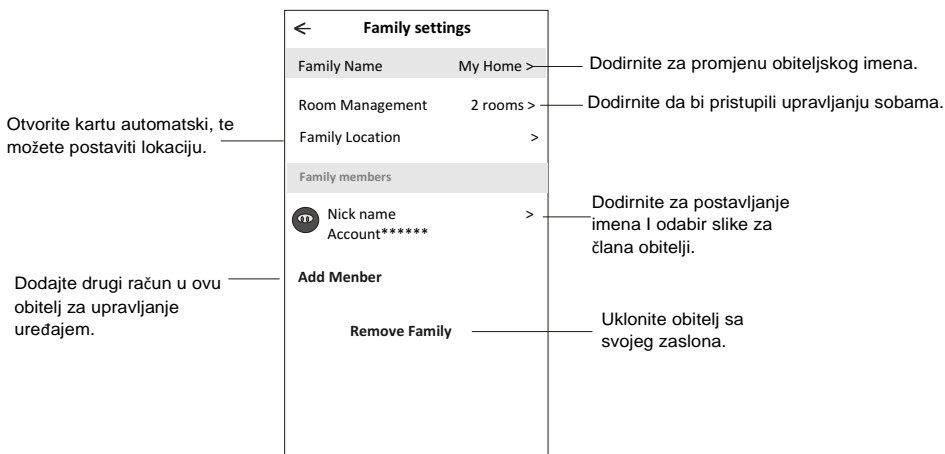

1. Za tehničko ažuriranje, možda postoje odstupanja stvarnih stavki od onoga što je u priručniku. Ispričavamo se. Pogledajte svoj proizvod i aplikaciju.
2. Aplikacija pametnog klima uređaja može se izmijeniti bez najave radi poboljšanja kvalitete, a također se može izbrisati ovisno o okolnostima proizvodnih tvrtki.
3. U slučaju da je snaga Wi-Fi signala oslabljena, pametna aplikacija možda će biti prekinuta. Pazite da unutarnja jedinica bude u blizini bežičnog routera.
4. Za bežični router treba aktivirati funkciju DHCP poslužitelja.
5. Internet veza može biti neuspješna zbog problema u postavkama vatrozida. U tom slučaju kontaktirajte davatelja internet usluge.
6. Zbog sigurnosti samog telefona i mrežnih postavki, vodite računa da je aplikacija koju koristite pouzdana.

## Rješavanje problema

Opis	Analiza
<b>Klima uređaj nije moguće uspješno konfigurirati</b>	<ol style="list-style-type: none"> <li>1. Provjeri da li je unesena ispravna lozinka i naziv mreže (SSID) od wlan routera.</li> <li>2. Provjerite postoje li dodatne postavke WLAN routera kako je prikazano u nastavku.               <ol style="list-style-type: none"> <li>1) Vatrozid samim routerom ili računalom</li> <li>2) Filtriranje MAC adrese</li> <li>3) Skriveni SSID</li> <li>4) DHCP poslužitelj</li> </ol> </li> </ol> <p>Ponovo pokrenite WLAN router, mobilni uređaj i klima uređaj (WLAN modul) i ponovo spojite klima uređaj putem CF mode.a. Prije ponovnog pokretanja provjerite je li se netko već povezo s istim klima uređajem.</p>
<b>Mobitel ne može kontrolirati klima uređaj</b>	<p>Kada se klima uređaj (WLAN modul) ponovo pokrene i aplikacija prikazuje Device romove (uklanjanje uređaja), ignoriranje ove potvrde dovesti će do toga da mobilni uređaj gubi kontrolu nad klima uređajem.</p> <p>Morat ćete ponovno spojiti klima uređaj na način CF.</p> <ol style="list-style-type: none"> <li>2. U slučaju nestanka struje, mobilni uređaj će izgubiti dozvolu upravljanja klima uređajem za 3 minute nakon nestanka struje. (Obavijest će se sada prikazivati na mobilnom uređaju.)</li> </ol> <p>Ako ne možete upravljati aplikacijom (klima uređajem) ni nakon vraćanja napajanja, morat ćete ponovno spojiti klima uređaj putem načina CF.</p>
<b>Mobitel ne može naći klima uređaj</b>	<ol style="list-style-type: none"> <li>1) Smart Life zaslon aplikacije Air conditioner offline (klima uređaj Uređaj izvan mreže). Molimo provjerite sljedeće uvjete:               <ol style="list-style-type: none"> <li>1) Klima uređaj je rekonfiguriran.</li> <li>2) Klima uređaj isključen iz struje.</li> <li>3) Router je isključen iz napajanja.</li> <li>4) Klima uređaj se ne može povezati s routerom.</li> <li>5) Klima uređaj se ne može povezati na mrežu putem routera.</li> <li>6) Mobilni uređaj se ne može povezati s mrežom.</li> </ol> </li> <li>2. Nakon dodavanja uređaja, on nestaje na popisu uređaja.</li> </ol> <p>Držite i povucite prema dolje da biste osvježili popis uređaja. Ako nema promjena, isključite aplikaciju i pokrenite ponovno.</p>



