



CARRON
P H O E N I X

Fitting Instructions

Stainless Steel Inset

Notes prior to installation:

The position of your sink will be determined by the relationship of the sink rim to cabinet gables, supports and tap location.

You will need:

Fitting clips (included)	Screwdriver
Electric saw with jigsaw fitment	Hammer
Translucent Silicone / Sealing Strip	Masking tape (optional)

- 1 Place the sink face down on the underside of the worksurface and draw around the edge of the sink rim. Measure 8mm in from the sink edge and draw a second line all the way around following the original line.

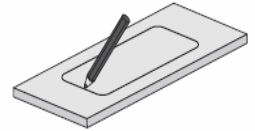

- 2 Cut out the hole for your sink following the second line, 8mm in from the original outline.

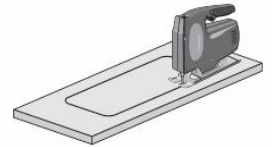

- 3 Fix the clips (supplied) to the clip rail on the sink and check the sink and worksurface align correctly.

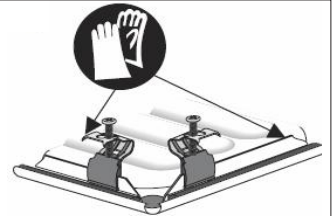

- 4 Clean the adjoining area of the sink rim and worksurface with a solvent to remove any dust or grease.
Apply a continuous bead of translucent silicone to the worksurface or the sink rim or use the sealing strip provided.



- 5 Position the sink in the cut out hole and position the clip leg into position. lightly hand tighten the screws starting in the middle of the back edge of the sink. Secure the screw directly opposite that to ensure correct fitting. If required re-align the sink within the hole before hand tightening the clips.

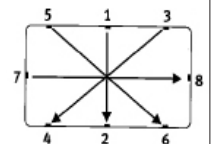

- 6 Use a damp cloth to remove any excess silicone that has been squeezed out beyond the cut out edge.

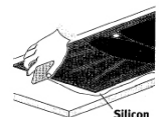



CARRON
P H O E N I X

Cleaning Instructions

Stainless Steel Inset

Day to day care of your stainless steel sink:

Care must be taken when cleaning your sink or indeed in it's every day use.

Never use a wire wool pad such as Brillo® to clean your sink. It will create tiny scratches and will also shed small pieces of mild steel that later rust and give the appearance that your sink is rusting. This is not the case and once adhered to your sink, it's very difficult to remove the small particles that can be left.

Instead, clean regularly with normal detergent and warm water. Always make a habit of drying your sink afterwards and buffing with a soft cloth. Long-term this will help develop a lovely rich patina and it will ensure that no build up of limescale or other mineral deposits can occur.

If scouring is required, always use a Scotchbrite® pad and try to scour in the same direction as the natural grain on the sink's surface.

Minor scratching of the sink's surface is extremely difficult to avoid and is not something to be unduly concerned about. The drainer area in particular is likely to pick up scratches due to hard objects being placed upon it. These marks are usually only superficial and can be removed with a proprietary stainless steel cleaner. A useful alternative is a car paint restorer such as T-Cut.

The quality of your water can affect the good looks of your sink by giving the appearance of staining. This 'staining' is generally a build up of limescale or similar mineral deposit, particularly prevalent in hard water areas. Limescale readily absorbs staining agents such as tea, coffee, red wine etc, spoiling the appearance of your sink. For this reason always rinse and dry your sink after each use to avoid mineral deposits being left behind on the surface when the water evaporates.

To remove any limescale that has built up on your sink try using products such as Viakal® or Limelite®. Alternatively, soak in a solution of one part vinegar to three parts water. This will loosen the limescale making it possible to then scrub it away with a Scotchbrite® pad and kitchen sink cleaner.

Take care to avoid

Using a plastic washing up bowl. Particles of grit or glass could become embedded in the base of the plastic bowl and these will scratch your sink. Bleach or other cleaning agents containing bleach should not be left in contact with stainless steel as discolouration or pitting of the steel could result. Harsh abrasives and scouring materials should not be used for cleaning stainless steel as they will leave scratch marks on the surface.

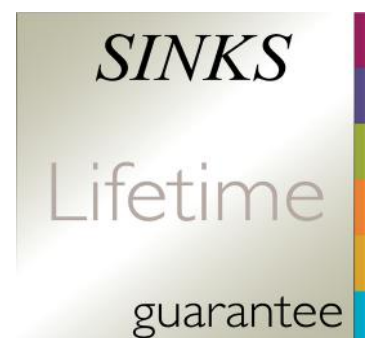

Your proof of purchase validates your sink's lifetime guarantee against manufacturing defect.