

NESPRESSO®

VertuoPlus



My
Machine

KRUPS®

Nespresso Vertuo is an exclusive system creating a perfect coffee, from the Espresso to the large Alto, time after time. Nespresso Vertuo machines are equipped with the unique Centrifusion® technology to gently extract an Alto, Mug, Gran Lungo or Espresso at the touch of a button. Each extracting parameter has been carefully defined by Nespresso coffee experts to ensure that all aromas from each Grand Cru can be extracted to give the coffee body and create an exceptionally rich and generous crema.

CONTENT

ASSISTANCE VIDEOS ARE AVAILABLE ON WWW.NESPRESSO.COM - VISIT "MACHINES" SECTION



These instructions are part of the appliance. Read all instructions and safety instructions before operating the appliance.

SAFETY PRECAUTIONS	3	TROUBLESHOOTING	24
OVERVIEW	7	CONTACT THE NESPRESSO CLUB	26
PACKAGING CONTENT	7	DISPOSAL AND ENVIRONMENTAL PROTECTION	26
SPECIFICATIONS	7	LIMITED GUARANTEE	27
MACHINE HANDLING	8		
FIRST USE OR AFTER A LONG PERIOD OF NON-USE	10		
COFFEE PREPARATION	12		
ENERGY SAVING CONCEPT	14		
PROGRAMMING THE WATER VOLUME	15		
 <u>SPECIAL FUNCTIONS</u>			
CLEANING	16		
RESET TO FACTORY SETTINGS	17		
EMPTYING THE SYSTEM	18		
BEFORE A PERIOD OF NON-USE, FOR FROST PROTECTION			
OR BEFORE A REPAIR	18		
DESCALING	19		
BUTTON INDICATORS/BLINKING SUMMARY	22		

SAFETY PRECAUTIONS

⚠ CAUTION: Use of controls, adjustments or performance of procedures other than those specified here in may result in hazardous radiation exposure.

⚠ CAUTION: when you see this sign, please refer to the safety precautions to avoid possible harm and damage.

ℹ INFORMATION: when you see this sign, please take note of the advice for the correct and safe usage of your appliance.

⚠ WARNING: the safety precautions are part of the appliance. Read them carefully before using your new appliance for the first time. Keep them in a place where you can find and refer to them later on.

- The appliance is intended to prepare beverages according to these instructions.
- Do not use the appliance for anything other than its intended use.
- This appliance has been designed for indoor and non-extreme temperature conditions use only.
- Protect the appliance from direct sunlight effect, prolonged water splash and humidity.
- This is a household appliance only. It is not intended to be used in: staff kitchen areas in shops, offices and other working environments; farm houses; by clients in hotels, motels and other residential type environments; bed and breakfast type environments.
- This appliance may be used by children of at least 8 years of age, as long as they are supervised and have been given instructions about using the appliance safely and are fully aware of the dangers involved.
- Cleaning and user maintenance shall not be carried out by children unless they are older than 8 years of age and they are supervised by an adult.
- Keep the appliance and its cord out of reach of children under 8 years of age.
- This appliance may be used by persons with reduced physical, sensory or mental capabilities, or whose experience or knowledge is not sufficient, provided they are supervised or have received instruction to use the appliance safely and understand the dangers.
- Children shall not use the appliance as a toy.
- The manufacturer accepts no responsibility and the guarantee will not apply for any commercial use, inappropriate handling or use of the appliance, any damage resulting from use for other purposes, faulty operation, non-professionals repair or failure to comply with the instructions.

Avoid risk of fatal electric shock and fire

- In case of emergency: immediately remove the plug from the power outlet. Exception: do not remove plug in case of pinching during machine head movement, when automatic reverse mechanism will operate.
- Only plug the appliance into suitable, easily accessible, earthed mains connections. Make sure that the voltage of the power source is the same as that specified on the rating plate. The use of an incorrect connection voids the guarantee.
- The appliance must only be connected after installation.
- Do not pull the cord over sharp edges, clamp it or allow it to hang down.
- Keep the cord away from heat and damp.
- If the supply cord or the plug are damaged, they must be replaced by the manufacturer, its service agent or similarly qualified persons, in order to avoid all risks.
- If the cord or the plug are damaged, do not operate the appliance. Return the appliance to the *Nespresso Club* or to a *Nespresso* authorised representative.
- If an extension cord is required, use only an earthed cord with a conductor cross-section of at least 1.0 mm² or matching input power.
- To avoid hazardous damage, never place the appliance on or beside hot surfaces such as radiators, stoves, ovens, gas burners, open flame, or similar.
- Always place it on a horizontal, stable and even surface. The surface must be resistant to heat and fluids, like water, coffee, descaler or similar liquids.
- Disconnect the appliance from the mains when not in use for a long period. Disconnect by pulling out the plug and not by pulling the cord itself or the cord may become damaged.
- Before cleaning and servicing, remove the plug from the mains socket and let the appliance cool down.
- To disconnect the appliance, stop any preparation, then remove the plug from the power socket.
- Never touch the cord with wet hands.
- Never immerse the appliance or part of it in water or other liquid.
- Never put the appliance or part of it in a dishwasher.
- Electricity and water together is dangerous and can lead to fatal electrical shocks.
- Do not open the appliance. Hazardous voltage inside!
- Do not put anything into any openings. Doing so may cause fire or electrical shock!

Avoid possible harm when operating the appliance

- Never leave the appliance unattended during operation.
- Do not use the appliance if it is damaged or not operating perfectly. Immediately remove the plug from the power socket. Contact the *Nespresso* Club or *Nespresso* authorised representative for examination, repair or adjustment.
- A damaged appliance can cause electrical shocks, burns and fire.
- Risk of scalding by hot liquids. If the machine is forced open hot liquids and coffee grounds may splash. Always lock the system completely and never open it during operation.
- Do not put fingers under coffee outlet, risk of scalding.
- Do not insert fingers into capsule compartment when machine head is closing. Risk of injury.
- Do not put fingers into the capsule compartment or capsule shaft, risk of injury!
-  Be careful not to injure yourself on sharp points or trap your fingers when reaching inside the machine.
- Never use a damaged or deformed capsule.
- Always fill the water tank with fresh drinking water.
- Empty water tank if the appliance will not be used for an extended time (holidays, etc.).
- Do not use any other liquid (such as cow's milk, soya milk, enriched milks, flavoured liquids, etc.).
- Replace water in water tank when the appliance is not operated for a weekend or a similar period of time.
- Do not use the appliance without a cup placed at the suitable cup support level and ensure the cup support is in place after any usage, to avoid spilling any liquid on surrounding surfaces.
- Do not use any strong cleaning agent or solvent cleaner. Use a damp cloth and mild cleaning agent to clean the surface of the appliance.
- To clean machine, Use fresh and clean tools (fresh and clean cloths, fresh and clean sponges, clean paper towels) to execute the cleaning of the equipment.
- When unpacking the machine, remove the plastic film and dispose.
- This appliance is designed for *Nespresso Vertuo* coffee capsules available exclusively through the *Nespresso* Club or your *Nespresso* authorised representative.
- All *Nespresso* appliances pass stringent controls. Reliability tests under practical conditions are performed randomly

SAFETY PRECAUTIONS

on selected units. This can show traces of any previous use.

- The use of accessory attachments not recommended by the manufacturer may result in fire, electric shock or injury to persons.
- *Nespresso* reserves the right to change instructions without prior notice.
- Unplug appliance when not in use for a long period and before cleaning. Allow to cool down before putting on or taking off parts, and before cleaning.

Descaling

- *Nespresso* descaling agent, when used correctly, helps ensure the proper functioning of your machine over

its lifetime and that your coffee experience is as perfect as the first day.

- For coffee and coffee&milk machines, descale according to user manual recommendations or specific alerts.

SAVE THESE INSTRUCTIONS

Pass them on to any subsequent user.

This Instruction Manual is also available as a PDF file at nespresso.com

OVERVIEW



SPECIFICATIONS

EN

XN900

~ 220 - 240 V, 50Hz, 1260 W

kg ~ 4.6 kg

l 1.7 l

	If water tank on the side	If water tank at the back
	232 mm	142mm
	335 mm	423 mm
	325 mm	
	419 mm	
	411 mm	

PACKAGING CONTENT



Coffee Machine



Nespresso Capsules Box

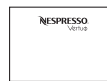

Nespresso Welcome Material



User Manual

WATER TANK



- 1 The water tank arm can be rotated and positioned at the back, to the left or to the right hand side of the machine.



- 2 Remove the water tank by tilting it slightly backwards, then gently pulling it up. Put the water tank in position by placing it vertically onto its arm, until there is a 'click' sound.

⚠ WARNING: Be careful when removing the water tank since the machine may tilt during the movement.

CAPSULE CONTAINER



- 1 Remove the water tank, then remove the capsule container by sliding it sideways.



- 2 Place the capsule container in the back of the machine by sliding it sideways into position. It is held in place by a magnet. Place the water tank back.

CUP SUPPORT

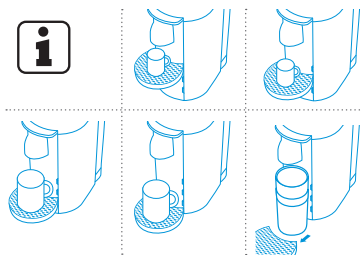

① The cup support has 4 positions and can be temporarily removed to accommodate various cup sizes.



② To place the cup support, slide cup support straight into the holes and gently push down until the hooks are well in place. To remove it, gently lift straight up and then pull the cup support out.

⚠ CAUTION: Be careful when removing the cup support since it may contain warm liquid. Make sure the cup support is properly placed before putting the cup.

POWER CABLE

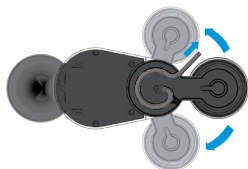

① The power cable can be adjusted under the machine. Insert the remaining cable in the guide on the left or on the right side socket, depending on the position chosen for the water tank. Ensure machine is in the upright position.

EN FIRST USE OR AFTER A LONG PERIOD OF NON-USE

⚠ CAUTION: First read the Safety Precautions to avoid risks of fatal electrical shock and fire.

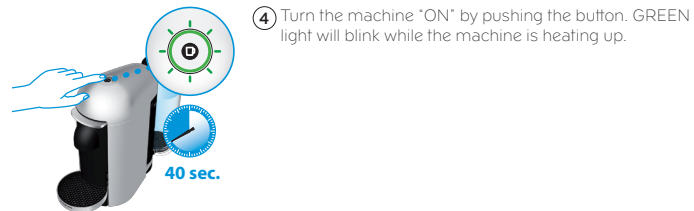
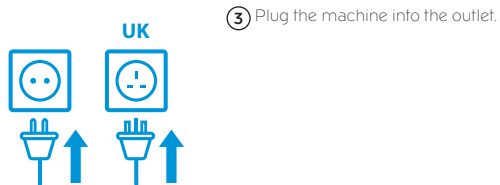
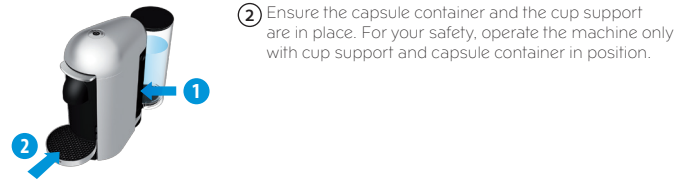
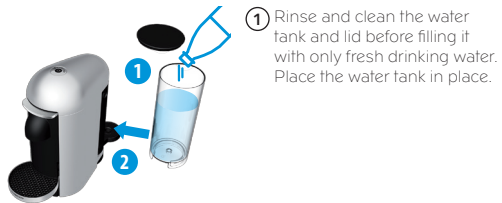



⑤ Steady GREEN lights will indicate the machine is ready.



⑥ Place a cup of at least 0.8 l under the coffee outlet.



⑦ Open the machine head by pressing the lever up to eject the capsule and then push the lever down to close it.



⑧ Push the button 3 times in 2 seconds to start cleaning and let the cleaning procedure complete automatically. ORANGE lights will blink during the operation. It will take less than 2 minutes before a flow comes out. The procedure consists of 3 cycles of pumping water in, internal cleaning and water flowing from the outlet to complete.



5 min.

⑨ This procedure may take up to 5 minutes. The procedure can be stopped at any time by pushing the button. The button will go to steady GREEN. To restart the cleaning process, follow the instructions starting at point 8. To brew a coffee, insert a capsule, push the lever down to close the machine and push the button.

EN COFFEE PREPARATION

⚠ CAUTION: Be careful not to injure yourself on sharp points or trap your fingers when reaching inside the machine.

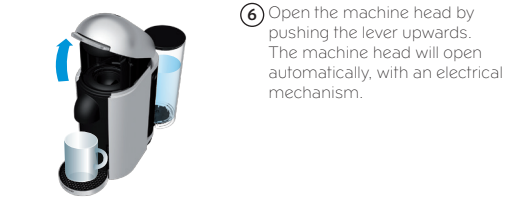
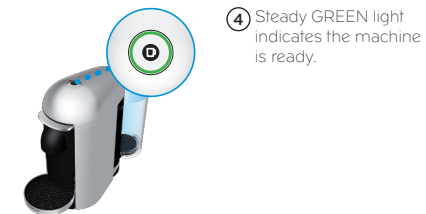
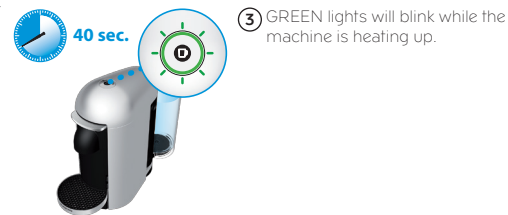
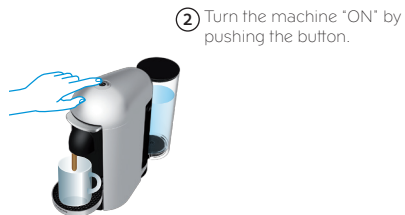
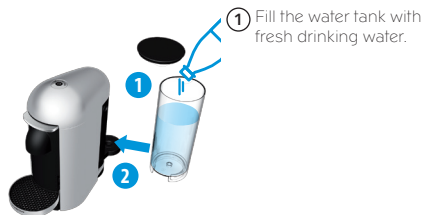

i NOTE: This machine operates with *Nespresso Vertuo* capsules. *Nespresso classic* capsules cannot be used in this machine.



i NOTE: The factory settings and recommended cup sizes are:
Alto: 414ml
Mug: 230ml
Gran Lungo: 150ml
Espresso: 40ml

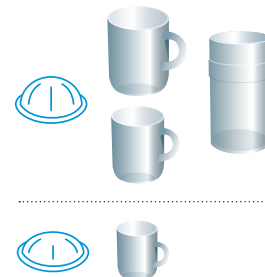



7 Insert a capsule with the dome shape facing downward.

i NOTE: To avoid damaging the machine, use only fresh, unused capsules. Ensure previous capsule has been ejected before inserting a fresh one.



8 Push the lever down to close the machine head.



9 Push the button to start the brewing process. Green light will rotate slowly during the barcode reading and pre-wetting phase.

i NOTE: You can do this even when the machine is still heating up. The coffee will then flow automatically when the machine is ready. The machine will automatically recognize the inserted capsule and select the coffee preparation parameters and cup length defined by Nespresso coffee experts to extract the coffee blend at its best.



10 During the coffee preparation phase coffee will start to flow. GREEN light will rotate quickly during brewing. Steady GREEN light indicates that coffee brewing is ready.



11 To stop the coffee flow early, push the button. Steady GREEN light indicates that coffee brewing is ready.

EN COFFEE PREPARATION



- ⑫ To manually top off your coffee, push the button and push again to stop when desired volume is reached.



- ⑬ To eject the capsule, open the machine head by pushing the lever upwards. The machine head will open automatically with an electrical mechanism.

i NOTE: It is recommended to eject the capsule directly at the end of the brewing.

ENERGY SAVING CONCEPT



The machine can be turned 'OFF' at any time, by closing the machine head and then pushing the lever down for 3 seconds. Automatic 'OFF' Mode: The machine will turn off automatically after 9 minutes of non-use.

i NOTE: The machine head should be in closed position when the machine is turned off.

PROGRAMMING THE WATER VOLUME

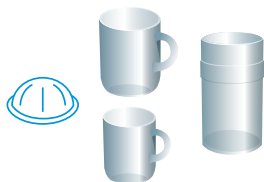

① The programming is specific to each capsule size, Alto, Mug, Gran Lungo or Espresso. Cup sizes can be reprogrammed from 10 ml to 500 ml.



③ Push and hold the button until desired volume is reached.

② Open the machine head by pressing the lever upwards; Insert the capsule blend you want to program; Close the head by pushing the lever down.

④ Water volume level is now stored for the capsule size used for the programming.

i NOTE: Once a customer-specific volume is programmed by the user, every time that capsule size is inserted in the machine, the preparation will stop at the user-programmed cup size. It is possible to restore cup size volumes; refer to "Reset to factory settings" section.

SPECIAL FUNCTIONS

CLEANING

i NOTE: The machine has a predefined cleaning procedure that can be launched at user discretion.

⚠ CAUTION: Do not use any strong or abrasive cleaning agent or solvent cleaner. Do not put in a dishwasher. Never immerse the appliance or part of it in water. Clean the coffee outlet regularly with a damp cloth. Please use only clean cloths for cleaning the machine.



① Rinse and clean the water tank and lid before filling it with fresh drinking water. Place the water tank in place.



② Rinse the cup support. Place a container of at least 0.8 l under the coffee outlet.



③ Open the machine head by pushing the lever up and let the used capsule be ejected, then close the machine. Empty and rinse the capsule container.



④ Push the button 3 times in 2 seconds to start the cleaning cycle. ORANGE light will blink during the cycle. It will take less than 2 minutes before a flow comes out. The cleaning procedure will run automatically for 5 minutes. The procedure consists of 3 cycles of pumping water in, internal cleaning and water flowing from the outlet to complete.

⑤ The procedure can be stopped at any time by pushing the button. The button will go to steady GREEN light when ready for brewing. To restart the cleaning process, follow the instructions starting at point 4. To brew a coffee, insert a capsule, push the lever down to close the machine and push the button.

RESET TO FACTORY SETTINGS

i NOTE: Choose special function by pressing the lever down: 1 time for "Descaling", 2 times for "Emptying the system", 3 times for "Reset to factory settings"



① Turn the machine "OFF" by pushing the lever down for 3 seconds.



② To enter "Factory settings" mode, push the button and the lever down at the same time for 3 seconds. ORANGE steady light indicates entry into the Special Functions menu.



③ Choose function by pressing the lever down: - 3 times for "Reset to factory settings"

i NOTE: the machine will blink 3 times every 2 seconds until the button will be pressed.

i NOTE: Choose function within 2 minutes or else the machine will go back to Ready mode. ORANGE light will blink 3 times every 2 seconds, indicating the "Factory reset" function.



④ Push the button to confirm. ORANGE light will blink 3 times in 3 seconds to confirm reset is done and then go to steady GREEN. The machine is now ready to use.

i NOTE: It is possible at any time to exit the Special Functions menu by pushing the button and pressing the lever down at the same time for 3 seconds. GREEN steady light indicates the machine is ready.

EMPTYING THE SYSTEM

BEFORE A PERIOD OF NON-USE, FOR FROST PROTECTION OR BEFORE A REPAIR



- ① Empty the water tank and put it in place.



- ② Open the machine head and let the used capsule be ejected. Close the machine. Empty the capsule container.



- ③ Turn the machine "OFF" by pushing the lever down for 3 seconds.



- ④ Place a container under the coffee outlet. To enter "Emptying the system" mode push the button and the lever down at the same time for 3 seconds. ORANGE steady light indicates entry into the Special functions menu.



- ⑤ Choose function by pressing the lever down - 2 times for "Emptying the system"

i NOTE: the machine will blink twice every 2 seconds until the button will be pressed.

i NOTE: Choose function within 2 minutes or else the machine will go back to Ready mode. ORANGE light will blink 2 times every 2 seconds, indicating the "Emptying the system" function.



- ⑥ Push the button. The ORANGE light will blink during the entire procedure. The machine turns "OFF" automatically when machine is empty.



⚠ CAUTION: Caution should be exercised as the machine evacuates remaining liquids using heat. Small quantities of steam may emit from the machine.

i NOTE: It is possible at any time to exit the Special Functions menu by pushing the button and pressing the lever down at the same time for 3 seconds. GREEN steady light indicates the machine is ready.

DESCALING

ASSISTANCE VIDEOS ARE AVAILABLE ON WWW.NESPRESSO.COM - VISIT "MACHINES" SECTION

i NOTE: Duration: Approximately 20 minutes.

⚠ CAUTION: Read the Safety Precautions on the descaling package. The descaling solution can be harmful. Avoid contact with eyes, skin and surfaces. Never use any product other than the Nespresso descaling kit available through the Nespresso Club to avoid damage to your machine. For any additional questions you may have regarding descaling, please contact your Nespresso Club.



① Turn the machine "ON" by pushing the button.



② Open the machine head by pushing the lever upwards and let the used capsule be ejected. Close the machine by pushing the lever down.



③ Turn the machine "OFF" by pushing the lever down for 3 seconds.

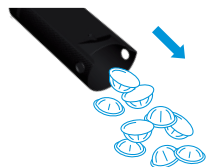

④ Empty the cup support and the used capsule container.

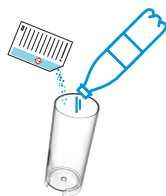

⑤ Fill the water tank with 1 unit of Nespresso descaling liquid and add minimum 0.5 l of water.

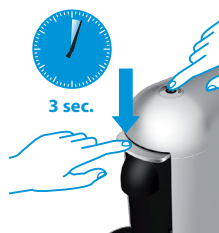

⑥ To enter "Descaling" mode, push the button and the lever down at the same time for 3 seconds. ORANGE steady light indicates entry into the Special Functions menu.

DESCALING

ASSISTANCE VIDEOS ARE AVAILABLE ON WWW.NESPRESSO.COM - VISIT THE "MACHINES" SECTION



- ⑦ Choose function by pressing the lever down:
- 1 time for "Descaling"

i NOTE: the machine will blink once every 2 seconds until the button will be pressed.

i NOTE: Choose function within 2 minutes or else the machine will go back to Ready mode. ORANGE light will blink 1 time every 2 seconds, indicating the "Descaling" function.



- ⑧ Place a recipient (minimum volume: 0.8 l) under the coffee outlet.



- ⑨ To start descaling, push the button. The machine will stop automatically when complete. ORANGE light will blink during the entire descaling process.



- ⑩ Empty, clean and rinse the water tank and cup support thoroughly.



- ⑪ Fill the water tank with fresh drinking water and put it back in place on the machine.



- 12 When ready, push the button to rinse the machine. Machine will stop automatically when complete. ORANGE light blinking once every 2 seconds confirms the descaling process is completed. The procedure can be stopped at any time by pushing the button.

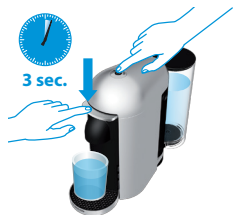

- 13 To exit descaling mode, press the button and the lever down at the same time for 3 seconds.



















- 14 GREEN steady light when ready.

- 15 Descaling is completed. Allow the machine to dry for 10 minutes before using it.

- 16 The machine is now ready for use.

i NOTE: This machine is equipped with a descaling alert: GREEN and RED steady light. Machine can only be operated to make coffee a few more times once the alert appears before descaling becomes mandatory. If the machine is completely scaled, the descaling program may not function and the machine will stop and blink. Pause the program in this case for several minutes, allowing the descaling agent to penetrate the scale build-up, then push the button again to restart the descaling.

BUTTON INDICATORS/BLINKING SUMMARY

		0"	1"	2"
NO LIGHT				
No light on the button	Machine OFF → see point 1*			
GREEN LIGHT - NORMAL USE				
Steady light	Ready mode			
Regular blinking: Once/second	Heating up			
Slow rotation	Capsule bar code reading			
Fast rotation	Coffee preparation			
Blink three times	Programming is confirmed			
RED LIGHT - WARNING OR ERROR				
Steady light	Device error → see point 17*			
Pulse down: Fade to OFF then ON	Cooling down after overheating → see point 18*			
Regular blinking: Once/second	Error → see point 14*			
Blink two times and then back to steady GREEN	Water tank is empty or capsule missing → see point 15*			
Blink two times and then back to steady ORANGE	Error in special function → see point 20*			

RED LIGHT - WARNING OR ERROR		0"	1"	2"
Blink two times and then back to ORANGE blinking	Error while special function running → see point 19*			
Blink three times every 2 seconds in between a steady RED light	Machine head in unknown position → see point 16*			
Steady light, left side RED and right side GREEN	Descaling alarm → see point 13*			
ORANGE LIGHT - SPECIAL FUNCTIONS				
Steady light	Entering special functions menu			
Regular blinking: Once/second	Special function is running			
Blink once every 2 seconds	Descaling → see points 21-22*			
Blink twice every 2 seconds	Emptying the system → see points 21-22*			
Blink three times every 2 seconds	Reset to factory settings → see points 21-22*			
Blink three times within 3 seconds and then back to steady GREEN	Reset to factory settings has been completed			

*See pages 24-25

1. No light on the button.

- The machine has turned "OFF" automatically; push the button to turn the machine "ON".
- Check the mains, voltage, and fuse.

2. No coffee.

- Check that the light on the button is GREEN.
- Check that the water tank is filled and is well positioned.
- Check that a fresh capsule is inserted in correct position, that the machine head is closed and push the button to start.
- Descale if necessary.
- Open the machine head and let the capsule be ejected. Then perform a cleaning as per cleaning section.

3. Coffee is not hot enough.

- Preheat cup with hot drinking water from the tap.
- Descale if necessary.

4. Unusual coffee flow.

- Check that the water tank is well positioned.
- Open the machine head and let the capsule be ejected. Then perform a cleaning as per cleaning section.
- Descale if necessary.

5. Water leakage.

- Check that the water tank is well positioned.
- Empty and clean the capsule container.
- If problem persists, call the *Nespresso Club*.

6. Capsule is not ejecting correctly.

- Open the machine head. Remove the power cord from the grid. Clean the metallic clamps with precaution. Be careful of the sharp edges in the machine head.
- If problem persists, call the *Nespresso Club*.

7. Coffee leakage.

- Open the machine head and let the capsule be ejected. Then perform a cleaning.
- Empty and clean the cup support.
- Descale if necessary.
- If problem persists, call the *Nespresso Club*.

8. Machine turns to "OFF" mode.

- To save energy the machine will turn off after 9 minutes of non-use.
- See paragraph on "Energy Saving Concept".

9. Coffee grounds in the cup.

- Start the cleaning procedure. See paragraph on "Cleaning".

GREEN LIGHT

10. The machine does not start and has GREEN steady lights.

- Check the machine head is properly closed.
- If you want to brew a Alto, Mug, Gran Lungo or Espresso, check that a fresh capsule is inserted in correct position, that the machine head is properly closed and push the button to start.



11. GREEN light blinking continuously and machine not running.









- The machine is heating up and it will take maximum one minute to be ready.



12. GREEN light turning while machine is running.

- This indicates the machine is working properly.

RED LIGHT

-  **13.** Half GREEN and Half RED steady light. → Descaling needed: Machine can be operated when alert appears only a few times after this alert before descaling becomes necessary.
→ See paragraph on "Descaling".
-  **14.** RED light blinking continuously and the machine head stops moving. → Remove any obstacle, empty the capsule container if necessary, and then open or close the machine head depending on position.
-  **15.** The machine does not start and RED light blinking 2 times and goes back to Steady GREEN. → Fill the water tank and push button to start.
→ Open the machine head to eject capsule.
→ Check that a fresh capsule is inserted in correct position, that the machine head is closed and push the button to start.
-  **16.** The machine does not start and RED light blinking 3 times every 2 seconds and goes back to Steady RED. → Press the lever up and wait until the machine head stops, release any obstacle if applicable, empty the capsule container if necessary, and then press the lever down to close the machine head.
-  **17.** RED steady light and the machine is NOT running. → Turn the machine OFF, unplug the power cord, wait for 15 minutes for the machine to cool down.
→ Plug the power cord and turn the machine ON by pressing the lever down. Machine is heating up and will go to steady GREEN when ready.
→ If problem persists, call the Nespresso Club.
-  **18.** RED light fading out. → Machine is cooling down and will go to steady green when ready.
-  **19.** RED light flashing twice and goes back to ORANGE blinking. → Special function running; open the machine head and let the capsule be ejected. Then restart the function by pressing the button.
→ If in the "Emptying the system" mode, remove the water tank.
-  **20.** RED light flashing twice and goes back to steady ORANGE. → Special Functions menu: Choose desired special function by pressing lever down.

ORANGE LIGHT

- 21.** ORANGE light blinking continuously. → Special function is running.
→ Refer to applicable section; Descaling/ Cleaning/ Emptying the system/ Reset to factory settings.
- 22.** Flashing ORANGE lights. → Special function is in selection mode. Refer to applicable paragraph; Descaling/ Cleaning/ Emptying the system/ Reset to factory settings.

CONTACT THE *NESPRESSO* CLUB

Should you need any additional information, in case of problems or simply to seek advice, call the *Nespresso* Club. Contact details for your nearest *Nespresso* Club can be found in the welcome material in your machine box or at nespresso.com

DISPOSAL AND ENVIRONMENTAL PROTECTION

This appliance complies also with the Directive 2012/19/EU. Packaging materials and appliance contain recyclable materials. Your appliance contains valuable materials that can be recovered or can be recycled. Separation of the remaining waste materials into different types facilitates the recycling of valuable raw materials. Leave the appliance at a collection point. You can obtain information on disposal from your local authorities. To know more about *Nespresso* sustainability strategy, go to www.nespresso.com/positive

LIMITED GUARANTEE

Krups guarantees this product against defects in materials and workmanship for a period of two years from the date of purchase. During this period, Krups will either repair or replace, at its discretion, any defective product at no charge to the owner. Replacement products or repaired parts will be guaranteed for only the unexpired portion of the original guarantee or six months, whichever is greater. This limited guarantee does not apply to any defect resulting from accident, misuse, improper maintenance, or normal wear and tear. Except to the extent allowed by applicable law, the terms of this limited guarantee do not exclude, restrict or modify, and are in addition to, the mandatory statutory rights applicable to the sale of the product to you. If you believe your product is defective, contact Krups for instructions on where to send or bring it for repair.

8020000035

Version 1 - Released on 2017.05

www.nespresso.com