

Serie | 8, Washing machine, front loader, 10 kg, 1600 rpm
WAX32GH4GB

A+++



Optional accessories

- WMZ2200 : Floor securing component
- WMZ2381 : Extension for cold water inlet /Aquastop

The ultimate washing machine with Home Connect, AntiStain Plus System and 4D Wash System with Intensive Plus provides spotless results with every load in the smartest way.

- **Home Connect:** home appliances with smart connectivity for an easier everyday life.
- **AntiStain:** detects and removes the 16 most common stains.
- **EcoSilence Drive™:** extremely energy-efficient and quiet in operation with a 10-year warranty.
- **SpeedPerfect:** perfectly clean in up to 65% less time.
- **Intensive Plus:** for extra cleaning boost for heavily soiled and full loads.

Technical Data

Construction type :	Free-standing
Height of removable worktop (mm) :	850
Dimensions of the product (mm) :	848 x 598 x 590
Net weight (kg) :	82.958
Connection rating (W) :	2300
Current (A) :	10
Voltage (V) :	220-240
Frequency (Hz) :	50
Approval certificates :	CE, VDE
Length of electrical supply cord (cm) :	210
Washing performance class :	A
Door hinge :	Left
Wheels :	No
Power consumption standby/network: Please check the user manual for how to switch off the WiFi module. :	1.5
Time auto-standby/network :	5.0
EAN code :	4242005243259
Capacity cotton (kg) - NEW (2010/30/EC) :	10.0
Energy efficiency rating :	A+++
Energy consumption annual (kWh/annum) - NEW (2010/30/EC) :	167.00
:	0.10
:	0.50
Water consumption annual (l/annum) - NEW (2010/30/EC) :	12100
Spin drying performance class :	A
Maximum spin speed (rpm) - NEW (2010/30/EC) :	1600
Average washing time cotton 40C (partial load) - NEW (2010/30/EC) :	180
Average washing time cotton 60C (full load) (min) - NEW (2010/30/EC) :	285
Average washing time cotton 60C (partial load) - NEW (2010/30/EC) :	255
:	155
Noise level washing (dB(A) re 1 pW) :	47
Noise level spinning (dB(A) re 1 pW) :	72
Installation type :	Free-standing



4 242005 243259

Serie | 8, Washing machine, front loader, 10 kg, 1600 rpm WAX32GH4GB

The ultimate washing machine with Home Connect, AntiStain Plus System and 4D Wash System with Intensive Plus provides spotless results with every load in the smartest way.

Performance

- Energy Efficiency Class:A+++
- Capacity:10 kg
- Maximum spin speed:1600 rpm**
- Aspin class
- Energy consumption :Weighted p.a. E-Consump. EU: 167 kWhkWh per year, based on 220 standard washing cycles
- Energy consumption: standard 60 °C cotton programme0.98 kWhfull load and0.55 kWhpartial load and 40 °C cotton programme0.61 kWhpartial load
- Weighted power consumption off-mode / left-on mode:0.1 W/0.5 W
- Water consumption12100litres per year, based on 220 standard washing cycles
- Cottons 60 Eco and Cottons 40 Eco are the standard washing programmes to which the information in the label relates. These programmes are suitable to clean normally soiled cotton laundry and are the most efficient programmes in terms of combined energy and water consumption.
- Programme time:60 °C cotton programme285 minat full load255 minat partial load and 40 °C cotton programme180 minpartial load
- Left-on Mode Duration: 155 min
- Drum volume: 70 litres
- Noise level washing :47dB (A) re 1pW: Noise level spinning:72dB (A) re 1 pW

Programmes/functions

- Touch control buttons:Prog 3 sec.,On/off,Ready in,stain selection,Intensive Plus,options,Remote Start,start/pause

with reload function,Temperature selection,SpeedPerfect,Spin speed reduction/Rinse Hold

- options:1 - 3 additional rinse cycles,Easy iron,Soaking,AntiStain +,Intensive Plus,Night Wash,SpeedPerfect,Rinse hold,Prewash,Water plus
- Standard programmes: cottons, easy care, delicates, wool hand wash
- Special programmes:Allergy +,Drain,Drum clean with reminder,Towels,Shirts,Quiet Wash,Dark Wash,Spin,Mixed Load,Sportswear,Single Rinse,Super Quick 15/30
- Safeguard monitoring system adjusts load distribution and programme settings to protect clothes
- Automatic load detection for precise detection of loaded laundry to adjust automatically the amount of water is needed in every wash.

Key features

- 4D Wash System: highly efficient water and detergent fabric penetration for spotless results.
- Home Connect: Remote Monitoring and Control, Energy Management
- AutoStain Removal Systemwith 16 stain options
- Reload function: Flexibility in adding laundry items into the drum, even after the wash cycle has started.
- EcoSilence drive with 10 year warranty
- ActiveWater: water management system
- AntiVibration Design - for more stability and quietness
- EcoBar Plus function: five possible levels of energy and water consumption

Additional features

- TFT display: Clear text and high resolution for easy use with display of programme indication, temperature selection, spin speed, remaining time,24 hour time delay and consumption indication
- MetalControl dial with integrated On / Off mode
- WaveDrum: gentle and efficient washing
- Drum interior light
- Drum clean with reminderfunction
- Sound insulation by additional noise reduction material
- Consump indicator energy+water,Load scale and detergent dosage recommendation,AutoStain Removal System
- Multiple Water Protection
- Foam detection system
- Overdosage indication
- Child lock
- Multi-tone acoustic signal to indicate end of cycle

Technical Information

- Slide-under installation
- Large chrome, white door with 180° opening and 32cm porthole opening
- Dimensions (H x W): 84.8 cm x 59.8 cm
- Appliance depth: 59.0 cm
- Appliance depth incl. door: 63.2 cm
- Appliance depth with open door: 108.5 cm

**** Values are rounded.**

**Serie | 8, Washing machine, front loader, 10
kg, 1600 rpm
WAX32GH4GB**

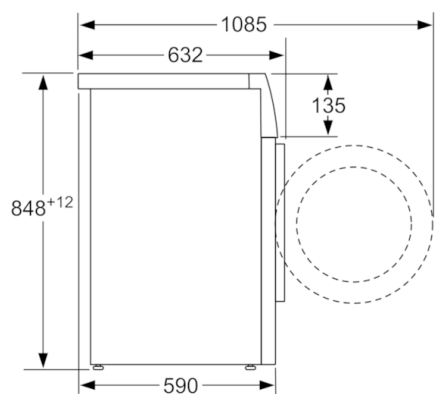

measurements in mm

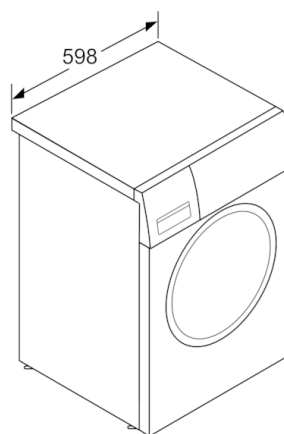

measurements in mm