



DW50K4050BB
DW50K4030BB
DW50K4030FS
DW50K4030FW
DW50K4010BB

Dishwasher

user manual

imagine the possibilities

Thank you for purchasing this Samsung product.



SAMSUNG

Contents

SAFETY INFORMATION	3	5 Hydrogen gas is explosive
		5 Proper use
		6 Disposal
		6 Instruction about the WEEE mark
OPERATION INSTRUCTION	7	7 Control panel
		10 Displays
		12 Dishwasher features
PRIOR USING FOR THE FIRST TIME	13	13 Set the water softener
		14 Loading the salt into the softener
		15 Fill the rinse aid dispenser
		15 Rinse aid dispenser
		16 Function of detergent
LOADING THE DISHWASHER RACKS	19	19 Loading the upper basket
		20 Loading the lower basket
		21 Cutlery basket and fork shelf
		22 For washing in the dishwasher the following cutlery/dishes
STARTING A WASHING PROGRAMME	24	24 Wash cycle table
		26 Turning on the appliance
		27 Change the programme
		27 Forget to add dish
		27 Unloading the dishwasher
MAINTENANCE AND CLEANING	28	28 Filtering system
		28 Filter assembly
		29 Cleaning the spray arms
		29 Caring for the dishwasher
		29 Protect against freezing
		29 Cleaning the door
		30 How to keep your dishwasher in shape
INSTALLATION INSTRUCTION	31	31 Positioning and leveling
		31 Connecting the water and electricity supplies
		34 Built-in dishwasher
		39 Start of dishwasher
TROUBLESHOOTING TIPS	40	40 Error codes
		41 Before calling for service
APPENDIX	43	43 Specifications
		43 Product dimension

Safety information

Please read this User Information carefully and keep it to refer to at a later date. Pass it on to any subsequent owner of the appliance.

This manual contains sections of Safety Instructions, Part and Features, Installation your dishwasher and Troubleshooting etc.

Carefully reading it before using the dishwasher will help you to use and maintain the dishwasher properly.



The manufacturer, following a policy of constant development and up-dating of the product, may make modifications without giving prior notice.



WARNING: When using your dishwasher, follow the below basic precautions including the following:

1. This appliance is not to be used by persons (including children) with reduced physical, sensory or mental capabilities, or lack of experience and knowledge, unless they have been given supervision or instruction concerning use of the appliance by a person responsible for their safety.
2. **For use in Europe:** This appliance can be used by children aged from 8 years and above and persons with reduced physical, sensory or mental capabilities or lack of experience and knowledge if they have been given supervision or instruction concerning use of the appliance in a safe way and understand the hazards involved. Children shall not play with the appliance. Cleaning and user maintenance shall not be made by children without supervision.
3. Children should be supervised to ensure that they do not play with the appliance.
4. If the supply cord is damaged, it must be replaced by the manufacturer, its service agent or similarly qualified persons in order to avoid a hazard.

**READ AND FOLLOW THIS SAFETY INFORMATION
CAREFULLY SAVE THESE INSTRUCTIONS**

Safety information

5. The new hose-sets supplied with the appliance are to be used and that old hose-sets should not be reused.
6. For appliances with ventilation openings in the base, that a carpet must not obstruct the openings.
7. **For use in Europe:** Children of less than 3 years should be kept away unless continuously supervised.
8. **CAUTION:** In order to avoid a hazard due to inadvertent resetting of the thermal cut-out, this appliance must not be supplied through an external switching device, such as a timer, or connected to a circuit that is regularly switched on and off by the utility.
9. This appliance is intended to be used in household and similar applications such as:
 - staff kitchen areas in shops, offices and other working environments;
 - farm houses;
 - by clients in hotels, motels and other residential type environments;
 - bed and breakfast type environments.
10. The door should not be left in the open position since this could present a tripping hazard.
11. **WARNING:** Knives and other utensils with sharp points must be loaded in the basket with their points down or placed in a horizontal position.
12. Please do not overload your dishwasher. There is only space for 9 standard dishes. Do not use dish that is not suitable for dishwashers. This is important for good results and for reasonable energy consumption.

**READ AND FOLLOW THIS SAFETY INFORMATION
CAREFULLY SAVE THESE INSTRUCTIONS**

Hydrogen gas is explosive

Under certain conditions, Hydrogen gas may be produced in a hot-water system that has not been used for two weeks or more. HYDROGEN GAS IS EXPLOSIVE. If the hot-water system has not been used for such a period, before using the dishwasher turn on all hot-water faucets and let the water flow from each for several minutes. This will release any accumulated hydrogen gas. As the gas is flammable, do not smoke or use an open flame during this time.

Proper use

- Do not abuse, sit on, or stand on the door or dish rack of the dishwasher.
- Do not operate your dishwasher unless all enclosure panels are properly in place. Open the door very carefully if the dishwasher is operating. There is a risk of water squirting out.
- Do not place any heavy objects of stand on the door when it is open. The appliance could tip forward.
- When loading items to be washed:
 - Locate sharp items so that they are not likely to damage the door seal;
 - Load sharp knives with the handles up to reduce the risk of cut-type injuries;
- Warning : knives and other utensils with sharp points must be loaded in the basket with their points down or placed in a horizontal position.
- Check that the detergent receptacle is empty after completion of the wash cycle.
- Do not wash plastic items unless they are marked dishwasher safe or the equivalent. For plastic items not so marked, check the manufacturer's recommendations.
- Use only detergent and rinse additives designed for an automatic dishwasher. Never use soap, laundry detergent, or hand washing detergent in your dishwasher.
- Other means for disconnection from the supply must be incorporated in the fixed wiring with at least 3 mm contact separation in all poles.
- Keep children away from detergent and rinse aid, keep children away from the open door of the dishwasher, there could still be some detergent left inside.
- Young children should be supervised to ensure that they do not play with the appliance.
- The appliance is not intended for use by young children or infirm persons without supervision.
- Dishwasher detergents are strongly alkaline. They can be extremely dangerous if swallowed. Avoid contact with skin and eyes and keep children away from the dishwasher when the door is open.
- The door should not be left in the open position since this could present a tripping hazard.
- If the supply cord is damaged, it must be replaced by the manufacturer or its service agent or a similarly qualified person in order to avoid a hazard.
- Please dispose of packing materials properly.
- Use the dishwasher only for its intended function.
- During installation, the power supply must not be excessively or dangerously bent or flattened.
- Do not tamper with controls.
- The appliance is to be connected to the water mains using new hose sets and the old hose-sets should not be reused.

**READ AND FOLLOW THIS SAFETY INFORMATION
CAREFULLY SAVE THESE INSTRUCTIONS**

Safety information

Disposal

Dispose of the dishwasher packaging material correctly.

All packaging materials can be recycled.

Plastic parts are marked with the standard international abbreviations:

- PE** for polyethylene, e.g. sheet wrapping material
- PS** for polystyrene, e.g. padding material
- POM** polyoxymethylene, e.g. plastic clips
- PP** polypropylene, e.g. Salt filler
- ABS** Acrylonitrile Butadiene Styrene, e.g. Control Panel.



WARNING: Packaging material could be dangerous for children!

For disposing of package and the appliance please go to a recycling centre. Therefore cut off the power supply cable and make the door closing device unusable.

Cardboard packaging is manufactured from recycled paper and should be disposed in the waste paper collection for recycling.

By ensuring this product is disposed of correctly, you will help prevent potential negative consequences for the environment and human health, which could otherwise be caused by inappropriate waste handling of this product.

For more detailed information about recycling of this product, please contact your local city office and your household waste disposal service.

Instruction about the WEEE mark



Correct Disposal of This Product (Waste Electrical & Electronic Equipment)

(Applicable in countries with separate collection systems)

This marking on the product, accessories or literature indicates that the product and its electronic accessories (e.g. charger, headset, USB cable) should not be disposed of with other household waste at the end of their working life. To prevent possible harm to the environment or human health from uncontrolled waste disposal, please separate these items from other types of waste and recycle them responsibly to promote the sustainable reuse of material resources.

Household users should contact either the retailer where they purchased this product, or their local government office, for details of where and how they can take these items for environmentally safe recycling.

Business users should contact their supplier and check the terms and conditions of the purchase contract. This product and its electronic accessories should not be mixed with other commercial wastes for disposal.

For information on Samsung's environmental commitments and product specific regulatory obligations e.g. REACH visit: samsung.com/uk/aboutsamsung/samsungelectronics/corporatecitizenship/data_corner.html

**READ AND FOLLOW THIS SAFETY INFORMATION
CAREFULLY SAVE THESE INSTRUCTIONS**

Operation instruction

Control panel

DW50K4030FS/FW



1 POWER	Press this button to turn on your dishwasher : the screen lights up.
2 Program	To select washing program press this button.
3 Half load	To select Half load function. (With this Half load function you can only use it when you have only about or less than 5 place setting dishware, and you will see less water and energy consumption. It can only be used with all program except Pre Wash.)
4 Delay start	Press this button to set the delayed hours for washing. You can delay the start of washing up to 24 hours. One press on this button delays the start of washing by one hours.
5 Display	Running indicator, delay time, error codes and etc.
6 Rinse Add	To select Rinse Add function, you can use it when you want to add once rinse after the program. It can be used with all program except Pre Wash.
7 Hygiene	Push the Hygiene button for the best possible hygiene in your dishwasher. At the final rinse it heat up to 67 °C and hold this temperature for a several minutes. This function is available with all program except Pre Wash.
8 Multi tab (Control lock)	To select Multi in 1 option which needs salt and rinse aid but a Multi in 1 tablet. This option can be used with all program except Pre Wash. Another option allows you to lock the buttons on the control panel so children cannot accidentally start the dishwasher by pressing the buttons on the panel. To lock and unlock the buttons on the control panel, hold down both the Multi in 1 button for (3) seconds.
9 START (Reset)	In power on condition, close the dishwasher door and select the cycle and desired options. Press the START button to begin the cycle. When you want to pause the dishwasher while running, press the START button and make sure to open the door slowly and carefully. You can reset the machine by pressing the START button for 3 seconds during washing. After reset, the dishwasher goes to the initial state except salt consumption setting of water softener.

- When the door is open only the **POWER** button will operate.
- You can select options (**Multi in 1**, **Delay start**, **Half load**, **Hygiene** and **Rinse Add**) before starting a cycle.

Operation instruction

DW50K4050BB

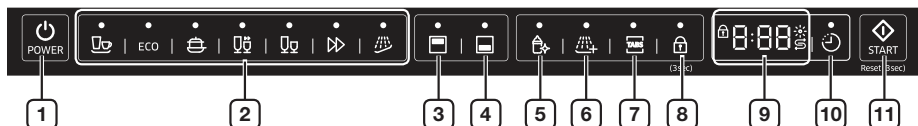





DW50K4030BB



DW50K4010BB



1 POWER	Press this button to turn on your dishwasher : the screen lights up.
2 Cycle	To select washing program press this button.
3 Upper	<p>When you select Upper, only the upper rack nozzle is activated. The lower nozzle will not operate. Use this feature to wash a small load of dishes or glasses placed in the upper rack.</p> <p> When you select Upper, place dishes, glasses, etc. in the upper rack only. The dishwasher will not wash items placed in the lower rack.</p> <p>Selecting Upper reduces both the cycle time and the amount of electricity consumed.</p>
4 Lower	<p>When you select Lower, only the lower rack nozzle is activated. The upper nozzle will not operate. Use this feature to wash a small load of dishes or glasses placed in the lower rack.</p> <p> When you select Lower, place items, glasses, etc. in the lower rack only. The dishwasher will not wash items placed in the upper rack.</p> <p>Selecting Lower reduces both the cycle time and the amount of electricity consumed.</p>
5 Hygiene	Push the Hygiene button for the best possible hygiene in your dishwasher. At the final rinse it heat up to 67 °C and hold this temperature for a several minutes. This function is available with all program except Pre Wash.
6 Rinse Add	To select Rinse Add function, you can use it when you want to add once rinse after the program. It can be used with all program except Pre Wash.
7 Multi tab	To select Multi in 1 option which needs salt and rinse aid but a Multi in 1 tablet. This option can be used with all program except Pre Wash.
8 Control lock	Control lock option allows you to lock the buttons on the control panel so children cannot accidentally start the dishwasher by pressing the buttons on the panel.

9 Indicator	<p>If Rinse Refill or Salt Refill indicator is lit, it means rinse or salt is needed to refill.</p> <p> Salt Refill Indicator</p> <ul style="list-style-type: none"> If the “Salt Refill” indicator is lit, it means the dishwasher is low on dishwasher salt and needs to be refilled. <p> Rinse Refill Indicator</p> <ul style="list-style-type: none"> If the “Rinse Refill” indicator is lit, it means the dishwasher is low on dishwasher rinse aid and requires a refill. <p> Control lock Indicator</p> <ul style="list-style-type: none"> If the “Control lock” indicator is lit, it means the dishwasher is locked, you cannot do any operate.
10 Delay start	<p>Press this button to set the delayed hours for washing. You can delay the start of washing up to 24 hours. One press on this button delays the start of washing by one hours.</p>
11 START (Reset)	<p>In power on condition, close the dishwasher door and select the cycle and desired options. Press the START button to begin the cycle.</p> <p>When you want to pause the dishwasher while running, press the START button and make sure to open the door slowly and carefully.</p> <p>You can reset the machine by pressing the START button for 3 seconds during washing. After reset, the dishwasher goes to the initial state except salt consumption setting of water softener.</p>









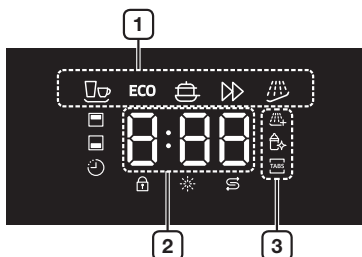

- When the door is closed only the **POWER** button will operate.
- You can select options (**Multi tab**, **Half load**, **Delay**, **Hygiene** and **Rinse Add**) before starting a cycle.

Operation instruction

Displays

DW50K4030FW/FS



1	PROGRAM ICONS	When press the Program button, each program is selected.
	Normal	For normally soiled loads, such as pots, plates, glasses, and lightly soiled pans. Standard daily cycle.
ECO	Eco	Normally soiled daily using items, with reduced energy and water consumptions.
	Intensive	Heavily soiled items include pots and pans.
	Express	Normally soiled daily using items, with short cycle time.
	Pre Wash	Cold rinse for remove only dirt on dishes stored for a long time or soaking dishes which are dried up before other programme running.
2	3*8 SEGMENT	Display the remaining time, error code, or delay time.
3	REFILL INDICATORS	If Rinse Refill or Salt Refill indicator is lit, it means rinse or salt is needed to refill.
	Rinse Add	To select Rinse Add function, you can use it when you want to add once rinse after the program. It can be used with all program except Pre Wash.
	Hygiene	Push the Hygiene button for the best possible hygiene in your dishwasher. At the final rinse it heat up to 67 °C and hold this temperature for a several minutes. This function is available with all program except Pre Wash.
	Multi tab (Control lock)	To select Multi in 1 option which needs salt and rinse aid but a Multi in 1 tablet. This option can be used with all program except Pre Wash. Another option allows you to lock the buttons on the control panel so children cannot accidentally start the dishwasher by pressing the buttons on the panel. To lock and unlock the buttons on the control panel, hold down both the Multi in 1 button for (3) seconds.

DW50K4050BB

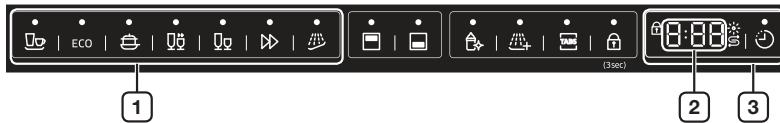

DW50K4030BB



DW50K4010BB



1	PROGRAM ICONS	When press the Program button, each program is selected.
	Normal	For normally soiled loads, such as pots, plates, glasses, and lightly soiled pans. Standard daily cycle.
ECO	Eco	Normally soiled daily using items, with reduced energy and water consumptions.
	Intensive (DW50K4050BB/ DW50K4030BB)	Heavily soiled items include pots and pans.
	Quick Wash (DW50K4050BB)	Lightly soiled with very short cycle time.
	Delicate (DW50K4050BB)	Lightly soiled delicate items.
	Express	Normally soiled daily using items, with short cycle time.
	Pre Wash (DW50K4050BB/ DW50K4030BB)	Cold rinse for remove only dirt on dishes stored for a long time or soaking dishes which are dried up before other programme running.
2	3*8 SEGMENT	Display the remaining time, error code, or delay time.
3	REFILL INDICATORS	If Rinse Refill or Salt Refill indicator is lit, it means rinse or salt is needed to refill.
	SALT REFILL INDICATOR	If the "Salt Refill" indicator is lit, it means the dishwasher is low on dishwasher salt and needs to be refilled.
	RINSE REFILL INDICATOR	If the "Rinse Refill" indicator is lit, it means the dishwasher is low on dishwasher rinse aid and requires a refill.
	CONTROL LOCK INDICATOR	If the "Control lock" indicator id fit, it means the dishwasher is locked, you cannot do any operate.
	DELAY START INDICATOR	If the "Deley Start" indicator is fit, it means the dishwasher start woll delay several hours which you setup.

Operation instruction

Dishwasher features

Front & Rear View

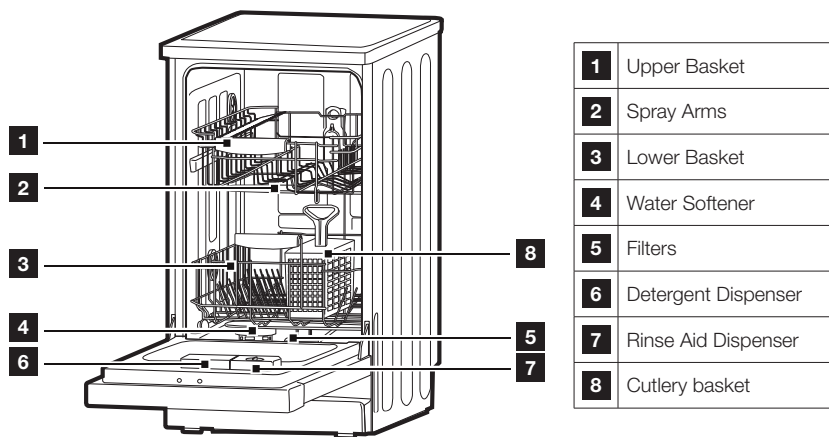

Prior using for the first time

Before using your dishwasher for the first time:

- A. Set the water softener
- B. Loading the salt into the softener
- C. Fill the rinse aid dispenser
- D. Fill in detergent

Set the water softener

The water softener is designed to remove minerals and salts from the water, which would have a detrimental or adverse effect on the operation of the appliance. The higher the content of these minerals and salts, the harder the water is. The softener should be adjusted according to the hardness of the water in your area. Your local Water Authority can advise you on the hardness of the water in your area.

Setting

The amount of salt dispensed can be set from H0 to H7.

Salt is not required at the set value H0.

1. Find out about the hardness value of your tap water. Your water utility company will help you with this.
2. Set value can be found in the water hardness table.
3. Close the door.
4. Switch on "Power" switch.
5. Hold down "Delay" button and then press "Program" button (for freestanding dishwasher) or "Start" button (for full built-in dishwasher) for 5 seconds. The buzzer rings one time and H. flashes on the digital display. (factory setting is H4)

To change the setting:

1. Press "Delay" button.
Each time the button is pressed, the set value increases by one level; when the value of H7 has been reached, the display jumps back to H0 (off).
2. Press "Program" or "Start" button. The chosen setting has now been stored.

Contact your local water board for information on the hardness of your water supply.

Water hardness table

WATER HARDNESS		mmol/l	Set value on the machine
°Clark	Range		
0-8	soft	0-1.1	H0
9-10	soft	1.2-1.4	H1
11-12	medium	1.5-1.8	H2
13-15	medium	1.9-2.1	H3
16-20	medium	2.2-2.9	H4
21-26	hard	3.0-3.7	H5
27-38	hard	3.8-5.4	H6
39-62	hard	5.5-8.9	H7

Prior using for the first time

Loading the salt into the softener

Always use salt intended for use with dishwasher.

 If your model has no water softener, you may skip this section

WATER SOFTENER

The hardness of the water varies from place to place. If hard water is used in the dishwasher, deposits will form on the dishes and utensils.

The appliance is equipped with a special softener that uses salts specifically designed to eliminate lime and minerals from the water.

The salt container is located beneath the lower basket and should be filled as follows:

-  **CAUTION:** Only use salt specifically designed for use in dishwashers! All other types of salt not specifically designed for use in a dishwasher, especially table salt, will damage the water softener. In case of damages caused by the use of unsuitable salt the manufacturer does not give any warranty nor is liable for any caused damages.
- Only fill with salt just before starting one of the complete washing programmes.
- This will prevent any grains of salt or salty water, which may have been split, remaining on the bottom of the machine for any period of time, which may cause corrosion.
- After the first wash cycle the control panel light expires.

1. Remove the lower basket and then unscrew and remove the cap from the salt container.

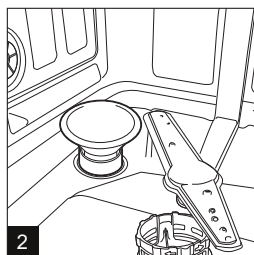
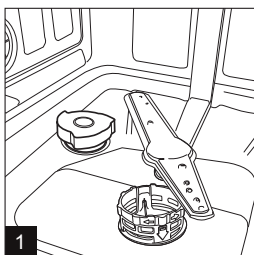

2. If you are filling the container for the first time, fill 2/3 of its volume with water (around 500ml).
3. Place the end of the funnel (supplied) into the hole and introduce about 1.2kg of salt. It is normal for a small amount of water to come out of the salt container.
4. Carefully screw the cap back on.
5. Usually, the salt warning light will be off in 2-6 days after the salt container is filled with salt.

-  • The salt container must be refilled when the salt warning light in the control panel comes on. Though the salt container is filled enough, the indicator light may not black out before the salt fully dissolve. If there is no salt warning light in the control panel (for some models), you can judge when to load the salt into the softener by the cycles that the dishwasher had run (see the following schema).
- If there are spills of the salt, a soak program could be run to wipe them out.

Fill the rinse aid dispenser

Function of rinse aid

Rinse aid is automatically added during the last rinse, ensuring thorough rinsing, spot and streak free drying.

CAUTION: Only use branded rinse aid for dishwasher. Never fill the rinse aid dispenser with any other substances (e.g. dishwasher cleaning agent, liquid detergent). This would damage the appliance.

When to Refill the Rinse Aid Dispenser

If there is no rinse-aid warning light on the control panel, you can judge the amount of rinse-aid by the color of the optical level indicator "D" located next to the cap. When the rinse-aid container is full, the whole indicator will be dark. As the rinse aid diminishes, the size of the dark dot decreases. You should never let the rinse aid get below 1/4 full.

As the rinse aid diminishes, the size of the black dot on the rinse aid level indicator changes, as illustrated below.

- Full
- ◐ 3/4 full
- ◑ 1/2 full
- 1/4 full : Should refill to eliminate spotting
- Empty

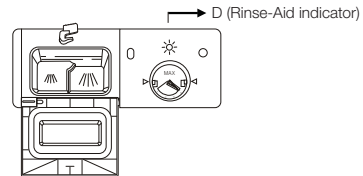

Rinse aid dispenser

1. To open the dispenser, turn the cap to the "open" (left) arrow and lift it out.

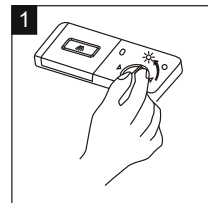

2. Pour the rinse aid into the dispenser, be careful not to overfill.

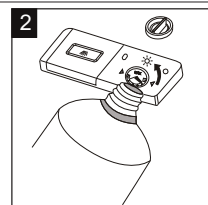

3. Replace the cap by inserting it aligned with "open" arrow and turning it to the "closed" (right) arrow.

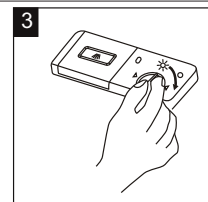

Prior using for the first time

The rinse aid is released during the final rinse to prevent water from forming droplets on your dishes that can leave spots and streaks. It also improves drying by allowing water to sheet off the dishes. Your dishwashers are designed to use liquid rinse aids. The rinse aid dispenser is located inside the door next to the detergent dispenser.

To fill the dispenser, open the cap and pour the rinse aid into the dispenser until the level indicator turns completely black. The volume of the rinse aid container is about 140ml.

Be careful not to overfill the dispenser, because this could cause over sudsing. Wipe away any spills with a damp cloth. Don't forget to replace the cap before you close dishwasher door.

CAUTION: Clean up any rinse aid split during filling with an absorbent cloth to avoid excess foaming during the next wash.

Adjusting Rinse Aid Dispenser

Adjust the amount of rinse aid released during the rinse operation.

You can choose one of four levels (1-4). The higher the number, the larger the amount of rinse aid released. The factory default is 4.

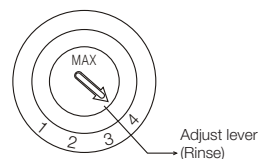

 The use of a rinse aid greatly improves the drying performance after the final rinse.

Function of detergent

Detergents with its chemical ingredients are necessary to remove dirt, crush dirt and transport it out of the dishwasher. Most of commercial quality detergents are suitable for this purpose.

Concentrated detergent

Based on their chemical composition, dishwasher can be split in two basic types:

- conventional, alkaline detergents with caustic components
- low alkaline concentrated detergents with natural enzymes

The use of "normal" washing programmes in conjunction with concentrated detergents reduces pollution and is good for your dishes; these wash programmes are specially matched to the dirt-dissolving properties of the enzymes of the concentrated detergent. For this reason "normal" wash programmes in which concentrated detergents are used can achieve the same results that can otherwise only be achieved using "intensive" programmes.

Detergent tablets

Detergent tablets of different brands dissolve at different speeds. For this reason some detergent cannot dissolve and develop their full cleaning power during short programmes. Therefore please use long programmes when using detergent tablets, to ensure the complete removal of detergent residuals.

Detergent dispenser

The dispenser must be refilled before the start of each washing cycle following the instructions provided in the Wash Cycle Table. Your dishwashers use less detergent and rinse aid than conventional dishwashers. Generally, only one tablespoon of detergent is needed for a normal wash load. Also, more heavily soiled items need more detergent. Always add the detergent just before starting dishwasher, otherwise it could get damp and will not dissolve properly.

Amount of detergent to use

1. If the lid is closed: press release button. The lid springs open.
2. Always add the detergent just before starting each wash cycle. Only use branded detergent aid for dishwasher.

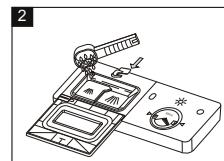
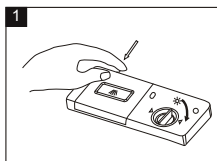

⚠ WARNING: When using your dishwasher, follow the basic precautions including the following:

Use only detergent specifically made for use in dishwashers. Keep your detergent fresh and dry. Don't put powder detergent into the dispenser until you're ready to wash dishes.

Fill in the detergent

Fill the detergent dispenser with detergent. The marking indicates the dosing levels, as illustrated on the right:

1. The place of main wash cycle detergent placed, which has dosing level in the interior of it.
2. The place of pre-wash cycle detergent placed, cover of the dispenser after closed dispenser door, approximately 5 g of detergent.

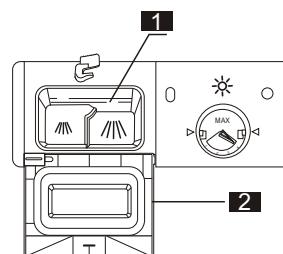

Please observe the manufacturer's dosing and storage recommendations as stated on the detergent packaging.

Close the lid and press until it locks in place.

If the dishes are heavily soiled, place an additional detergent dose in the pre-wash detergent Chamber. This detergent will take effect during the pre-wash phase.

-  You find information about the amount of detergent for the single programme on the last page. Please be aware that according to the level soiling and the specific hardness of water, differences are possible. Please observe the manufacturer's recommendations on the detergent packaging.

Prior using for the first time

Use of Multi in 1 Detergent Tablets

General Advice

1. Before using these products you should first check that the water hard-ness in your supply is compatible with the use of these products as per the detergent manufacturers instructions (on the product packaging).
2. These products should be strictly used according to the detergent manufacturers instructions.
3. If you encounter problems when using "Multi in 1" products for the first time then please contact the detergent manufacturers care line (the telephone number is given on the product packaging). These products are detergents with integrated and combined detergent/rinse aid and salt functions. Before using these products you should first check that the water hardness in your supply is compatible with the use of these products as per the detergent manufacturers (on the product packaging).

Special Advice

When using combination products, the rinse-aid and salt lights are no longer useful. It may be helpful to select the lowest possible setting for water hardness.

To select "Multi in 1" function:

1. Press the power switch and select the Multi in 1 washing cycle by pressing the button "Multi tab" until the "Multi in 1" indicator blinks.
2. The Multi in 1 washing cycle will be available after pressing the start/pause button, and the "Multi in 1" indicator lights.

To cancel "Multi in 1" function:

To cancel "Multi in 1" function by pressing the "Multi tab" button or follow the "Cancelling a programme in progress" instruction.

If you decide to switch to the use of a standard detergent system we advise that you:

1. Refill both the salt and rinse aid compartments.
2. Switch the water hardness setting to the highest possible position and run for three normal cycles without load.
3. Readjust the water hardness setting again according to the conditions for your region (For more information please refer to your instruction manual).



Multi in 1 washing cycle is additional function, they must be used with other programme (Intensive, Eco and Light).

Loading the dishwasher racks

For best performance of the dishwasher, follow these loading guidelines. Features and appearance of baskets and silverware baskets may vary from your model.

Attention before or after Loading the Dishwasher Baskets

Scrape off any large amounts of leftover food. It is not necessary to rinse the dishes under running water. Place objects in the dishwasher in the following way:

1. Items such as cups, glasses, pots/pans, etc. are stood upside down.
2. Curve items, or those with recesses, should be at a slant so that water can run off.
3. They are stacked securely and can not tip over.
4. They do not prevent the spray arms from rotating while washing takes place.

Very small items should not be washed in the dishwasher as they could easily fall out of the baskets.

Removing the Dishes

To prevent water dripping from the upper basket into the lower basket, we recommend that you empty the lower basket first and then the upper basket.

Loading the upper basket

The upper basket is designed to hold more delicate and lighter dishware such as glasses, coffee and tea cup and saucers, as well as plates, small bowls and shallow pans (as long as they are not too dirty). Position the dishes and cookware so that they do not get moved by the spray of water.

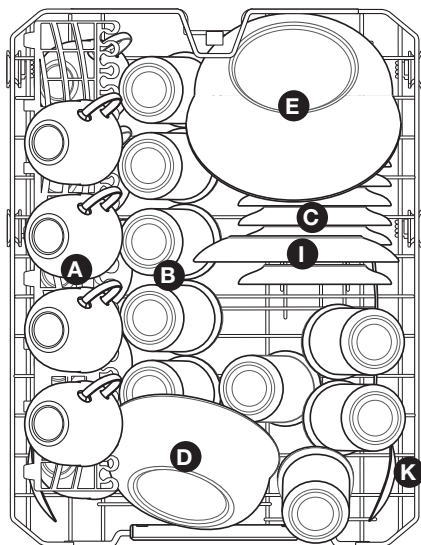

Upper basket	
Type	Item
A	Cup
B	Glass
C	Saucer
D	Serving bowl
E	Serving bowl
I	Dessert plate
K	Serving spoon

Loading the dishwasher racks

Adjusting the upper basket

If required, the height of the upper basket can be adjusted in order to create more space for large utensils either in the upper basket or lower basket. The upper basket can be adjusted for height by putting wheels of different height into the rails. Long items, serving cutlery, salad servers or knives should be placed on the shelf so that they do not obstruct the rotation of the spray arms. The shelf can be folded back or removed when not be required for use.

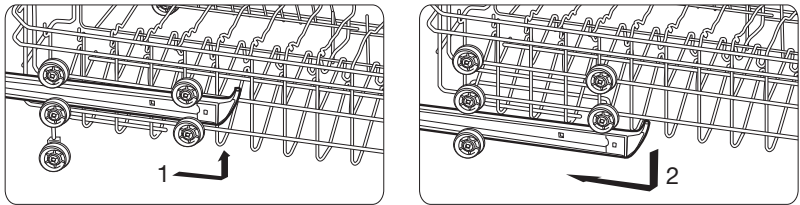

Loading the lower basket

We recommend that you place large items which are most difficult to clean in to the lower basket: pots, pans, lids, serving dishes and bowls, as shown in the figure below.

It is preferable to place serving dishes and lids on the side of the baskets in order to avoid blocking the rotation of the top spray arm.

Pots, serving bowls, etc. must always be placed top down.

Deep pots should be slanted to allow water to flow out.

The bottom basket features fold down tine rows so that larger or more pots and pans can be loaded.

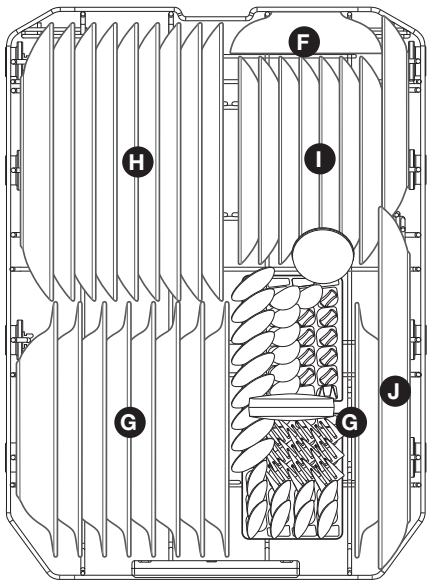

Lower basket	
Type	Item
F	Serving bowl
G	Soup plate
H	Dinner plate
I	Dessert plate
J	Oval plate

Upper and lower basket folding racks

Folding racks consisting of two parts that are located on the lower basket of your machine are designed in order to let you place big items easier as pots, pans, etc. If requested, each part can be folded separately, or all of them can be folded and larger can be obtained. You can use folding racks by raising then upwards, or by folding.

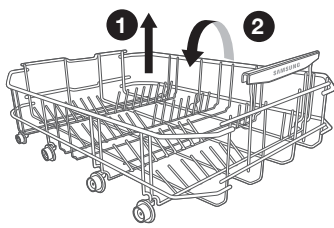

Lower Basket

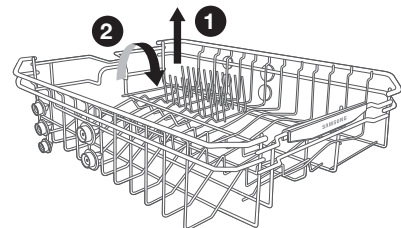

Upper Basket 2

Cutlery basket and fork shelf

Cutlery should be placed in the cutlery basket with handles at the bottom: If the basket has side baskets, the spoon should be loaded individually into the appropriate slots, especially long utensils should be placed in the horizontal position at the front of the upper basket.

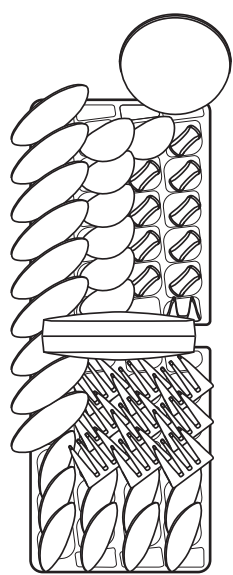

Door side

IN
↑

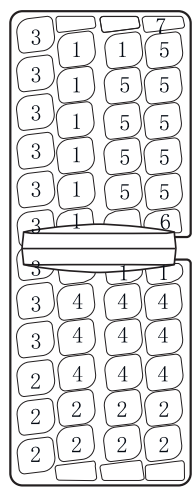

Door side





Cutlery basket	
Type	Item
1	Tea spoons
2	Dessert spoons
3	Soup spoons
4	Forks
5	Knives
6	Serving fork
7	Gravy ladle

Loading the dishwasher racks

For washing in the dishwasher the following cutlery/dishes

Are not suitable	Are of limited suitability
<p>Cutlery with wooden, horn china or mother-of-pearl handles.</p> <p>Plastic items that are not heat resistant</p> <p>Older cutlery with glued parts that is not temperature resistant</p> <p>Bonded cutlery items or dishes</p> <p>Pewter or cooper items</p> <p>Lead crystal glass</p> <p>Steel items subject to rusting</p> <p>Wooden platters Items made from synthetic fibres.</p> <p> WARNING: Do not let any item extend through bottom</p>	<p>Some types of glasses can become dull after a large number of washes.</p> <p>Silver and aluminium parts have a tendency to discolour during washing.</p> <p>Glazed patterns may fade if machine washed frequently.</p>

 Do not put in items that are dirty of cigarette ash, candle wax, lacquer or paint. If you buy new dishes please make sure that they are suitable for dishwashers.

 Please do not overload your dishwasher. There is only space for 9 standard dishes. Do not use dish that is not suitable for dishwashers. This is important for good results and for reasonable energy consumption.

Loading cutlery and dishes

Before loading the dishes, you should:

Remove large left-over

Soften remnants of burnt food in pans.

When loading the dishes and cutlery, please note

Dishes and cutlery must not impede the rotation of the spray arms.

Load hollow items such as cups, glasses, pans etc. with the opening downwards so that water cannot collect in the container or a deep base.

Dishes and items of cutlery must not lie inside one another, or cover each other

 Dishes and items of cutlery must not lie inside one another, or cover each other.

- To avoid damage to glasses, they must not touch.
- Load large items which are most difficult to clean into the lower basket.
- The upper basket is designed to hold more delicate and lighter dishware such as glasses, coffee and tea cups.

ATTENTION

Long bladed knives stored in an upright position are a potential hazard!

Long and/or sharp items of cutlery such as carving knives must be positioned horizontally in the upper basket.

Damage to glassware and other dishes

Possible causes:	Suggested remedy:
<ul style="list-style-type: none"> Type of glass or manufacturing process. Chemical composition of detergent. Water temperature and duration of dishwasher programme. 	<ul style="list-style-type: none"> Use glassware or porcelain dishes that have been marked dishwasher-proof by the manufacturer. Use a mild detergent that is described as kind of dishes. If necessary, seek further information from detergent manufacturers. Select a programme with a low temperature. To prevent damage, take glass and cutlery out of the dishwasher as soon as possible after the programme has ended.

At the end of the wash

When the working cycle has finished, the buzzer of dishwasher will ring for 6 times, then stop. Turn off the appliance using the "Power" button, shut off the water supply and open the door of the dishwasher. Wait a few minutes before unloading the dishwasher to avoid handling the dishes and utensils while they are still hot and more susceptible to breakage. They will also dry better.

Starting a washing programme

Wash cycle table

Program	Description of cycle	Detergent (g) (Pre wash / Main wash)	Running time (min)	Energy (KWh)	Water (L)
Intensive (DW50K4050BB / DW50K4030BB)	Pre Wash 45 °C	5/22	186	1.3	13
	Main Wash 60 °C				
	Rinse				
	Hot Rinse 70 °C				
	Drying				
Intensive + Sanitize (DW50K4050BB / DW50K4030BB)	Pre Wash 45 °C	5/22	186	1.3	13
	Main Wash 60 °C				
	Rinse				
	Hot Rinse 70 °C				
	Drying				
Intensive + Half load (DW50K4050BB / DW50K4030BB)	Pre Wash 45 °C	5/22	186	1.22	13
	Main Wash 60 °C				
	Rinse				
	Hot Rinse 70 °C				
	Drying				
Intensive + Rinse Add (DW50K4050BB / DW50K4030BB)	Pre Wash 45 °C	5/22	217	1.55	15.5
	Main Wash 60 °C				
	Rinse				
	Hot Rinse 70 °C				
	Drying				
Eco	Pre Wash	5/22	195	0.78	10
	Main Wash 44 °C				
	Rinse				
	Hot Rinse 62 °C (DW50K4050BB / DW50K4030BB / DW50K4010BB)				
	Hot Rinse 61 °C (DW50K4030FS / DW50K4030FW)				
	Drying				
Eco + Sanitize	Pre Wash	5/22	199	0.87	10
	Main Wash 44 °C				
	Rinse				
	Hot Rinse 70 °C				
	Drying				
Eco + Half load	Pre Wash	5/22	195	0.71	10
	Main Wash 44 °C				
	Rinse				
	Hot Rinse 62 °C (DW50K4050BB / DW50K4030BB / DW50K4010BB)				
	Hot Rinse 61 °C (DW50K4030FS / DW50K4030FW)				
	Drying				

Program	Description of cycle	Detergent (g) (Pre wash / Main wash)	Running time (min)	Energy (KWh)	Water (L)
Eco + Rinse Add	Pre Wash	5/22	212	0.93	10.5
	Main Wash 44 °C				
	Rinse				
	Hot Rinse 62 °C (DW50K4050BB / DW50K4030BB / DW50K4010BB)				
	Hot Rinse 61 °C (DW50K4030FS / DW50K4030FW)				
Normal	Drying	5/22	150	0.80	10.5
	Pre Wash				
	Main Wash 50 °C				
	Rinse				
	Hot Rinse 60 °C				
Normal + Sanitize	Drying	5/22	154	0.97	10.5
	Pre Wash				
	Main Wash 50 °C				
	Rinse				
	Hot Rinse 70 °C				
Normal + Half load	Drying	5/22	150	0.76	10.5
	Pre Wash				
	Main Wash 50 °C				
	Rinse				
	Hot Rinse 60 °C				
Normal + Rinse Add	Drying	5/22	167	0.95	13.0
	Pre Wash				
	Main Wash 50 °C				
	Rinse				
	Hot Rinse 60 °C				
Delicate (DW50K4050BB)	Drying	5/20	116	0.65	8.0
	Main Wash 40 °C				
	Rinse				
	Hot Rinse 55 °C				
	Drying				
Delicate + Sanitize (DW50K4050BB)	Main Wash 40 °C	5/20	122	0.85	8.0
	Rinse				
	Hot Rinse 70 °C				
	Drying				
	Main Wash 40 °C				
Delicate + Half load (DW50K4050BB)	Rinse	5/20	116	0.56	8.0
	Hot Rinse 55 °C				
	Drying				
	Main Wash 40 °C				
	Rinse				
Delicate + Rinse Add (DW50K4050BB)	Hot Rinse 55 °C	5/20	131	0.74	10.5
	Drying				
	Main Wash 40 °C				
	Rinse				
	Hot Rinse 55 °C				
Express	Drying	5/20	60	0.80	8.5
	Pre Wash 50 °C				
	Main Wash 50 °C				
	Hot Rinse 60 °C				
	Drying				

Starting a washing programme

Program	Description of cycle	Detergent (g) (Pre wash / Main wash)	Running time (min)	Energy (KWh)	Water (L)
Express + Sanitize	Pre Wash 50 °C	5/20	64	0.95	8.5
	Main Wash 50 °C				
	Hot Rinse 70 °C				
	Drying				
Express + Half load	Pre Wash 50 °C	5/20	60	0.78	8.5
	Main Wash 50 °C				
	Hot Rinse 60 °C				
	Drying				
Express + Rinse Add	Pre Wash 50 °C	5/20	73	0.97	10.5
	Main Wash 50 °C				
	Hot Rinse 60 °C				
	Drying				
Quick Wash (DW50K4050BB)	Main Wash 45 °C	20	40	0.53	5.5
	Hot Rinse 55 °C				
Quick Wash + Sanitize (DW50K4050BB)	Main Wash 45 °C	20	46	0.80	5.5
	Hot Rinse 70 °C				
Quick Wash + Half load (DW50K4050BB)	Main Wash 45 °C	20	40	0.53	5.5
	Hot Rinse 55 °C				
Quick Wash + Rinse Add (DW50K4050BB)	Main Wash 45 °C	20	53	0.73	8.0
	Hot Rinse 55 °C				
Pre Wash (DW50K4050BB/ DW50K4030BB)	Pre Wash	-	12	0.01	3.3

 * EN 50242: The information for comparability test in accordance with EN50242,as follows:

- Capacity: 9 settings
- Position of upper basket: Lower position
- Rinse aid setting: 5 (or 4 for four setting dispenser)

 The wash time varies depending on the pressure and temperature of the supplied water.

 Quick Wash, Express, Pre Wash: Continuous use of the Quick Wash, Express, Pre Wash cycles for an extended time is not recommended. This may reduce the performance of the water softener.

Turning on the appliance

Starting a wash cycle...

1. Draw out the lower and upper basket, load the dishes and push them back.
It is recommended to load the lower basket first, then the upper one (see the section entitled "Loading the dishwasher racks").
 2. Pour in the detergent (see the section entitled "Loading the Salt into the Softener").
 3. Insert the plug into the socket. The power supply is 220-240 V AC 50 Hz, the specification of the socket is 10 A 250 VAC. 50 Hz.
 4. Make sure that the water supply is turned on to full pressure. Close the door, press the "Power" button, Press the "Program" button to select a desired "Wash cycle". (See the section entitled "Wash Cycle Table"). With a little force to ensure the door is properly closed.
-  A click could be heard when the door is closed perfectly.
When the washing is over, you can shut off the switch by pressing "Power" button.

Change the programme

Premise:

1. A cycle that is underway can only be modified if it has only been running for a short time. Otherwise, the detergent may have already been released, and the appliance may have already drained the wash water. If this is the case, the detergent dispenser must be refilled (see the section entitled "Fill in the Detergent").
2. Press "Power" button or "reset" button 3 seconds to cancel the programme, and turn on it again, then you can change the programme to the desired cycle setting (see the section entitled "Starting a wash cycle...") or press programme button while you press "reset" button.

 If you open the door when washing, the machine pauses and warning alarm rings, the display appears E1. When you close the door, the machine will keep on working after 10 seconds.

These programme lights show the state of the dishwasher:

- a) One of the programme lights on --> cycle running
- b) One of the programme lights blinking --> pause

 If all the lights begin to glimmer, that indicates the machine is out of order, please turn off the main power and water supply before calling a service.

Forget to add dish

A forgotten dish can be added any time before the detergent cup opens

1. Open the door a little to stop the washing.
2. After the spray arms stop working, you can open the door completely.
3. Add forgotten dishes.
4. Close the door, the dishwasher will work after ten seconds.

 **WARNING:** It is dangerous to open the door when washing, because the hot water may scald you. Switch Off the Dishwasher. The digital display appears "---" and the buzzer rings 6 times, only in this case the programme has ended.

1. Switch off the dishwasher by pressing the "Power" button.
2. Turn off the water tap!

 **Open the door carefully. Hot steam may escape when the door is opened!**

- Hot dishes are sensitive to knocks. The dishes should therefore be allowed to cool down around 15 minutes before removing from the appliance.
- Open the dishwasher's door, leave it ajar and wait a few minutes before removing the dishes. In this way they will be cooler and the drying will be improved.

Unloading the dishwasher

It is normal that the dishwasher is wet inside.

Empty the lower basket first and then the upper one. This will avoid water dripping from the upper basket onto the dishes in the lower one.

Maintenance and cleaning

Filtering system

The filter is used to avoid the big remnants and other sundries getting inside the pump. The residue can obstruct the filter in sometime.

The filter system consists of a coarse filter, a flat (Main filter) and a micro filter (fine filter).

- 1. Fine filter:** Food and debris will be trapped by a special jet on the lower spray arm.
- 2. Coarse filter:** Big debris, such as bone and glass that could clog the drain will be trapped in the coarse filter.
To remove an item caught in this filter, gently squeeze the taps on the top of this filter and lift it out.
- 3. Micro filter:** This filter holds soil and food residue in the sump area and prevents it from being redeposit on the dishes during a cycle.
 - Inspect the filters for obstructions every time the dishwasher has been used.
 - By unscrewing the coarse filter, you can remove the filter system. Remove any food remnants and clean the filters under running water.

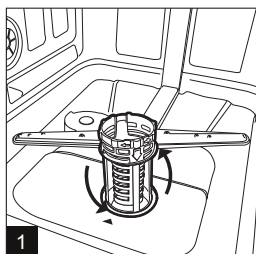
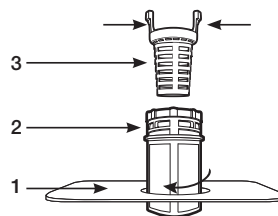

1

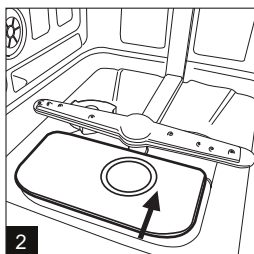

2

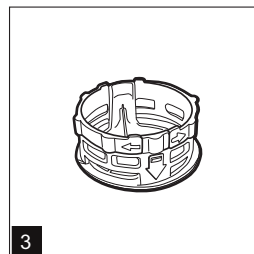

3

Step 1 contrarotate the Coarse filter, and then lift it up;

Step 2 lift the Flat filter up



If operate from step 1 to step 2, the filter system will be removed; while operate from step 2 to step 1, the filter system will be installed 3.

Filter assembly

For best performance and results, the filter assembly must be cleaned. The filter efficiently removes food particles from the wash water, allowing it to be recirculated during the cycle. For this reason, it is a good idea to remove the larger food particles trapped in the filter after each wash cycle by rinsing the semicircular filter and cup under running water. To remove the filter assembly, pull on the cup handle in the upward direction. The entire filter assembly should be cleaned once a week. To clean the coarse filter and the micro filter, use a cleaning brush. Then, reassemble the filter parts as shown in the figures above and reinsert the entire assembly in the dishwasher, positioning in its seat and pressing downward. The dishwasher must never be used without the filters. Improper replacement of the filter may reduce the performance level of the appliance and damage dishes and utensils.



WARNING: Never run the dishwasher without the filters in place. When cleaning the filters, don't knock on them. Otherwise, the filters could be contorted and the performance of dishwasher could be debased.

Cleaning the spray arms

It is necessary to clean the spray arms regularly for hard water chemicals will clog the spray arm jets and bearings. To remove the spray arms, screw off the nut clockwise to take out the washer on top of the spray arm and remove the arm. Wash the arms in soapy and warm water and use a soft brush to clean the jets. Replace them after rinsing thoroughly.

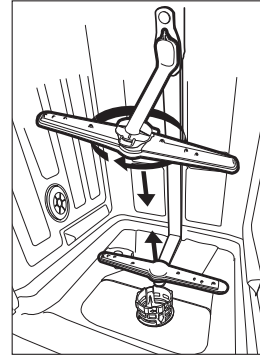

Caring for the dishwasher

To clean the control panel, use a lightly dampened cloth then dry thoroughly.

To clean the exterior, use a good appliance polish wax. Never use sharp objects, scouring pads or harsh cleaners on any part of the dishwasher.

Protect against freezing

If your dishwasher is left in an unheated place during the winter, ask a service technical to:

1. Cut off electrical power to the dishwasher.
2. Turn off the water supply and disconnect the water inlet pipe from the water valve.
3. Drain water from the inlet pipe and water valve. (Use a pan to catch the water)
4. Reconnect the water inlet pipe to the water valve.
5. Remove the filter in the tub and the bottom and use a sponge to use up water in sump.

Cleaning the door

To clean the edge around the door, you should use only a soft warm, damp rag. To prevent penetration of water into the door lock and electrical components, do not use a spray cleaner of any kind.

Also, never use abrasive cleaners or scouring pads on the outer surfaces because they will scratch the finish. Some papers towels can also scratch or leave marks on the surface.

⚠ WARNING: Never use a spray cleaner to clean the door panel for it could damage the door lock and electrical components. It is not allowed to use the abrasive agent or some paper towel because of the risk of scratching or leaving spots on the stainless steel surface.

Maintenance and cleaning

How to keep your dishwasher in shape

- **After Every Wash**
After every wash, turn off the water supply to the appliance and leave the door slightly ajar so that moisture and odors are not trapped inside.
- **Remove the Plug**
Before cleaning or performing maintenance, always remove the plug from the socket. Do not run risks.
- **No Solvents or Abrasive Cleaning**
To clean the exterior and rubber parts of the dishwasher, do not use solvents or abrasive cleaning products. Use only a cloth and warm soapy water. To remove spots or stains from the surface of the interior, use a cloth dampened with water and a little white vinegar, or a cleaning product made specifically for dishwashers.
- **When You Go on holiday**
When you go on holiday, it is recommended that you run a wash cycle with the dishwasher empty and then remove the plug from the socket, turn off the water supply and leave the door of the appliance slightly ajar. This will help the seals last longer and prevent odors from forming in the appliance.
- **Moving the Appliance**
If the appliance must be moved, try to keep it in the vertical position. If absolutely necessary, it can be positioned on its back.
- **Seals**
One of the factors that cause odors to form in the dishwasher is food that remains trapped in the seals. Periodic cleaning with a damp sponge will prevent this.

Installation instruction



WARNING : Electrical Shock Hazard!

Disconnect electrical power before installing dishwasher.
Failure to do so can result in death or electrical shock.



CAUTION: The installation of the pipes and electrical equipments should be done by professionals.



- Keep this instruction manual in a safe place for future reference. If the appliance is sold, given away or moved, please ensure the manual is kept with the machine, so that the new owner may benefit from the advice contained within it.
- Please read this instruction manual carefully: it contains important information regarding the safe installation, use and maintenance of the appliance.
- If the appliance must be moved at any time, keep it in an upright position; if absolutely necessary, it may be tilted onto its back.

Positioning and leveling

1. Remove the appliance from all packaging and check that it has not been damaged during transportation. If it has been damaged, contact the retailer and do not proceed and further with the installation process.
2. Check the dishwasher by placing it so that its sides or back panel are in contact with the adjacent cabinets or even with the wall. This appliance can also be recessed under a single worktop (see the Assembly instruction sheet).
3. Position the dishwasher on a level and sturdy floor. If the floor is uneven, the front feet of the appliance may be adjusted until it reaches a horizontal position (the angle of inclination must not exceed 2 degrees). If the appliance is levelled correctly, it will be more stable and much less likely to move or cause vibrations and noise while it is operation.

Connecting the water and electricity supplies



- Connection to the water and electricity supplies should only be performed by a qualified technician.
- The dishwasher should not stand on top of the water hoses or the electricity supply cable.
- The appliance must be connected to the water supply network using new piping. Do not use old piping.

Connecting the water inlet hose

Connect the cold water supply hose to a threaded 3/4(inch) connector and make sure that it is fastened tightly in place. If the water pipes are new or have not been used for an extended period of time, let the water run to make sure that the water is clear and free of impurities. If this precaution is not taken, there is a risk that the water inlet can get blocked and the appliance could be damaged.

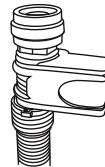

Installation instruction

Connecting the water outlet hose

Fit the drainage hose of your machine to the drainage pipe without bending.

If the length of the hose is not sufficient, apply to the authorized service for an extension made from the same material as the original. Remember that the length of the hose should not exceed 4 meters even when with an extension.

If the drainage hose is longer than 4 m, the dishes will not be cleaned properly. Secure your hose firmly to the drainage pipe to avoid it coming off during the washing process.

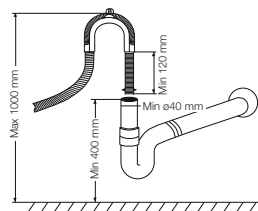

Electrical connection

Before inserting the plug into the electrical socket, make sure that:

- the socket is earthed and complies with current regulations;
- the socket can withstand the maximum load of the appliance, which is indicated on the data plate located on the inside of the door (see description of the appliance);
- the power supply voltage falls within the values indicated on the data plate on the inside of the door;
- the socket is compatible with the plug of the appliance. If this is not the case, ask an authorised technician to replace the plug (see assistance); do not use extension cables or multiple sockets.



- Once the appliance has been installed, the power supply cable and the electrical socket should be easily accessible.
- The cable should not be bent or compressed.
- If the power supply cable is damaged, it must be replaced by the manufacturer or its Technical Assistance Service in order to prevent all potential hazards. (See Assistance)
- The company shall not be held responsible for any incidents that occur if these regulations are not observed.

Advice regarding the first wash cycle

After the appliance has been installed, immediately before running the first wash cycle, completely fill the salt dispenser with and add approximately 1.2 Kg of salt (see Rinse aid and refined salt). The water may overflow: this is normal and is not a cause for concern. It is also normal that the LOW SALT indicator light continues to flash for a few cycles after the salt has been loaded.

Positioning the appliance

Position the appliance in the desired location. The back should rest against the wall behind it, and the sides, along the adjacent cabinets or wall. The dishwasher is equipped with water supply and drain hoses that can be positioned to the right or the left to facilitate proper installation.

Leveling the appliance

Once the appliance is positioned, adjust the feet (screwing them in or out) to adjust the height of the dishwasher, making it level. In any case, the appliance should not be inclined more than 2°.



The maximum adjustment height of the feet is 20 mm.

How to drain excess water from hoses

If the sink is 1000mm higher from the floor, the excess water in hoses cannot be drained directly into the sink. It will be necessary to drain excess water from hoses into a bowl or a suitable container that is held outside and lower than the sink.

Water outlet

Connect the water drain hose. The drain hose must be correctly fitted to avoid water leaks. Ensure that the water inlet hose is not kinked or squashed.

Extension hose

If you need a drain hose extension, observe to use a similar drain hose. It must be no longer than 4 metres; otherwise the cleaning effect of the dishwasher could be reduced.

Syphon connection

The waste connection must be at a height of between 50cm (minimum) and 100cm (maximum) from the bottom of the dish. The water drain hose should be fixed by a hose clip.

Installation instruction

Built-in dishwasher



WARNING : Electrical Shock Hazard!

Disconnect electrical power before installing dishwasher.

Failure to do so can result in death or electrical shock.



CAUTION: Water pipe and electric device should be installed by professionals

Step 1. Before installation

- Dishwasher place requirement. The back of dishwasher should face to the wall, and the dishwasher has inlet and outlet pipe, which can be connected on the right or left side conveniently.
- To protect the cabinet from steam, attach the protective film under the cabinet as shown.

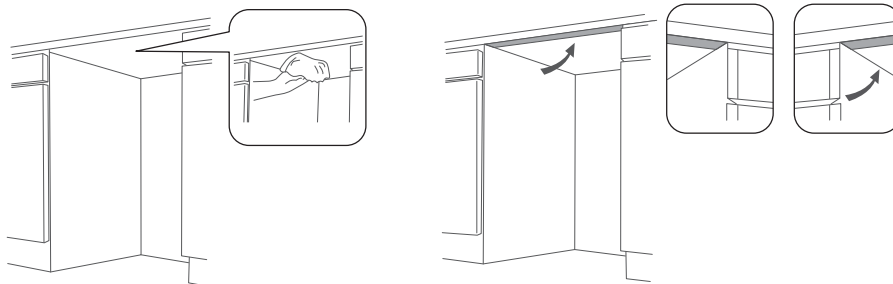

- The dimensions of installation Cabinet.

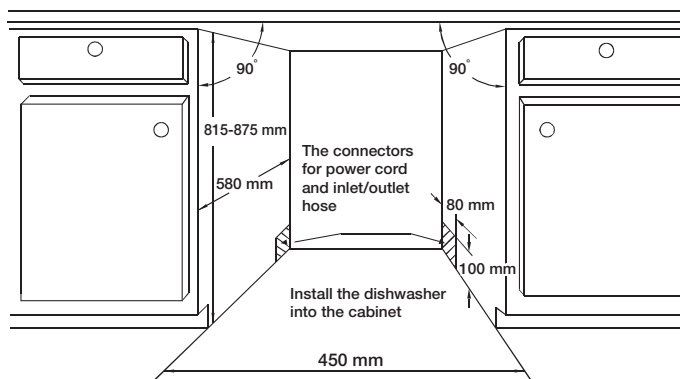

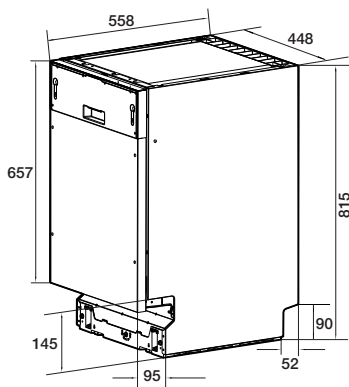

Step 2. The dimension of the front ornamental plate

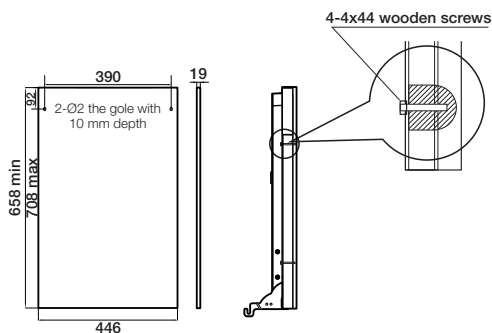

Step 3. Fix the ornamental plate

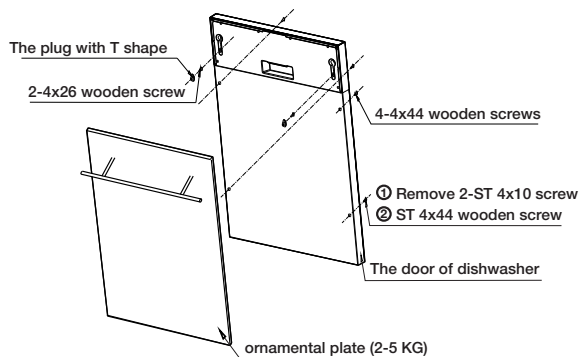

Installation instruction

Step 4. Tension adjustment of the door spring

After placed the panel on the dishwasher, please try open and close the door to test the balance to check out whether the door can remain a same place. If not, please adjusting the screw in the direction of clockwise or counter-clockwise to adjust the balance of the door. Or it has been adjusted.

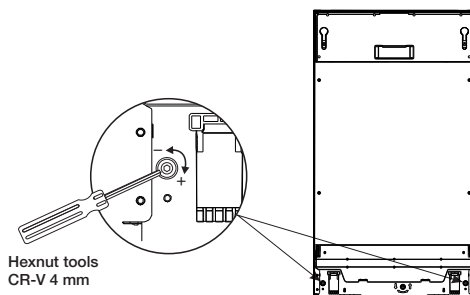

Step 5. Connecting the water inlet hose (for cold water)

After placed the panel on the dishwasher, please try open and close the door to test the balance to check out whether the door can remain a same place. If not, please adjusting the screw in the direction of clockwise or counter-clockwise to adjust the balance of the door. Or it has been adjusted.

Connection the cold water supply hose to a threaded 3/4(inch) connector and make sure that it is fastened tightly in place.

If the water hoses are new or have not been used for an extended period of time, let the water run to make sure that the water is clear and free of impurities. If this precaution is not taken, there is a risk that the water inlet can get blocked and the appliance could be damaged.

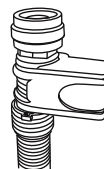

Step 5-1. Electrical connection

Make sure the socket is compatible with the plug of the appliance, The socket must have earthing wire, and can hold 250 V / 10 A, otherwise damage or accident may occur, Other electric appliance with big power can not use the same socket with the dishwasher.

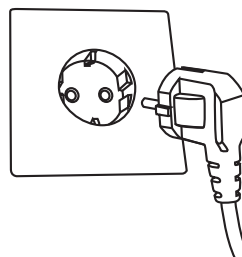

Step 6. Connecting the water outlet hose

Put the hose into drainage hose which diameter is more than 40 mm or into the sink, both should make sure the outlet pipe is straight, and the height of the end of pipe should be less than 1000 mm.

 **Note:** The connector of the outlet pipe should be tight.

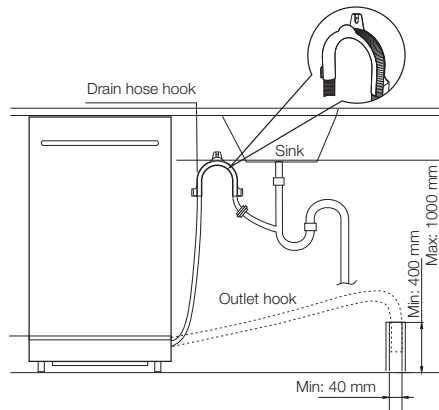

Step 7. Level adjustment

Allowable slope under entire dishwasher is 2 degree. Adjust the height by turning the feet to make sure the dishwasher is level.

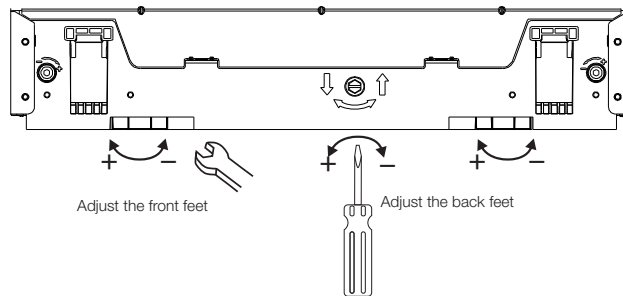

Installation instruction

Step 8. Installation of skirting board

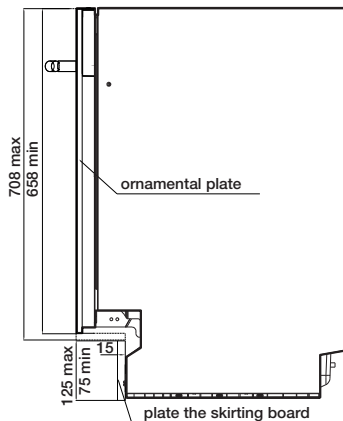

Serial number	Referenced dimension(Fully built in)	
	ornamental plate	Plate to ornament the skirting board
1	708 mm	75 mm
2	698 mm	85 mm
3	688 mm	95 mm
4	678 mm	105 mm
5	668 mm	115 mm
6	658 mm	125 mm



Note: The required height of the skirting board is as per the principle of aesthetic and opening closing the door smoothly, Please check the suggested chart for the reference.

Step 9. Fixation of dishwasher

1. Fixing the dishwasher with the cabinet by turning the screws.
2. Plug the four hole plugs into the holes in the sketch map.

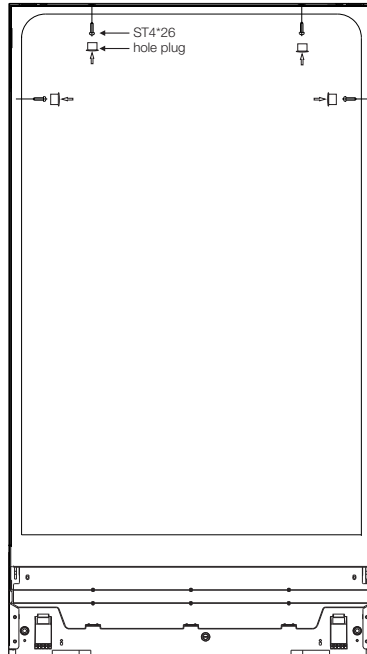

Dishwasher liner right and left side and the top 4 holes, use wood screws ST4*26 dishwasher fixed on the cabinet. (self-tapping screws were matching)

Start of dishwasher

1. The followings should be checked before starting the dishwasher:
2. Whether the dishwasher is level and fixed
3. Whether the inlet valve is opened
4. Whether there is leakage at the connections of the conducts
5. Whether the wires are tightly connected
6. Whether the power is switched on
7. Whether the inlet and drain hoses are knotted
8. All packing materials and printings should be taken out from the dishwasher

⚠ CAUTION: After installation, please put this manual into the bags of printings. The content of this manual is very helpful to the user

Troubleshooting tips

Error codes

When some malfunctions happen, the appliance will display error codes to warn you.

Codes	Meanings	Possible Causes
dC	Door open	The door is opened when the dishwasher is operating
4C	Water inlet	Water inlet malfunction
5C	Water drainage	Water drainage malfunction
tC	Temperature sensor	Temperature sensor malfunction
oC	Overflow/leakage	Overflow occurs/Water leakage occurs
LC	Water leakage	Water leakage occurs
HC	Heating element	Abnormal heating
PC	Water diversion system	Water diversion system malfunction

 **WARNING:** If overflow occurs, turn off the main water supply before calling a service. If there is water in the base pan because of an overfill or small leak, the water should be removed before restarting the dishwasher.

Before calling for service

Reviewing the charts on the following pages may make you be free of calling for service.

Problem	Possible Causes	What To Do
Dishwasher doesn't run	• Fuse blown or the circuit breaker acted.	• Replace fuse or reset circuit breaker. Remove any other appliances sharing the same circuit with the dishwasher.
	• Power supply is not turned on.	• Make sure the dishwasher is turned on and the door is closed securely. Make sure the power cord is properly plugged into the wall socket.
	• Water pressure is low.	• Check that the water supply is connected properly and the water is turned on.
Drain pump doesn't stop	• Overflow.	• The system is designed to detect an overflow. When it does, it shuts off the circulation pump and turns on the drain pump.
Noise	• Some audible sounds are normal.	• Sound from soft food shredding action and detergent cup opening.
	• Utensils are not secure in the baskets or something small has dropped into the basket.	• To ensure everything is secured in the dishwasher.
	• Motor hums.	• Dishwasher has not been used regularly. If you do not use it often, remember to set it to fill and pump out every week, which will help keep the seal moist.
Suds in the tub	• Improper detergent.	• Use only the special dishwasher detergent to avoid suds. • If this occurs, open the dishwasher and let suds evaporate. • Add 1 gallon of cold water to the tub. Close and latch the dishwasher, then start the "soak" wash cycle to drain out the water. Repeat if necessary.
	• Spilled rinse agent.	• Always wipe up rinse agent spills immediately.
Stained tub interior	• Detergent with colorant was used.	• Make sure that the detergent is the one without colorant.
Dishes and flatware not clean	• Improper program.	• Select a more intensive wash program.
	• Improper rack loading.	• Make sure that the action of the detergent dispenser and spray arms are not blocked by large dishware.

Troubleshooting tips

Problem	Possible Causes	What To Do
Spots and filming on glasses and flatware	<ol style="list-style-type: none"> 1. Extremely hard water. 2. Low inlet temperature. 3. Overloading the dishwasher. 4. Improper loading. 5. Old or damp powder detergent. 6. Empty rinse agent dispenser. 7. Incorrect dosage of detergent. 	<p>To remove spots from glassware:</p> <ol style="list-style-type: none"> 1. Take out all metal utensils out of the dishwasher. 2. Do not add detergent. 3. Choose the longest cycle. 4. Start the dishwasher and allow it to run for about 18 to 22 minutes, then it will be in the main wash. 5. Open the door to pour 2 cups of white vinegar into the bottom of the dishwasher. 6. Close the door and let the dishwasher complete the cycle. If the vinegar does not work: Repeat as above, except use 1/4 cup (60 ml) of citric acid crystals instead of vinegar.
Cloudiness on glassware	<ul style="list-style-type: none"> • Combination of soft water and too much detergent. 	<ul style="list-style-type: none"> • Use less detergent if you have soft water and select a shortest cycle to wash the glassware and to get them clean.
Yellow or brown film on inside surfaces	<ul style="list-style-type: none"> • Tea or coffee stains. 	<ul style="list-style-type: none"> • Using a solution of 1/2 cup of bleach and 3 cups warm water to remove the stains by hand. <p> WARNING: You have to wait for 20 minutes after a cycle to let the heating elements cool down before cleaning interior; Failing to follow this instruct may result in the risk of burns.</p>
	<ul style="list-style-type: none"> • Iron deposits in water can cause an overall film. 	<ul style="list-style-type: none"> • You have to call a water softener company for a special filter.
White film on inside surface	<ul style="list-style-type: none"> • Hard water minerals. 	<ul style="list-style-type: none"> • To clean the interior, use a damp sponge with dishwasher detergent and wear rubber gloves. Never use any other cleaner than dishwasher detergent for the risk of foaming or suds.
The Detergent dispenser lid cannot be closed prop-erly	<ul style="list-style-type: none"> • Clogged detergent re-sidue is blocking the catch 	<ul style="list-style-type: none"> • Clean the detergent from the catch.
Detergent left in dispenser cups	<ul style="list-style-type: none"> • Dishes block detergent cups. 	<ul style="list-style-type: none"> • Re-loading the dishes properly.
Steam	<ul style="list-style-type: none"> • Normal phenomenon. 	<ul style="list-style-type: none"> • There is some steam coming through the vent by the door latch during drying and water draining.
Black or gray marks on dishes	<ul style="list-style-type: none"> • Aluminum utensils have rubbed against dishes. 	<ul style="list-style-type: none"> • Use a mild abrasive cleaner to eliminate those marks.
Water standing in the bottom of the tub	<ul style="list-style-type: none"> • This is normal. 	<ul style="list-style-type: none"> • A small amount of clean water around the outlet on the tub bottom keeps the water seal lubricated.
Dishwasher leaks	<ul style="list-style-type: none"> • Overfill dispenser or rinse aid spills. 	<ul style="list-style-type: none"> • Be careful not to overfill the rinse aid dispenser. Spilled rinse aid could cause overusing and lead to overflowing. Wipe away any spills with a damp cloth.
	<ul style="list-style-type: none"> • Dishwasher isn't level. 	<ul style="list-style-type: none"> • Make sure the dishwasher is level.

Appendix

Specifications

Model	DW50K4050BB DW50K4030BB DW50K4010BB	DW50K4030FS DW50K4030FW
Type	Built-in Dishwasher	Freestanding Dishwasher
Power	220-240 V / 50 Hz AC only	220-240 V / 50 Hz AC only
Water pressure	0.04-1.0 Mpa	0.04-1.0 Mpa
Rated power usage	1750-2000 W	1750-2000 W
Hot water connection	Max 60 °C	Max 60 °C
Dry type	Condensed dry system	Condensed dry system
Wash type	Rotating nozzle spray	Rotating nozzle spray
Dimensions (mm) (Width x Depth x Height)	448 x 558 x 815	448 x 600 x 845
Wash capacity	9 place setting	9 place setting
Weight (Unpacked)	31 Kg	37 Kg
Weight (Packed)	36 Kg	41 Kg

Product dimension

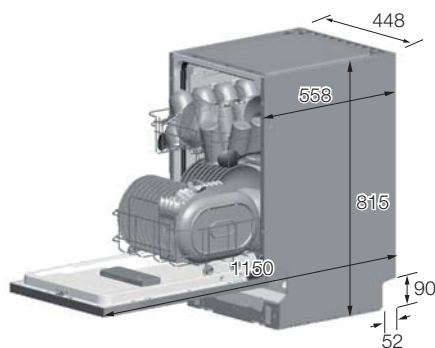

DW50K4050BB / DW50K4030BB/
DW50K4010BB

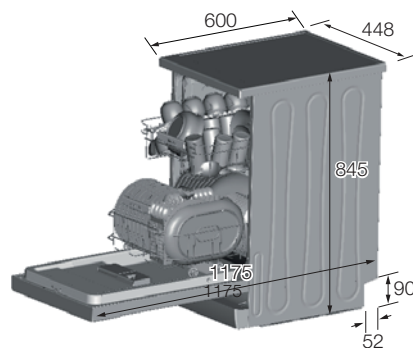

DW50K4030F

Product fiche

REGULATION (EU) No 1059/2010

Supplier	SAMSUNG	SAMSUNG	SAMSUNG	SAMSUNG
Model name	DW50K4050BB	DW50K4030BB	DW50K4010BB	DW50K4030FS DW50K4030FW
Rated Capacity (place setting)	9	9	9	9
Energy efficiency class	A+	A+	A+	A+
Annual energy consumption, (AE c) (kWh/year) ¹⁾	222	222	222	222
Standard cycle energy consumption, (E t) (kWh)	0.78	0.78	0.78	0.78
Power consumption in off mode, P o (W)	0.49	0.49	0.49	0.49
Power consumption in left-on mode, P l (W)	0.9	0.9	0.9	0.9
Annual water consumption, (AW c) (L/year) ²⁾	2800	2800	2800	2800
Drying efficiency class, A (most efficient) to G (least efficient)	A	A	A	A
Standard programme ³⁾	Eco	Eco	Eco	Eco
Programme time for the standard cycle, (min)	195	195	195	195
Duration of the left-on mode, (T l) (min)	Unlimited	Unlimited	Unlimited	Unlimited
Airborne acoustical noise emissions (dB(A re 1pW))	47	50	52	48
Installation	Built-in	Yes	Yes	Yes
	Built-under	-	-	-
	Free standing	-	-	-



- 1) based on 280 standard cleaning cycles using cold water fill and the consumption of the low power modes. Actual energy consumption will depend on how the appliance is used.
- 2) based on 280 standard cleaning cycles. Actual water consumption will depend on how the appliance is used.
- 3) 'Standard programme' is the standard cleaning cycle which is suitable to clean normally soiled tableware, and that it is the most efficient programme in terms of combined energy and water consumption.
- 4) The wash time varies depending on the pressure and temperature of the supplied water.

Terminology for dishwasher

1. Circulation Motor	A motor that sucks the water remaining on the floor of the dishwasher and injects water using high pressure through the internal water passages to the top Middle and lower nozzles.
2. Drain Pump	The pump that drains the polluted water from the dishwasher generated while the dishwasher is running.
3. Heater	The heater is located on the water passages inside the dishwasher. It heats the flowing water to increase wash efficiency.
4. Flow Meter	Measure the amount of supplied water by counting the pulses of the hall IC located at the next of the inlet valve.
5. Distributor	Located at the output end of the sump inside the dishwasher. It turns the flow of the water that goes to the bottom part of the dishwasher on or off. (This model does not have this part)
6. Dispenser	The location where the detergent and rinse aids are stored so they can be used by the dishwasher. The dispenser automatically supplies detergent and rinse aids to the inside of the dishwasher when they are needed.
7. Tub Assy	An internal case made of stainless steel that makes up the basic framework of the dishwasher.
8. Sump Assy	The place inside the dishwasher where water is collected. The injected water gathers here after circulation. The sump Assy is connected to the circulation motor and drain pump.
9. Tub Front Assy	An internal case made of stainless steel that makes up internal part of the front door.
10. Base Assy	A plastic part that makes up the basic bottom framework.
11. Basket Assy	The upper and lower racks where dishes can be loaded.
12. Middle/Lower Nozzles	Washes dishes by rotating and injecting the supplied water through the water passage at high pressure.
13. Case Brake	A passage that adjusts the air pressure by connecting the pressure of the inside air which is expanded at high temperature during wash and rinse cycles and the outside air pressure.
14. Door Lock Switch	Detects whether the door of the dishwasher is open or closed if the door is open while the dishwasher is running the cycle is temporary stopped.

Note

Note

SAMSUNG

QUESTIONS OR COMMENTS

COUNTRY	CALL	OR VISIT US ONLINE AT
UK	0330 SAMSUNG (7267864)	www.samsung.com/uk/support

Code No.: DD81-01867C-00